

Welcome to

Wharf Park

Public meeting #3!

Welcome back!

After two public meetings, Metro Parks is wrapping up the Master Plan for Wharf Park - a new park on a 25-acre riverfront site at the foot of the Silliman Evans (I-40) Bridge, adjacent to Rolling Mill Hill and Napier Sudekum.

Today we're back to unveil the final design vision based on your feedback, and we'd like to hear your thoughts on the future park!



MASTER PLAN

“Create a community park that invites people to embrace the Cumberland River, that responds to the land’s natural character, and that provides a range of recreational experiences that serve the surrounding neighborhoods and all Nashvillians.”

Wharf Park Master Plan Vision



MASTER PLAN BIRDSEYE

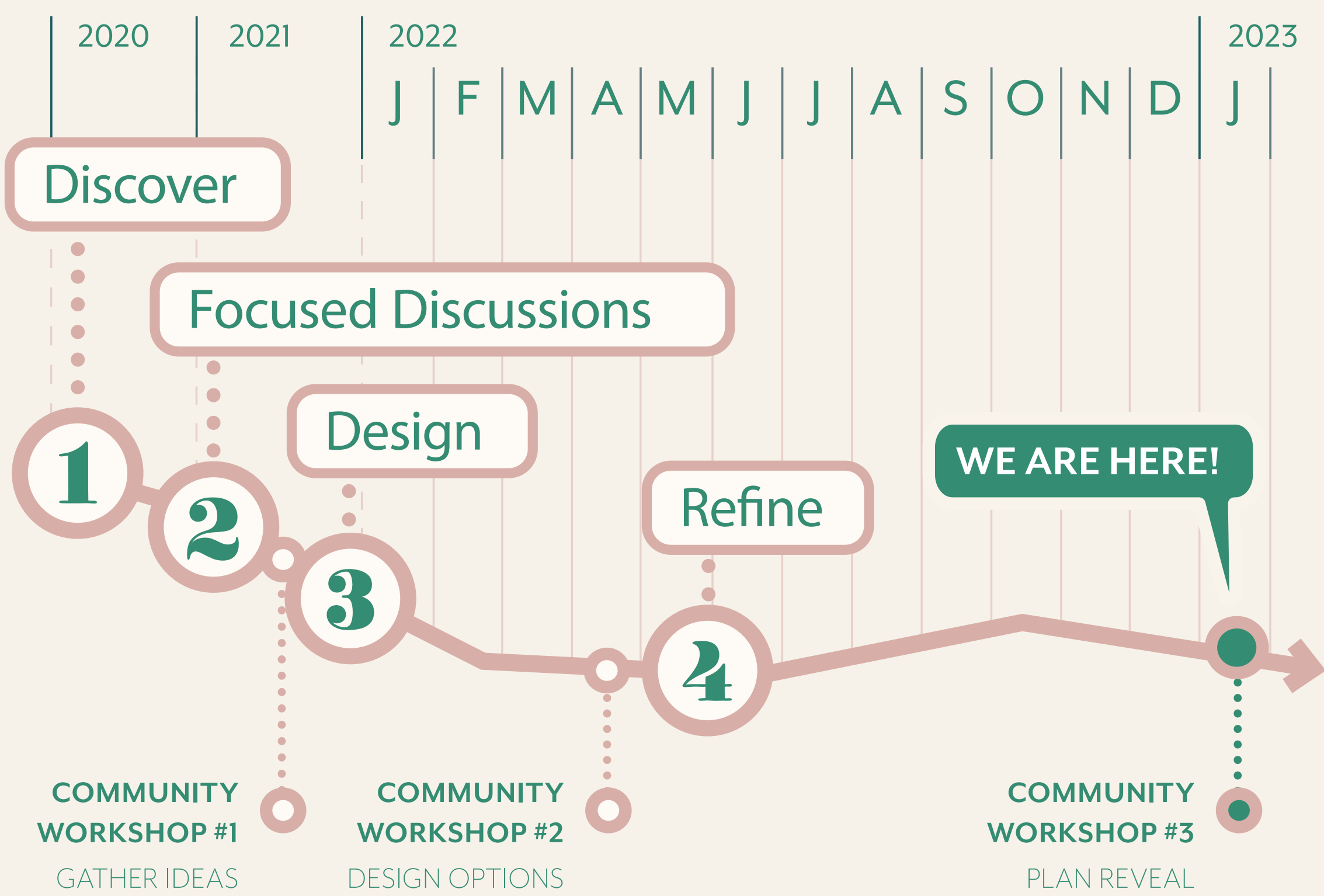

Project Journey

Since the beginning of the project in 2020, over 700 members of the Nashville community have weighed in on the design of the future riverfront neighborhood park! Programs like river access, nature access, nature education and active recreation rose to the top.

What we've heard from you!

PROGRAM PRIORITIES
 PUBLIC MEETING #1 - AUGUST 2021

#1 Nature Experiences

NATURE ACCESS
 NATURE EDUCATION
 BIRD WATCHING

#1 Access to the river

ROWING
 KAYAKING
 ROWING CENTER

36%
 of participants preferred to travel to Wharf Park by bike



Where is Wharf Park?

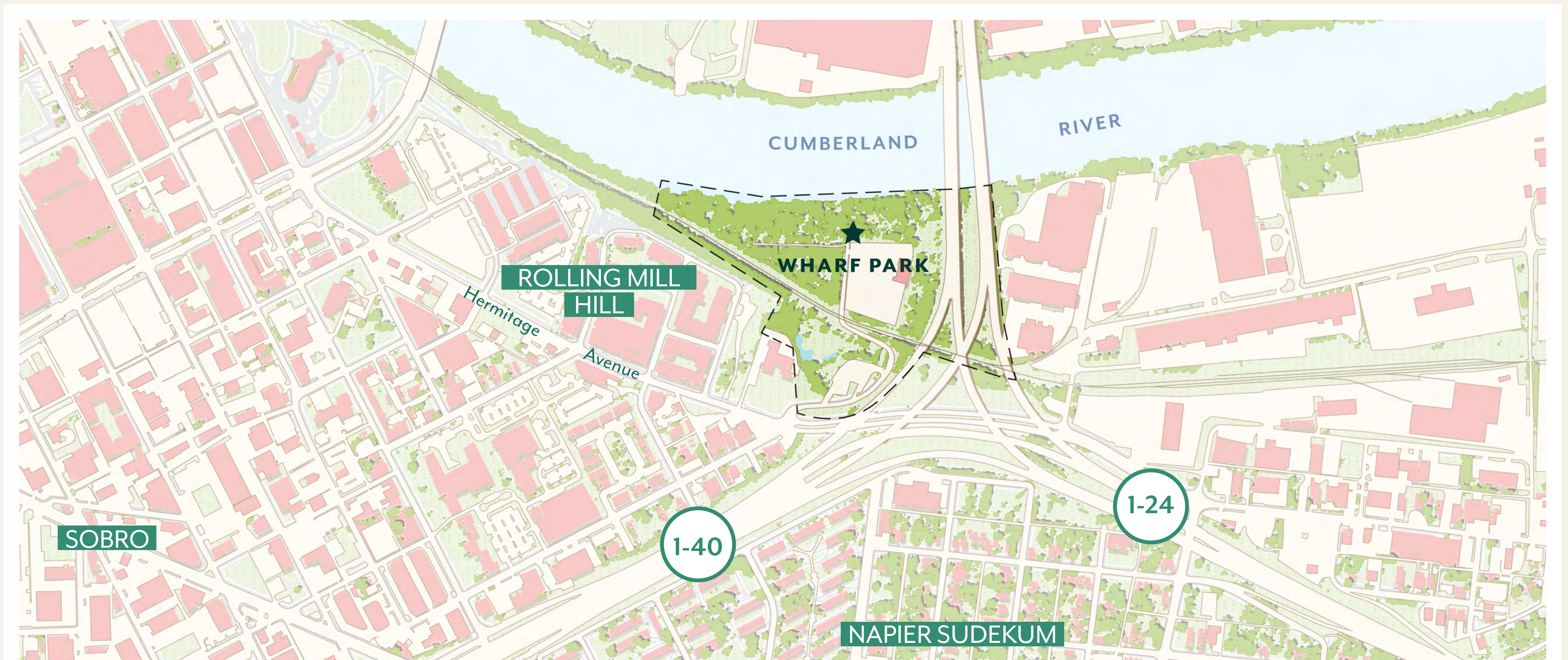

Use + Activities

Wharf Park will offer a range of passive and active park uses. Areas like the Quarry will be an active play and picnic space that celebrates the unique bluff wall with a series of water elements and spaces for all ages to gather.

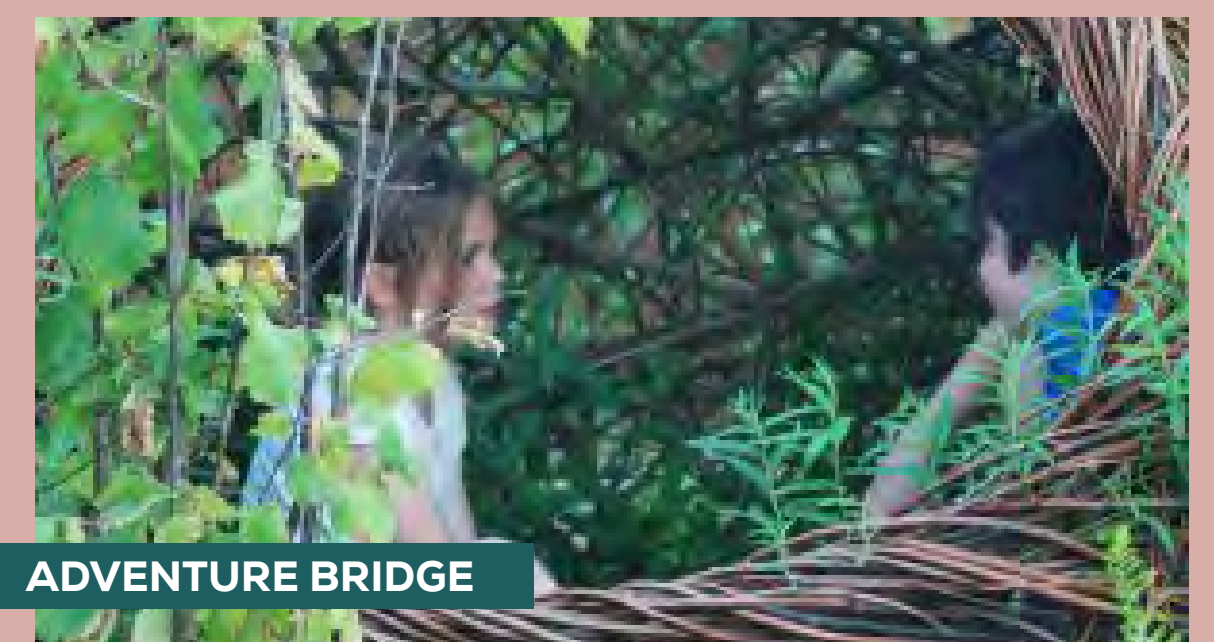

Program Metrics

| PROGRAM | WHARF PARK METRICS | AMENITIES INCLUDED |
|---------------------------|--------------------|---|
| Active Recreation | 53% | 3 play areas, skate park and tot skate lot, 3 basketball courts, 4 pickleball courts, 2 tennis courts, 2 sand volleyball courts, adventure bridge, dog park, overlook beach, kayak launch, rower's launch and outdoor fitness |
| Passive Recreation | 47% | 4 miles of trails and paths including 2 miles of greenway trail and a quarter mile forest trail loop |
| Play Areas | 1 acre | Play lawn, tot lot (ages 0-5), quarry nature play (ages 5-12) |
| Community Gathering Areas | 2 acres | Quarry overlook, river overlook, boathouse lawn and terrace |
| Water Access | 600 feet | Includes 360' kayak launch and 260' rowing launch docks |
| Skate Park | 48,000 SF | Includes street skate and pump track elements for toddlers as well as more experienced skaters |

Activity Zones

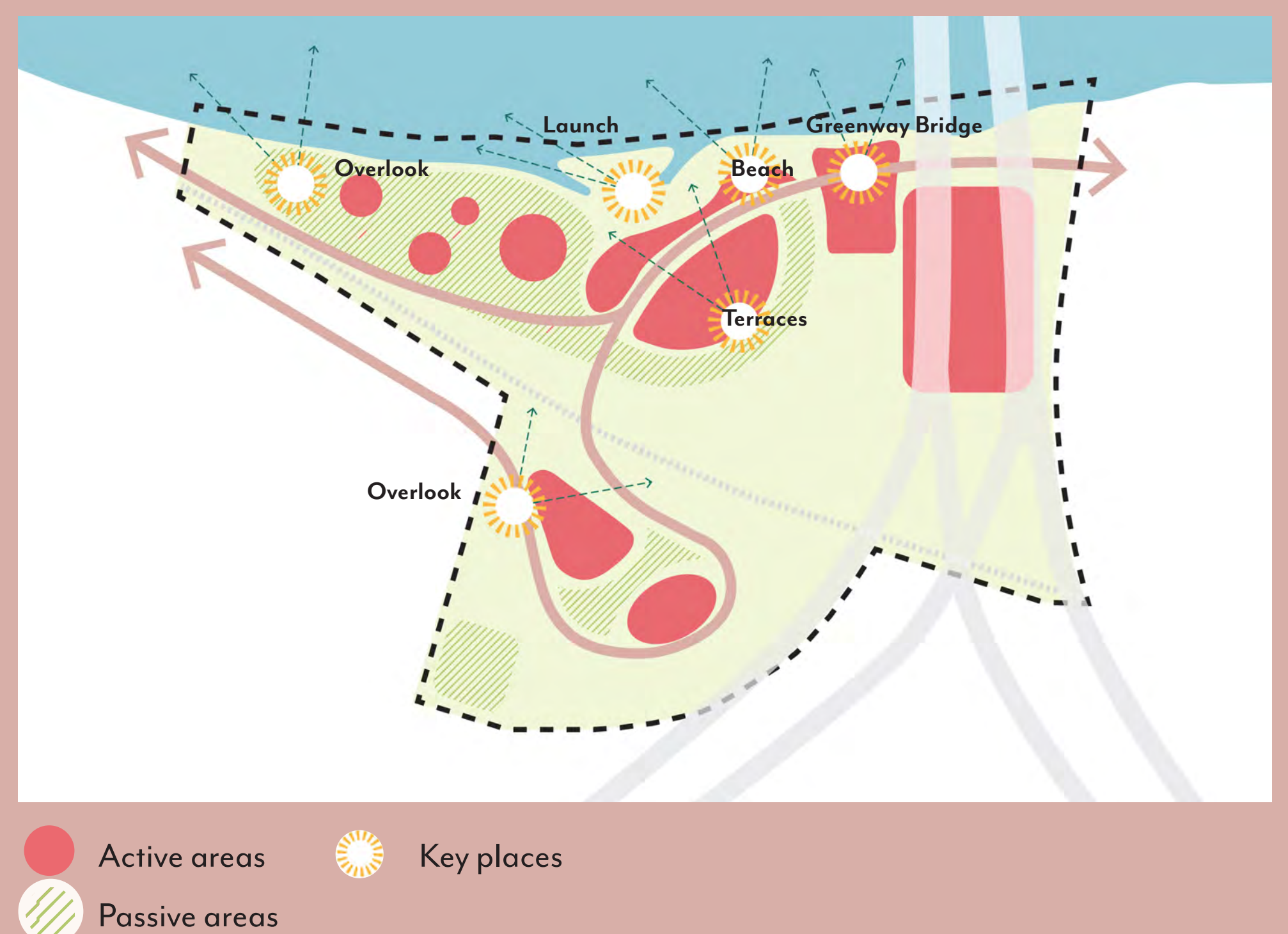

Nature + Water Access

Early community feedback indicated that nature and water access were two of the most important park uses. Wharf Park will provide several opportunities for users to experience and access the Cumberland River, from safely wading in with a kayak to launching from the Rowing Dock.



THE KAYAK LAUNCH



OPTIONAL BRIDGE

Netherlands



TOT SKATE SPOT

Somerville, MA



RIVER OVERLOOK

Vancouver, BC

Circulation



4mi

of trails, including a quarter mile forest trail loop

Vegetation



6 acres

of existing restored existing forest and over 10 acres of new planting



Implementation

Given the scale and complexity of construction, Wharf Park will be realized in a series of phased projects. Importantly, the Greenway, the Entry Road and a reasonable amount of parking will be part any first phase. All phases will require early unhoused population relocation. No development will be undertaken until existing residents are relocated.



Recommended Phase One
 Approx. 14 acres
 Design time: 12-18 months

\$70M Total Master Plan Cost

\$45M Phase One Cost

\$21M Cost of Phase One, Park Only

\$24M Cost of Boat House and Rowing Facilities

Phasing

The master planning team contemplated a series of first phases and outline strengths and challenges for each.

| | NATURE ACCESS | ACTIVE RECREATION | COMMUNITY GATHERING | WATER ACCESS |
|--|---------------|-------------------|---------------------|--------------|
| HEART (Recommended first phase!) | | ✓ | ✓ | ✓ |
| FOREST | ✓ | | | |
| QUARRY | | ✓ | ✓ | |
| UNDER BRIDGE | | ✓ | ✓ | |

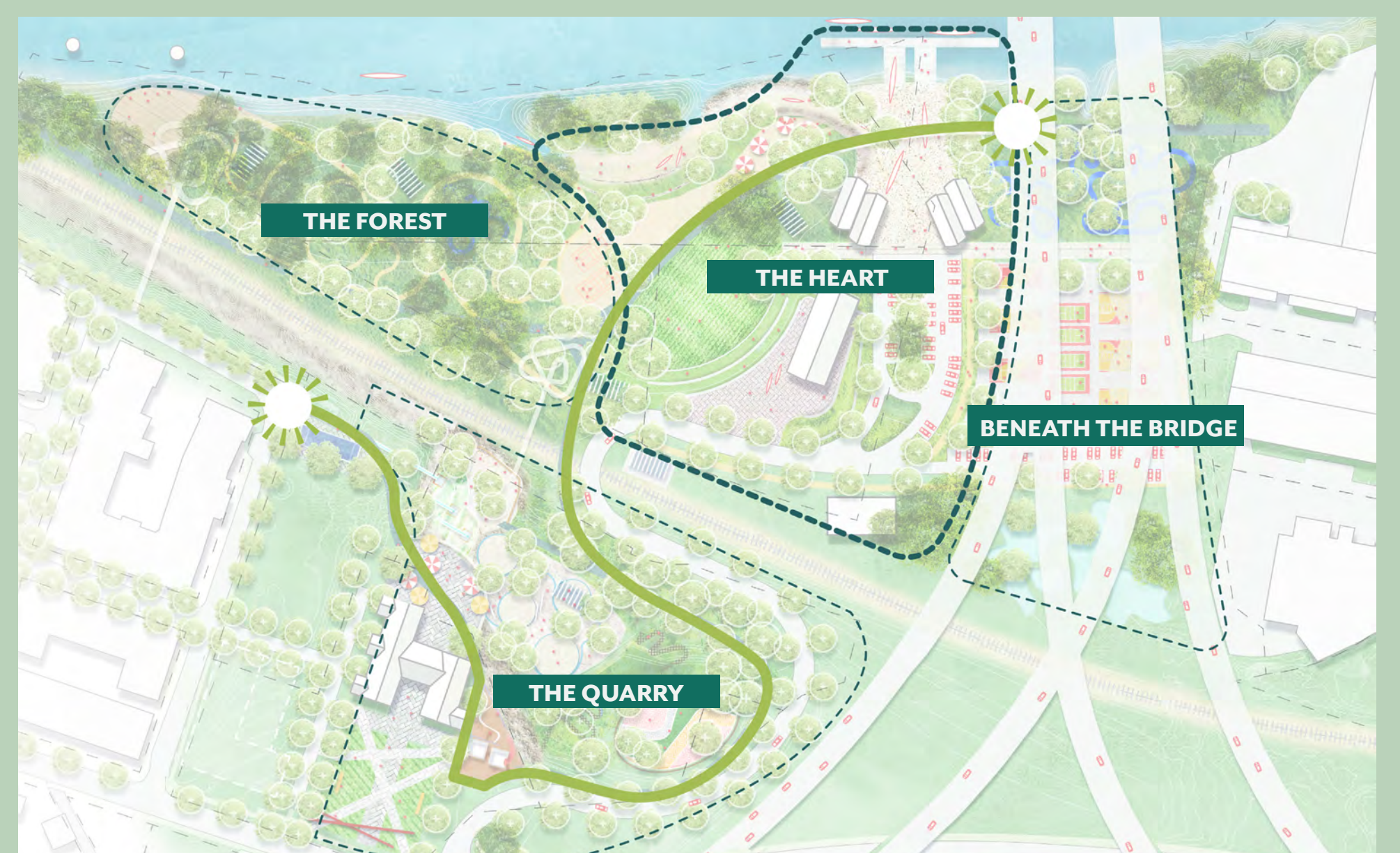

Greenway

Several mobility systems connect at Wharf Park, making it accessible via various modes of transportation.

The existing Rolling Mill Hill Greenway will extend through the park, and connect to the larger Nashville greenway network via Brown's Creek and a potential downtown connection along the river.



Nashville Mobility Connections

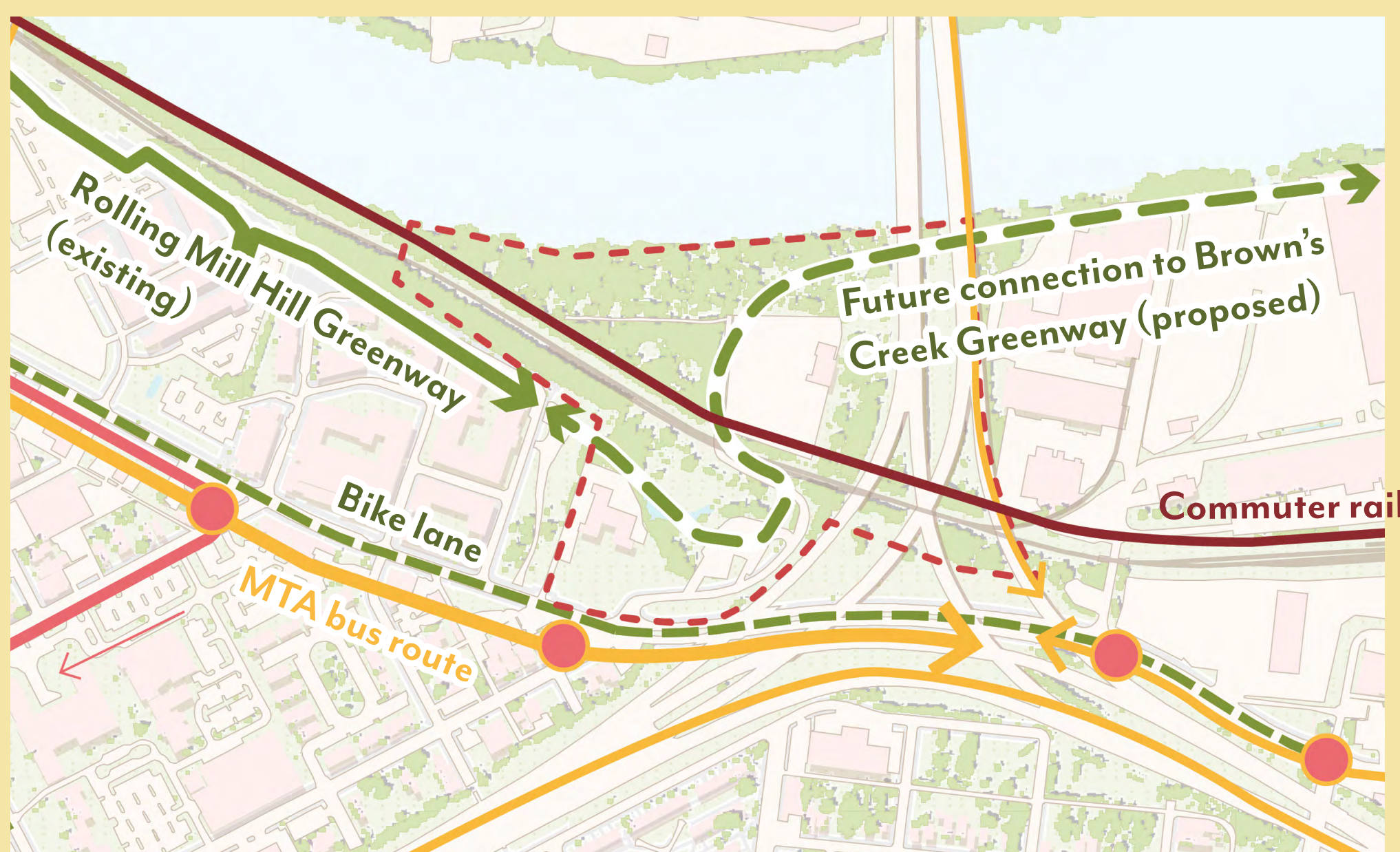

Park Systems

