

EXCAVATION PERMIT APPLICATION

NASHVILLE DEPARTMENT of TRANSPORTATION
& MULTIMODAL INFRASTRUCTURE

720 South Fifth Street
Nashville, TN 37206
Phone #: 862-8782
Fax #: 880-3259

TODAY'S DATE: 07-21-2023

pwpermits@nashville.gov

CONTRACTOR: Reeves Young, LLC

CONTACT: Drew Bergstresser

CONTRACTOR ADDRESS: 4101 Charlotte Ave, Suite E205, Nashville, TN 37209

PHONE #: (609) 774-2003 FAX #: ()

AFTER HOURS/EMERGENCY PHONE #:

EMAIL ADDRESS: dbergstresser@reevesyoung.com

PROPERTY ADDRESS FOR EXCAVATION(required): Church Street

CROSS STREET: 2nd Avenue

EXCAVATION SIZE: LENGTH: ft. BY WIDTH: ft.

START DATE: 07-25-2023 COMPLETION DATE: 07-31-2023

PURPOSE OF EXCAVATION: Drainage structure and pipe investigation

Storm/Sanitary Sewer Water Boring Will you be cutting in the roadway / asphalt?
Micro-trenching Electrical Other If so, size of cut (Length) (Width)

Metal Plates used: YES NO

REQUESTING RIGHT-OF-WAY/LANE CLOSURE PERMIT: YES NO

REQUESTING SIDEWALK CLOSURE PERMIT: YES NO

NUMBER OF DAYS NEEDED: 5 days START DATE: 07-25-2023

WORK WEEKENDS: YES NO Saturday Sunday

 Drew Bergstresser
SIGNATURE PRINT NAME

****Note: By signing you agree that you have read and understood the attached Chapter 13.20.020 notice attached.**

OFFICE USE ONLY:

RECEIVED BY: PERMIT #:

PAVEMENT ASSESSMENT: LANE CLOSURE #:

PAYMENT TYPE:



METROPOLITAN GOVERNMENT OF NASHVILLE AND DAVIDSON COUNTY

JOHN COOPER
MAYOR

NASHVILLE DEPARTMENT OF TRANSPORTATION
AND MULTIMODAL INFRASTRUCTURE

Chapter 13.20.020 Excavations and Obstruction Permissions and Notice Required

According to the referenced Code on Excavations and Obstructions in Metro Right of Way: “no excavation may be undertaken in any street, road, alley or right of way or of any utility or temporary construction easement of the Metropolitan Government or other government entity by any department of the metropolitan government or any other entity unless notice as required herein has been given”.

All contractors performing excavations in Metro right of way are required to provide 1 to 2 weeks of advance notice to the homeowners, residents, and businesses along the streets where the work is being performed. Your company must provide some form of documentation or proof that you have given adequate advance notice of your project. *Failure to do so could result in a triple fee fine to your permit.*

Attached is an example of what the door hangers or mailers should look like.

Please contact PWPermits@Nashville.gov or 615-862-8782 if you have any questions.

NDOT

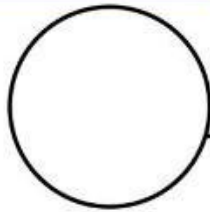

**Mayor
John Cooper**

*NASHVILLE DEPARTMENT OF TRANSPORTATION
& MULTIMODAL INFRASTRUCTURE*

Please be informed that a project for Utility Work will begin in approximately 1-2 weeks depending on weather conditions.

FOR ADDITIONAL INFORMATION CONTACT

Contractor _____

Contact Person _____

Phone # _____

Type of Work _____

NDOT (Formerly Public Works)

Phone #
615-862-8782

We appreciate your cooperation.

 To Request this information in an alternate format or ADA accommodations, please contact

Rick Kirkpatrick
615-862-8750

PROJECT NOTIFICATION

NDOT

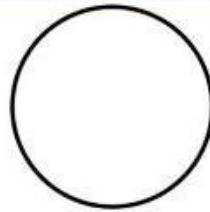

**Mayor
John Cooper**

*NASHVILLE DEPARTMENT OF TRANSPORTATION
& MULTIMODAL INFRASTRUCTURE*

Please be informed that a project for Utility Work will begin in approximately 1-2 weeks depending on weather conditions.

FOR ADDITIONAL INFORMATION CONTACT

Contractor _____

Contact Person _____

Phone # _____

Type of Work _____

NDOT (Formerly Public Works)

Phone #
615-862-8782

We appreciate your cooperation.

 To Request this information in an alternate format or ADA accommodations, please contact

Rick Kirkpatrick
615-862-8750

PROJECT NOTIFICATION



METROPOLITAN GOVERNMENT OF NASHVILLE AND DAVIDSON COUNTY

JOHN COOPER
MAYOR

NASHVILLE DEPARTMENT OF TRANSPORTATION
AND MULTIMODAL INFRASTRUCTURE

Chapter 13.20.020 Excavations and Obstruction Permissions and Notice Required

According to the referenced Code on Excavations and Obstructions in Metro Right of Way: “no excavation may be undertaken in any street, road, alley or right of way or of any utility or temporary construction easement of the Metropolitan Government or other government entity by any department of the metropolitan government or any other entity unless notice as required herein has been given”.

All contractors performing excavations in Metro right of way are required to provide 1 to 2 weeks of advance notice to the homeowners, residents, and businesses along the streets where the work is being performed. Your company must provide some form of documentation or proof that you have given adequate advance notice of your project. *Failure to do so could result in a triple fee fine to your permit.*

Attached is an example of what the door hangers or mailers should look like.

Please contact PWPermits@Nashville.gov or 615-862-8782 if you have any questions.

NDOT

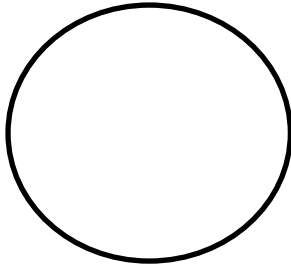

**Mayor
Freddie O'Connell**

*NASHVILLE DEPARTMENT of TRANSPORTATION
& MULTIMODAL INFRASTRUCTURE*

Please be informed that a project to pave your street will begin in approximately 1-2 weeks depending on weather conditions.

Please contact :
Hub Nashville at
615-862-8750
If you have any concerns



To Request this information in an alternate format or ADA accommodations, please contact
Rory.Rowan@nashville.gov

PROJECT NOTIFICATION

NDOT

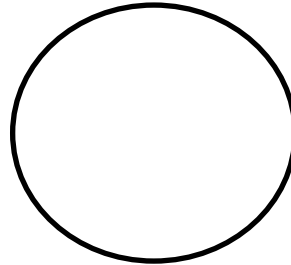

**Mayor
Freddie O'Connell**

*NASHVILLE DEPARTMENT of TRANSPORTATION
& MULTIMODAL INFRASTRUCTURE*

Please be informed that a project to pave your street will begin in approximately 1-2 weeks depending on weather conditions.

Please contact :
Hub Nashville at
615-862-8750
If you have any concerns



To Request this information in an alternate format or ADA accommodations, please contact
Rory.Rowan@nashville.gov

PROJECT NOTIFICATION

Nashville Department of Transportation

Change from Lane Closure to Street Closure Policy

Change from Lane Closure to Street Closure after Permit is Issued:

A Street Closure Application and Traffic Plan from a Licensed Traffic Engineer must be submitted for approval to the NDOT Permit Office to change the Permit issued for a Lane Closure to a Street Closure. All requests are assessed based on the scope of work, time required, and impacts to pedestrian and vehicular traffic. Street Closure request is reviewed and restrictions such as work times and need for Safety Officers/Traffic Management are based on the location, knowledge of traffic flows, existing permits already issued, and impacts to the public.

If a Street Closure is requested by the contractor for a permit with an existing Lane Closure, a meeting will be scheduled by the inspector with the contractor and the Permit Administrator to review the conditions and requirements. At that time if there is a need to adjust the Lane Closure parameters the inspector directs the contractor to request the change via e-mail to the Permit Office. The inspector will notify the Permit Office via email of their agreement with the request. If there is a need for a Street Closure, the contractor shall submit a traffic plan from a licensed Traffic Engineer that includes a detour plan with Safety Officers, traffic control and notification of the Street Closure to all Metro entities such as OEM, MNPS, MNP, NFD, and WeGo prior to the Street Closure. When the Street Closure Application and the Traffic Plan for the Street Closure is approved by the Permit Administrator, the original Lane Closure Permit will be revised to a Street Closure Permit and reissued. The contractor closes the road, and the inspector confirms that the plan is being followed and is working safely.

Intermittent Traffic Control (ITC) measures, in which a street is temporarily closed for a very short period (less than thirty minutes) must be documented on a Lane Closure Permit. The contractor should request this during their initial application. If during the initial site visit with the assigned inspector, if the need for ITC is identified but not clearly indicated on the permit, the contractor will need to request this addition via e-mail to the Permit Office. The inspector will notify the Permit Office via email of their agreement to add the ITC. If during the project, the need for ITC measures is identified, the contractor should notify the assigned inspector to discuss.

Change from Lane Closure to Street Closure after Permit is Issued due to Safety Conditions:

Changing a Lane Closure to a Street Closure requires following specific protocols. At any time during work if conditions at the site deteriorate such that there is an immediate traffic safety issue, the road should be immediately closed, and the contractor immediately contact the area inspector and the Permit Office. The area inspector will visit the site immediately to assess the situation associated with a potential Street Closure.

Based upon the revised approved Traffic Plan, it will be determined if variable message boards or other elements of a traffic control plan are required.

Nashville Department of Transportation

Change from Lane to Street Closure Procedures

1. Contractor emails Permit Office to request a change from Lane Closure to a Street closure.
Contractor submits a Traffic Plan from a Licensed Engineer and explains in detail why the change is needed.
2. Office staff receives the email from Contractor requesting a Street Closure and will send to Permit Administrator and NDOT Traffic Engineer for approval.
3. NDOT Permit Office and Traffic Engineer require a minimum of 5 days to review and approve the Traffic Plan for the Street Closure.
4. If the Street Closure is approved by Permit Administrator and Traffic Engineer, area inspector and Permit Office will receive a copy of approved traffic plans and approved Street Closure Permit.
5. The area inspector will contact contractor with approval and conditions of the permit. Inspector will also inform the contractor that it is their responsibility to contact and update the permit with the permit office.
6. Per emailed request to the permit office, referencing Lane closure permit #, the permit office can process a new Street Closure permit at no charge and showing it was paid for on a previous Lane Closure permit.
7. Prior to construction, contractor shall meet with area inspector on site to verify traffic control measures are in place. Inspector will document approval.

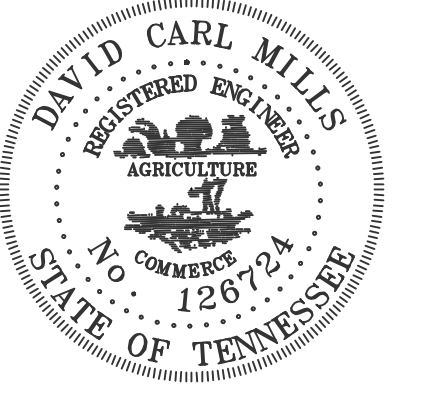

TRAFFIC CONTROL PLANS FOR 2ND AVENUE STREETSCAPE IMPROVEMENTS

TCP PHASE 2 & 3 FROM CHURCH ST. TO BROADWAY

ISSUE DATE
10-25-2023

NASHVILLE, DAVIDSON COUNTY TN, 37201
W&A PROJECT # CTS22049

CONSTRUCTION MANAGER:

REEVES + YOUNG
4101 CHARLOTTE AVENUE
SUITE E205
NASHVILLE, TN 37209

OWNER/DEVELOPER:

MDHA
701 S. 6TH STREET
NASHVILLE, TN 37206
ATTN: BRAD MUCKEL
615.252.8599

ENGINEER:

W & A ENGINEERING
4101 CHARLOTTE AVENUE
SUITE E215
NASHVILLE, TN 37209
ATTN: DAVID MILLS, PE
DMILLS@WAENGINEERING.COM
706.204.9685

SURVEYOR:

W & A ENGINEERING
4101 CHARLOTTE AVENUE
SUITE E215
NASHVILLE, TN 37209
ATTN: ADAM BLEDSOE, PLS
ABLEDSOE@WAENGINEERING.COM
615.610.1023

Sheet List Table	
Sheet Number	Sheet Title
C600	COVER
C602-E03	TCP TYPICAL SECTIONS
C605	TRAFFIC CONTROL PLAN - OVERALL PHASING PLAN
C610-C612	2ND AVE TCP - PHASE 1*
C620-C622	2ND AVE TCP - PHASE 2
C630-C632	2ND AVE TCP - PHASE 3
C633	DELIVERY ZONE DETAIL

* PREVIOUSLY SUBMITTED AND APPROVED

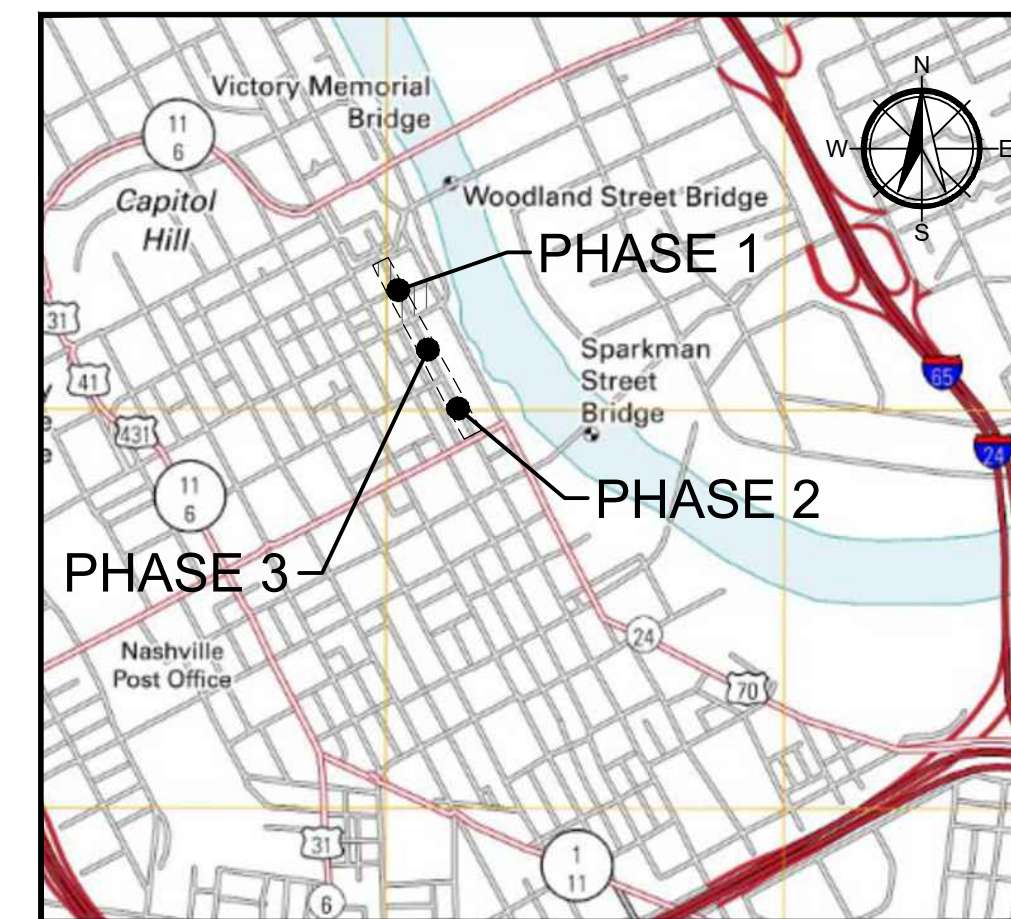

VICINITY MAP
SCALE: NTS

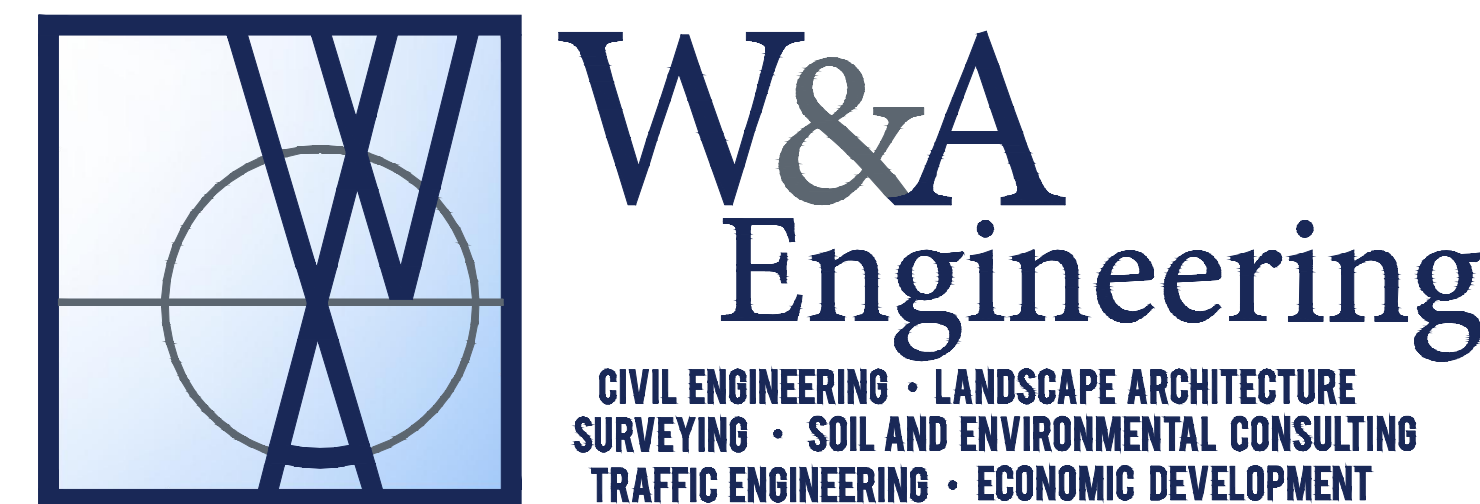

4101 Charlotte Avenue, Suite E215

Nashville, TN 37209

P: (615) 610-1023

waengineering.com

NOTE:
ALL DESIGN AND CONSTRUCTION ACTIVITIES SHALL BE
COMPLETED IN FULL COMPLIANCE WITH THE
AMERICANS WITH DISABILITIES ACT (ADA) 2010
STANDARDS FOR ACCESSIBLE DESIGN AS HAS BEEN
ADOPTED BY METRO

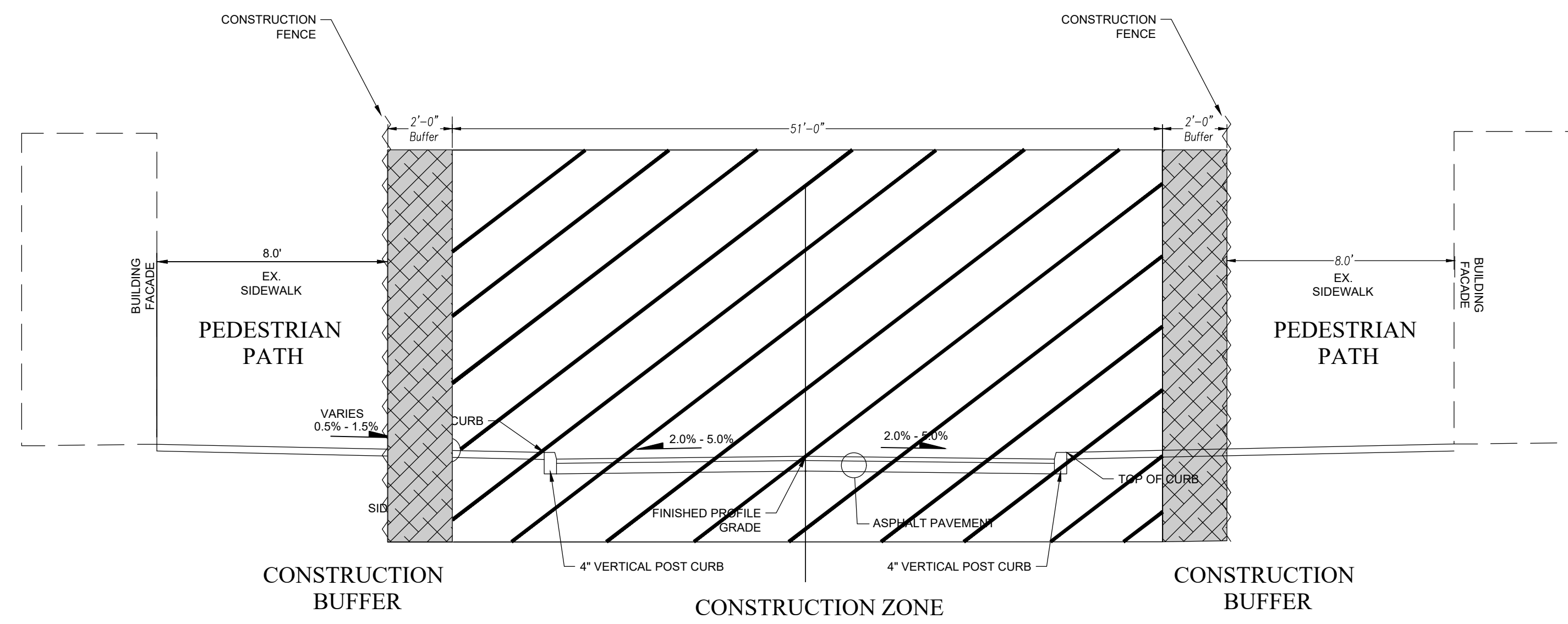

2ND AVENUE - COMMERCE ST. TO BROADWAY
PHASE 2A

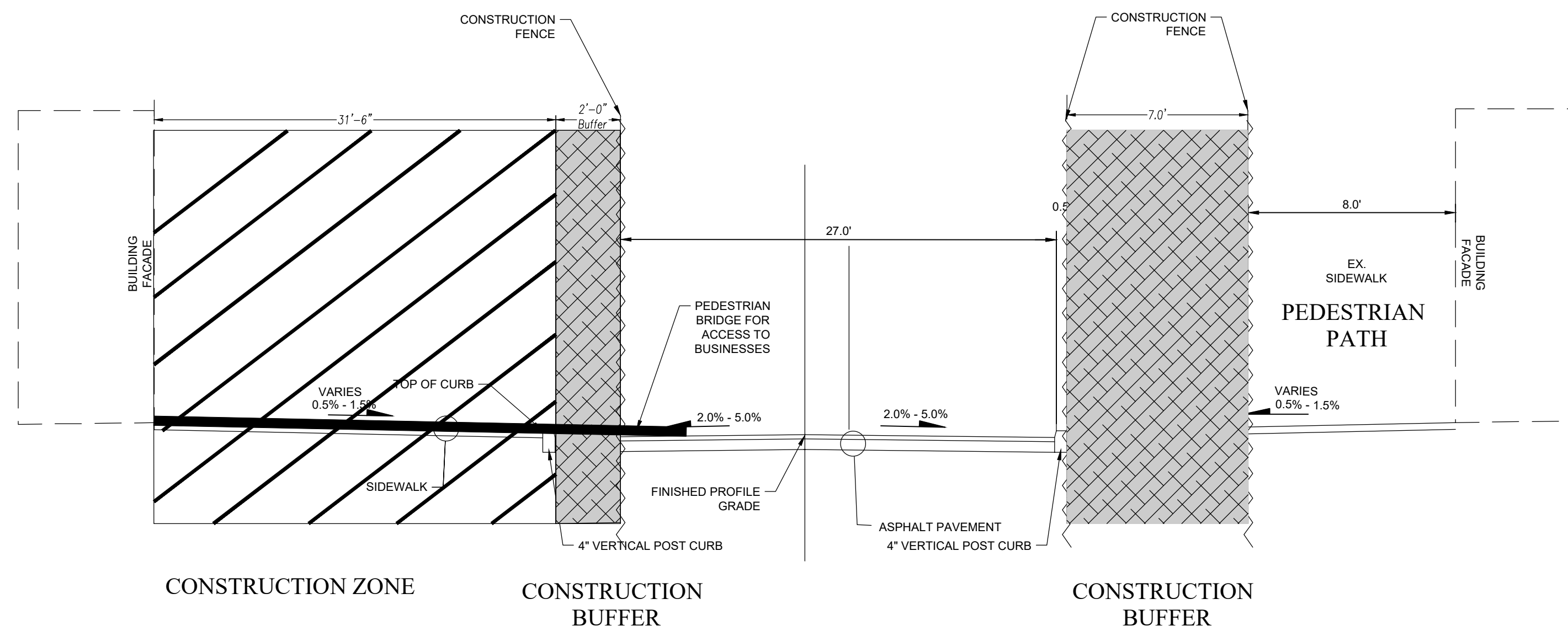

2ND AVENUE - COMMERCE ST. TO BROADWAY
PHASE 2B

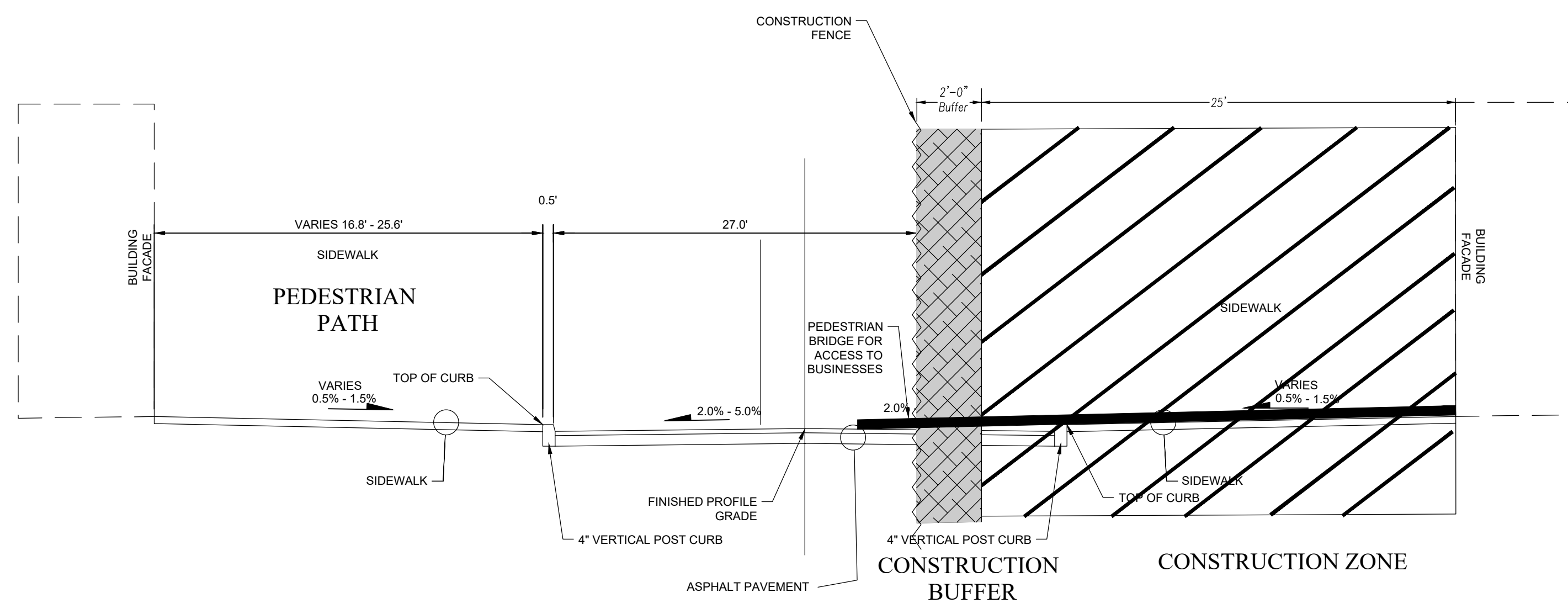

2ND AVENUE - COMMERCE ST. TO BROADWAY
PHASE 2C



807 2nd Avenue South
Nashville, TN 37206
P: (615) 610-1023
waengineering.com

ALL DRAWINGS SHALL REMAIN THE PROPERTY OF CLEAR COURSE. THESE INSTRUMENTS OF SERVICE ARE TO BE USED SOLELY FOR THIS SPECIFIC PROJECT. CLEAR COURSE SHALL RETAIN ALL LEGAL RIGHTS TO THE USE OF THE INSTRUMENTS OF SERVICE AND SHALL RETAIN FULL PROTECTION UNDER UNITED STATES COPYRIGHT LAW.

2ND AVENUE STREETSCAPE
IMPROVEMENTS

NASHVILLE, TN
REEVES + YOUNG

Know what's below.
Call before you dig. 811

REVISIONS	
DATE	COMMENT
3/17/23	NDOT REVIEW COMMENTS
10/17/23	NDOT REVIEW COMMENTS

NDOT REVIEW

INITIAL SUB. DATE: 03/01/23

ISSUANCE DATE: 10/20/23



CC PROJECT #: CTS22049

TRAFFIC CONTROL
TYPICAL SECTIONS

C602

X:\Projects\CTS2023\CTS22049-2nd Ave Streetscape - TTCP Design\Construction\Phase 2-3\DWG\CTS22049-TTCP\PH2&3.dwg 10-19-23 10:47:32 AM mmillins

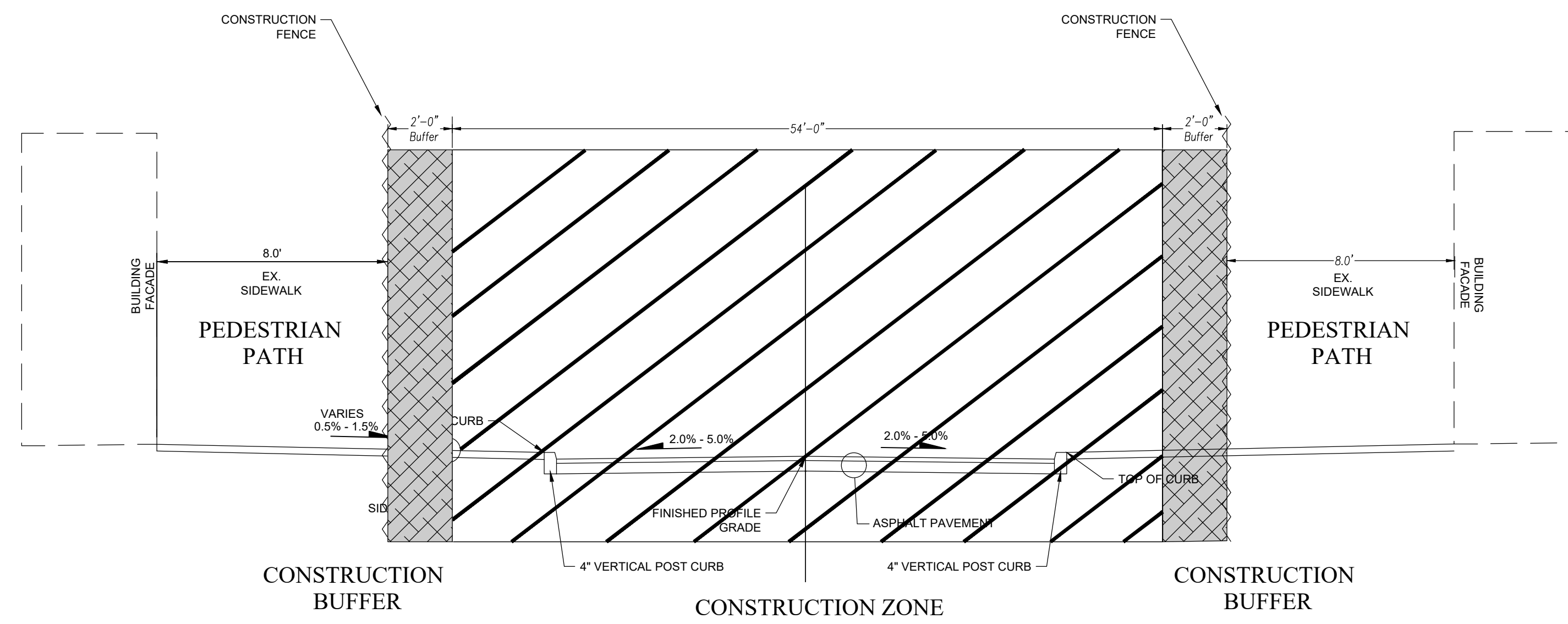

2ND AVENUE - CHURCH ST. TO COMMERCE ST.
PHASE 3A

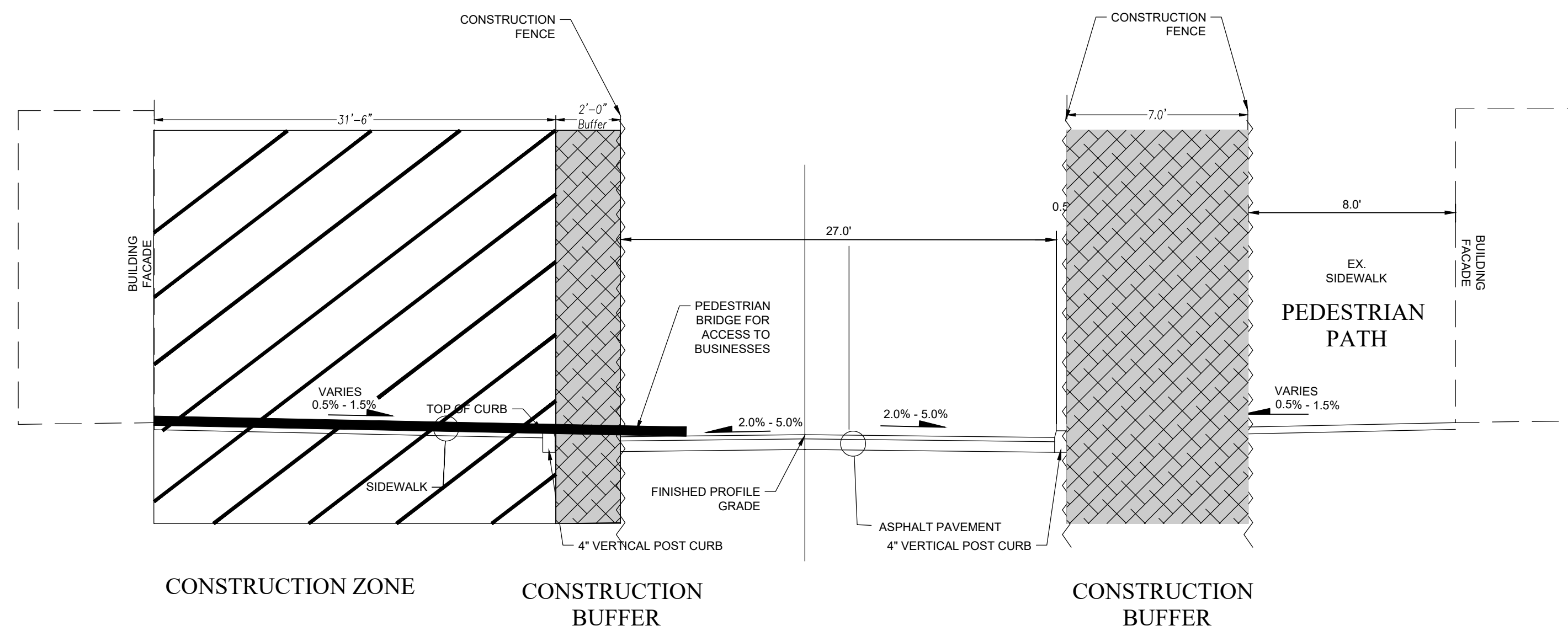

2ND AVENUE - CHURCH ST. TO COMMERCE ST.
PHASE 3B

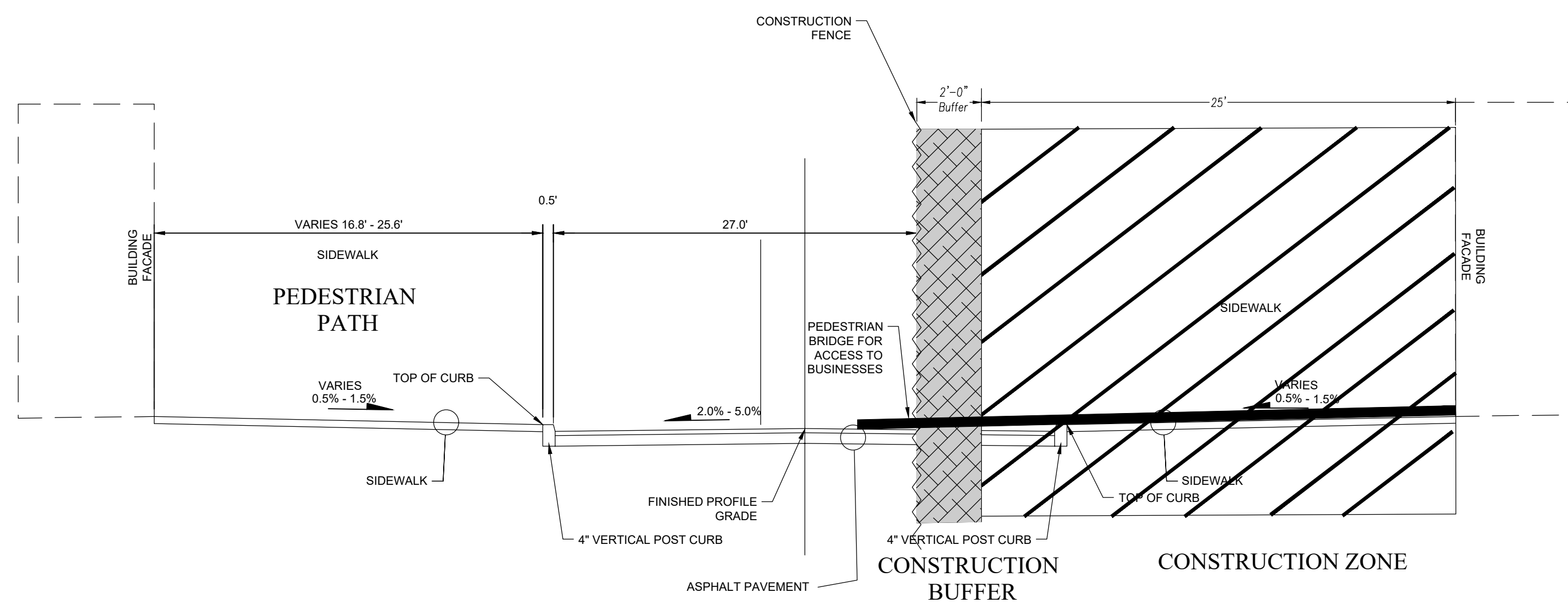

2ND AVENUE - CHURCH ST. TO COMMERCE ST.
PHASE 3C



807 2nd Avenue South
Nashville, TN 37206
P: (615) 610-1023
waengineering.com

ALL DRAWINGS SHALL REMAIN THE PROPERTY OF CLEAR COURSE. THESE INSTRUMENTS OF SERVICE ARE TO BE USED SOLELY FOR THIS SPECIFIC PROJECT. CLEAR COURSE SHALL RETAIN ALL LEGAL RIGHTS TO THE USE OF THE INSTRUMENTS OF SERVICE AND SHALL RETAIN FULL PROTECTION UNDER UNITED STATES COPYRIGHT LAW.

2ND AVENUE STREETSCAPE
IMPROVEMENTS

NASHVILLE, TN
REEVES + YOUNG

Know what's below.
Call before you dig. 811

REVISIONS	
DATE	COMMENT
3/31/23	NDOT REVIEW COMMENTS
10/17/23	NDOT REVIEW COMMENTS

NDOT REVIEW

INITIAL SUB. DATE: 03/01/23

ISSUANCE DATE: 10/20/23

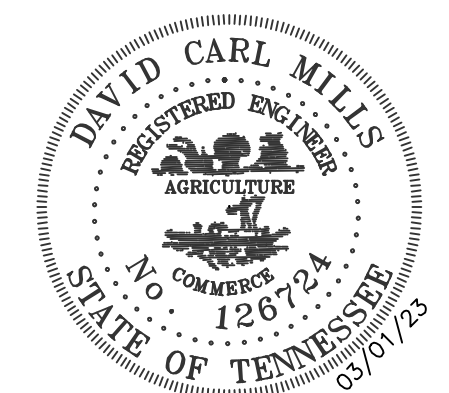

CC PROJECT #: CTS22049

TRAFFIC CONTROL
TYPICAL SECTIONS

C603

X:\Projects\CTS2023\CTS22049-2nd Ave Streetscape - TTCP Design\Construction\Phase 2-3\DWG\CTS22049-TTCP\PH2&3.dwg 10/19/23 10:47:54 PM mmillins

CONSTRUCTION PHASING NARRATIVE:
 SEE CONSTRUCTION NARRATIVE SUBMITTED WITH THE ROAD
 CLOSURE APPLICATION.

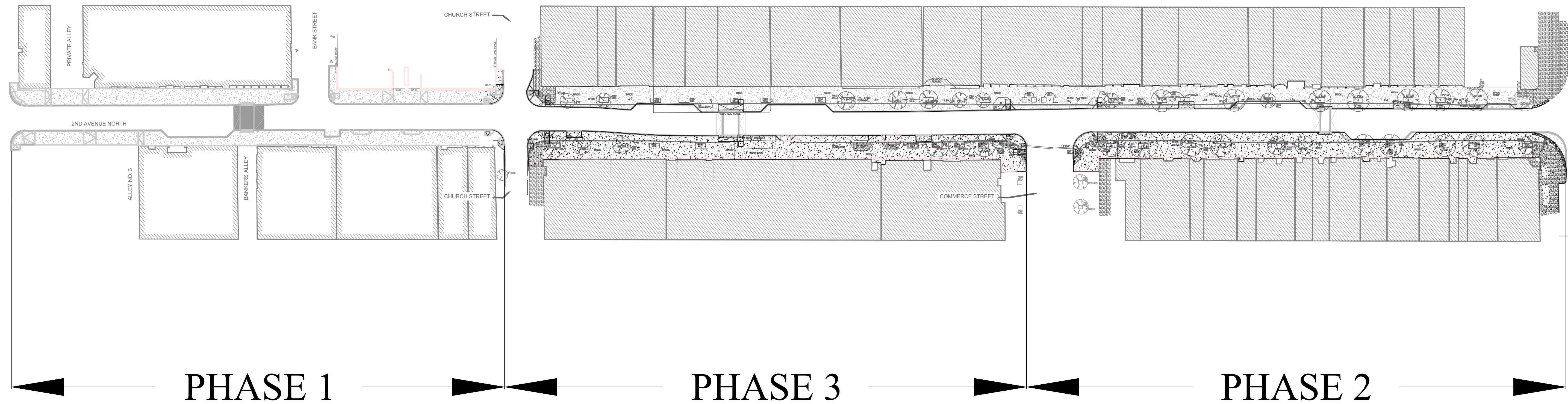

UNION ST.

CHURCH ST.

COMMERCE ST.

BROADWAY

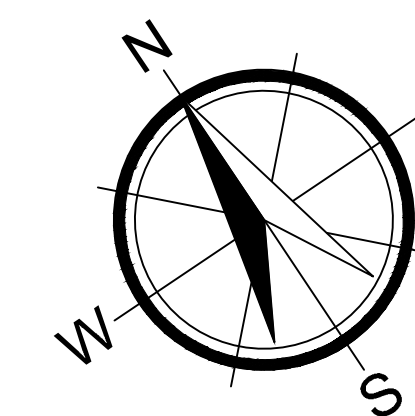

NTS 0 1/2" 1" 2"

CLEAR COURSE
 KEEPING COMMUNITIES
 IN MOTION

807 2nd Avenue South
 Nashville, TN 37206
 P: (615) 610-1023
 waengineering.com

**2ND AVENUE STREETSCAPE
 IMPROVEMENTS**

NASHVILLE, TN
 REEVES + YOUNG

Know what's below.
 Call before you dig.

REVISIONS

DATE	COMMENT
3/31/23	NDOT REVIEW COMMENTS

NDOT REVIEW
 INITIAL SUB. DATE: 03/01/23
 ISSUANCE DATE: 10/20/23

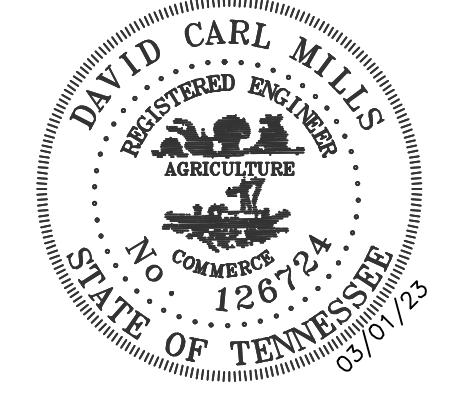

CC PROJECT #: CTS22049
 TCP - OVERALL
 PHASING PLAN

C605

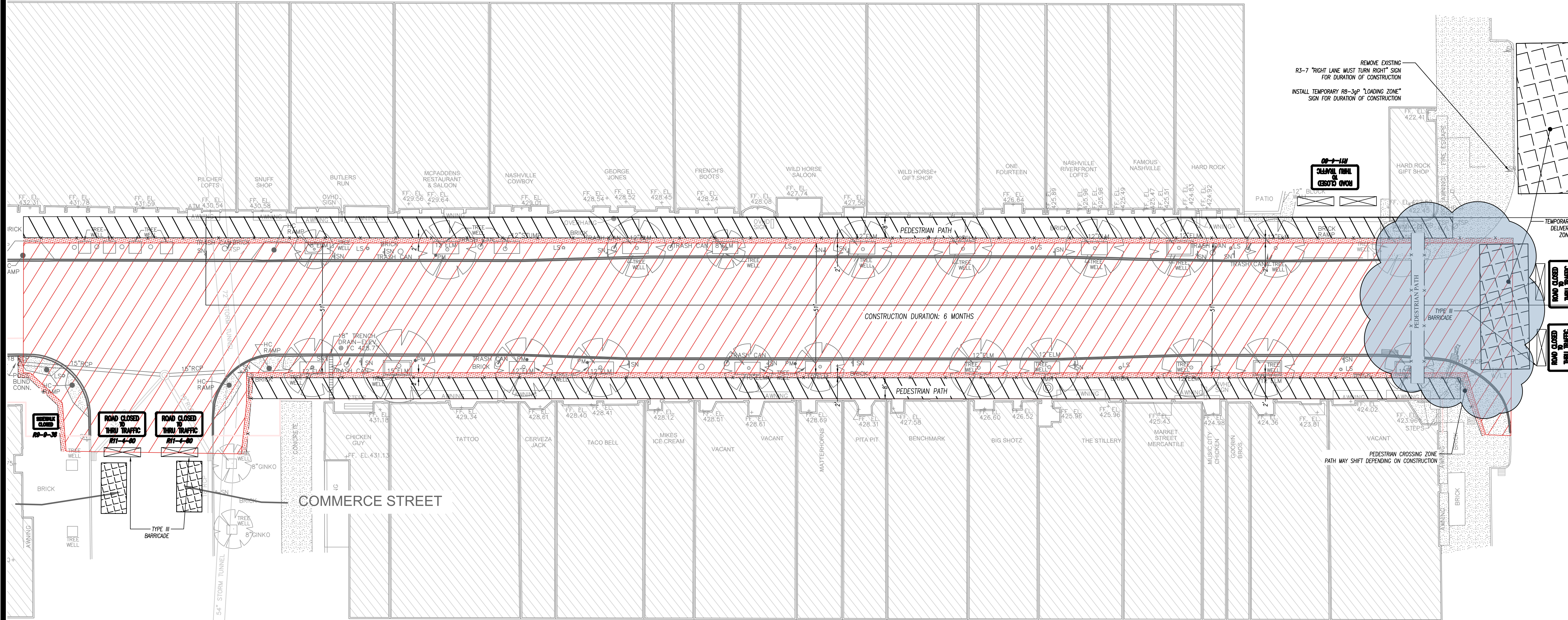
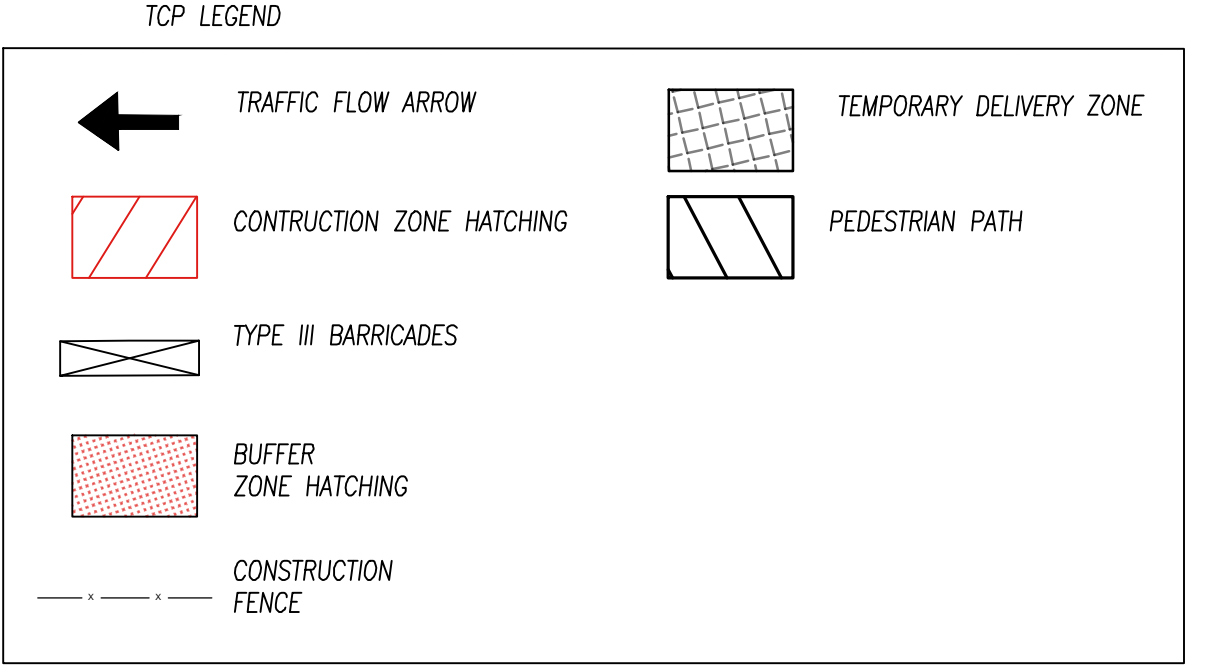

REMOVE EXISTING R3-7 "RIGHT LANE MUST TURN RIGHT" SIGN FOR DURATION OF CONSTRUCTION
 INSTALL TEMPORARY R8-3P "LOADING ZONE" SIGN FOR DURATION OF CONSTRUCTION

OP-1-11W
 ROAD CLOSED TO TRAFFIC

ROAD CLOSED TO TRAFFIC
 R11-4-80

ROAD CLOSED TO TRAFFIC
 R11-4-80

- SYMBOL LEGEND**
- PM PARKING METER
 - LS LIGHT POLE
 - SN EX. SIGN
 - EX. STREET TREE

PHASE 2A

BEGIN CONSTRUCTION IN CENTER OF 2ND AVE. FIRST:

- MAINTAIN 5' MIN. PEDESTRIAN PATH ON WEST & EAST SIDES.
- DEMO EXISTING CURB & GUTTER AND EXISTING PAVEMENT.
- INSTALL PROPOSED CURB & GUTTER AND PROPOSED STORM DRAIN AND SANITARY SEWER LINES.
- INSTALL PROPOSED FULL DEPTH PAVEMENT.

- TRAFFIC CONTROL NOTES:**
1. PLANNED CONSTRUCTION HOURS TO BE BETWEEN 7 AM-5 PM.
 2. TEMPORARY LIGHTING TO BE PROVIDED ALONG PEDESTRIAN PATH DURING PHASE 2.
 3. PHASE 2 DURATION ESTIMATED TO BE APPROXIMATELY 12 MONTHS.
 4. COORDINATION FOR TRAFFIC SIGNALS AT THE INTERSECTION OF COMMERCE ST. AND BROADWAY REQUIRED.
 5. BUSINESSES/STAKEHOLDER COORDINATION TO BE PROVIDED AS NEEDED BY REEVES YOUNG AND NDOT.
 6. TRASH PICKUP WILL BE UNAFFECTED BY CONSTRUCTION CLOSURES DURING THIS PHASE.
 7. DELIVERIES TO BUSINESSES WILL OCCUR IN TEMPORARY DELIVERY ZONES. SEE C633 FOR TEMPORARY DELIVERY ZONE DETAIL.
 8. SIGNAGE TO BE PROVIDED FOR BUSINESSES AND PEDESTRIANS AS NEEDED.

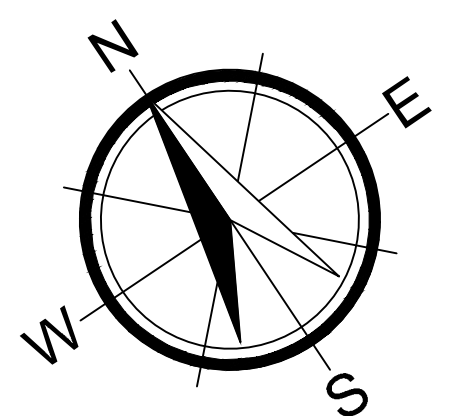

SCALE 1" = 20'

CLEAR COURSE
 KEEPING COMMUNITIES IN MOTION

807 2nd Avenue South
 Nashville, TN 37206
 P: (615) 610-1023
 waengineering.com

2ND AVENUE STREETSCAPE IMPROVEMENTS

NASHVILLE, TN
 REEVES + YOUNG

Know what's below. Call before you dig.

REVISIONS

DATE	COMMENT
3/31/23	NDOT REVIEW COMMENTS
10/17/23	NDOT REVIEW COMMENTS
10/25/23	NDOT REVIEW COMMENTS

NDOT REVIEW

INITIAL SUB. DATE: 03/01/23
 ISSUANCE DATE: 10/25/23

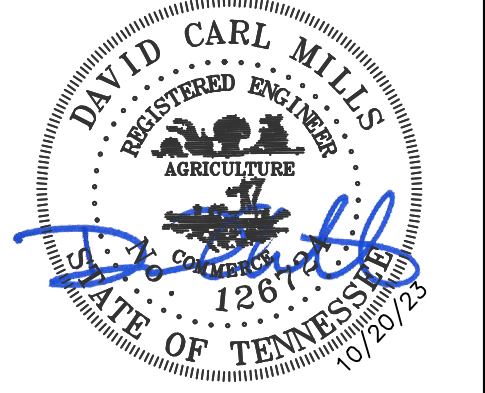

CC PROJECT #: CTS22049

TCP - PHASE 2A

C620

2ND AVENUE STREETSCAPE IMPROVEMENTS

NASHVILLE, TN
REEVES + YOUNG

Know what's below. Call before you dig.

REVISIONS	
DATE	COMMENT
3/31/23	NDOT REVIEW COMMENTS
10/17/23	NDOT REVIEW COMMENTS
10/25/23	NDOT REVIEW COMMENTS

NDOT REVIEW
INITIAL SUB. DATE: 03/01/23
ISSUANCE DATE: 10/25/23



CC PROJECT #: CTS22049

TCP - PHASE 2B

C621

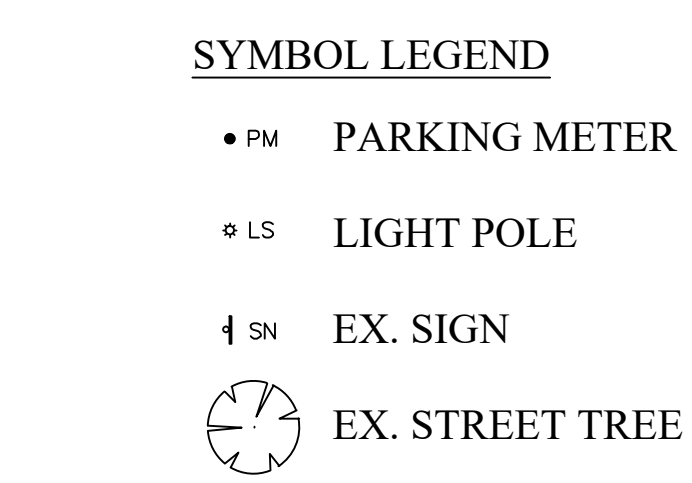
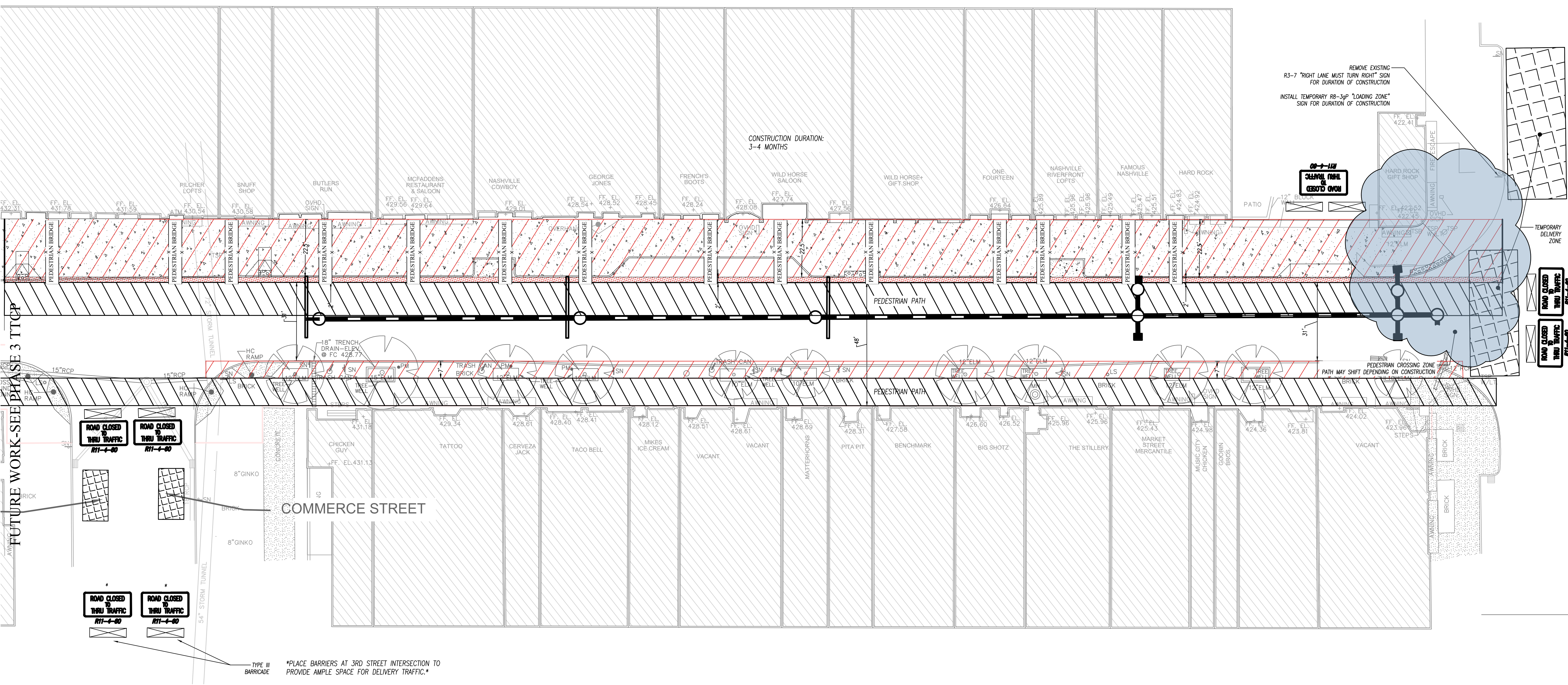
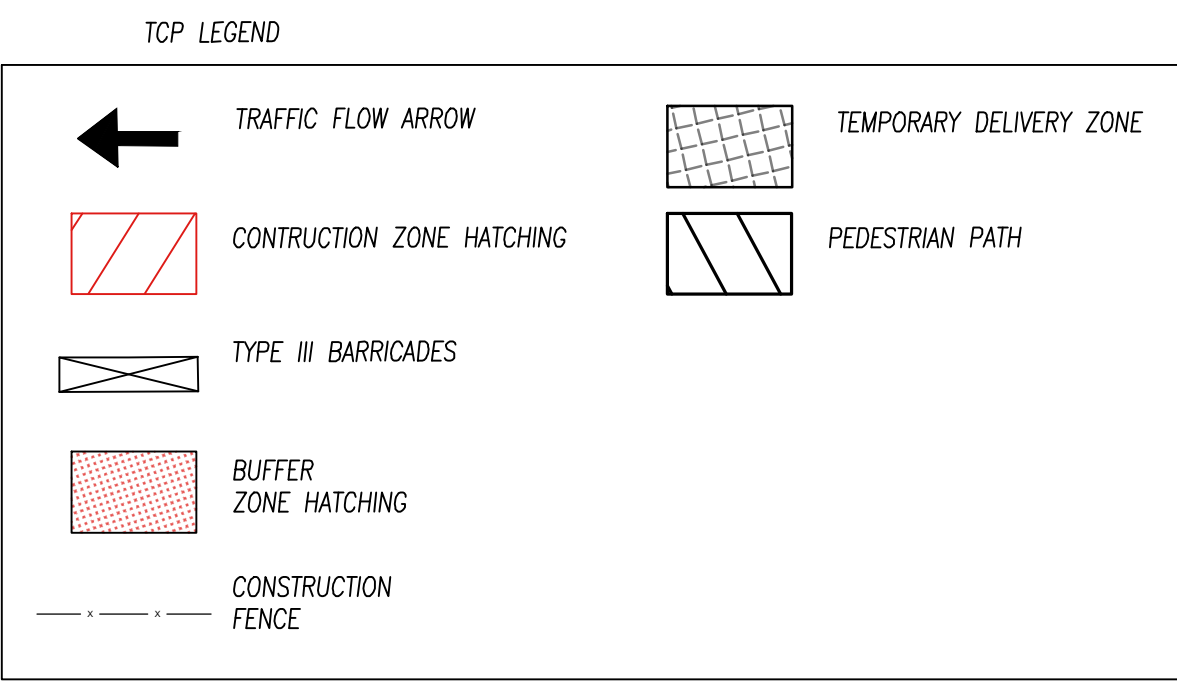

PHASE 2B

BEGIN CONSTRUCTION ON EAST SIDE OF 2ND AVE. FIRST:

- MAINTAIN 5' MIN. PEDESTRIAN PATH ON WEST SIDE.
- PEDESTRIAN ACCESS TO BUSINESSES WILL BE PROVIDED BY MARKED PEDESTRIAN BRIDGE AREAS.
- A 8 FT. MIN. FOOTPATH WILL BE PROVIDED IN THESE AREAS.
- INSTALL PROPOSED SIDEWALK, HARDSCAPE, AND LANDSCAPING ON EAST SIDE.

- TRAFFIC CONTROL NOTES:**
1. PLANNED CONSTRUCTION HOURS TO BE BETWEEN 7 AM-5 PM.
 2. TEMPORARY LIGHTING TO BE PROVIDED ALONG PEDESTRIAN PATH DURING PHASE 2.
 3. PHASE 2 DURATION ESTIMATED TO BE APPROXIMATELY 12 MONTHS.
 4. COORDINATION FOR TRAFFIC SIGNALS AT THE INTERSECTION OF COMMERCE ST. AND BROADWAY REQUIRED.
 5. BUSINESSES/STAKEHOLDER COORDINATION TO BE PROVIDED AS NEEDED BY REEVES YOUNG AND NDOT.
 6. TRASH PICKUP WILL BE UNAFFECTED BY CONSTRUCTION CLOSURES DURING THIS PHASE.
 7. DELIVERIES TO BUSINESSES WILL OCCUR IN TEMPORARY DELIVERY ZONE DETAIL.
 8. SIGNAGE TO BE PROVIDED FOR BUSINESSES AND PEDESTRIANS AS NEEDED.

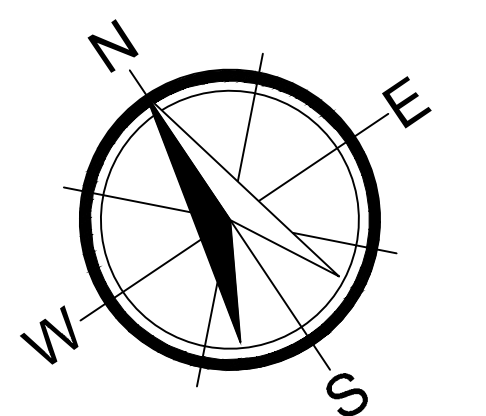

SCALE 1" = 20'

FUTURE WORK - SEE PHASE 3 TTCP

INSERT: COMMERCE STREET INTERSECTION

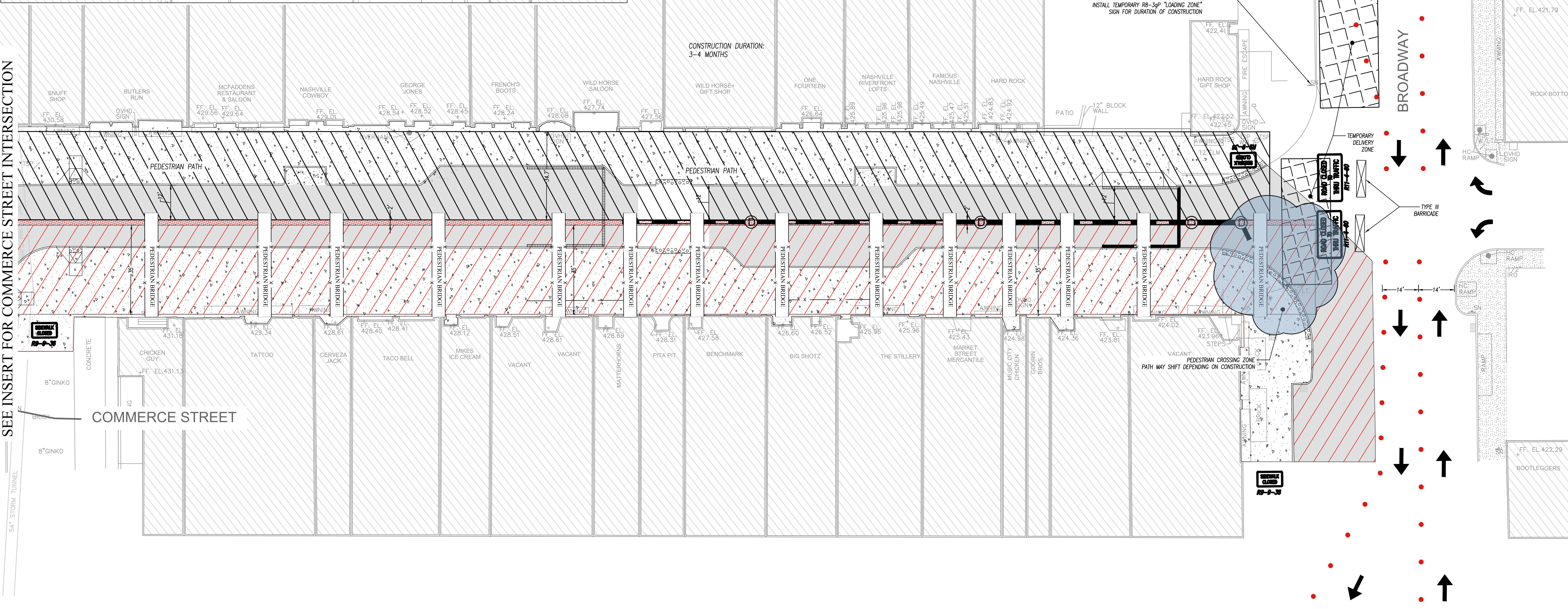
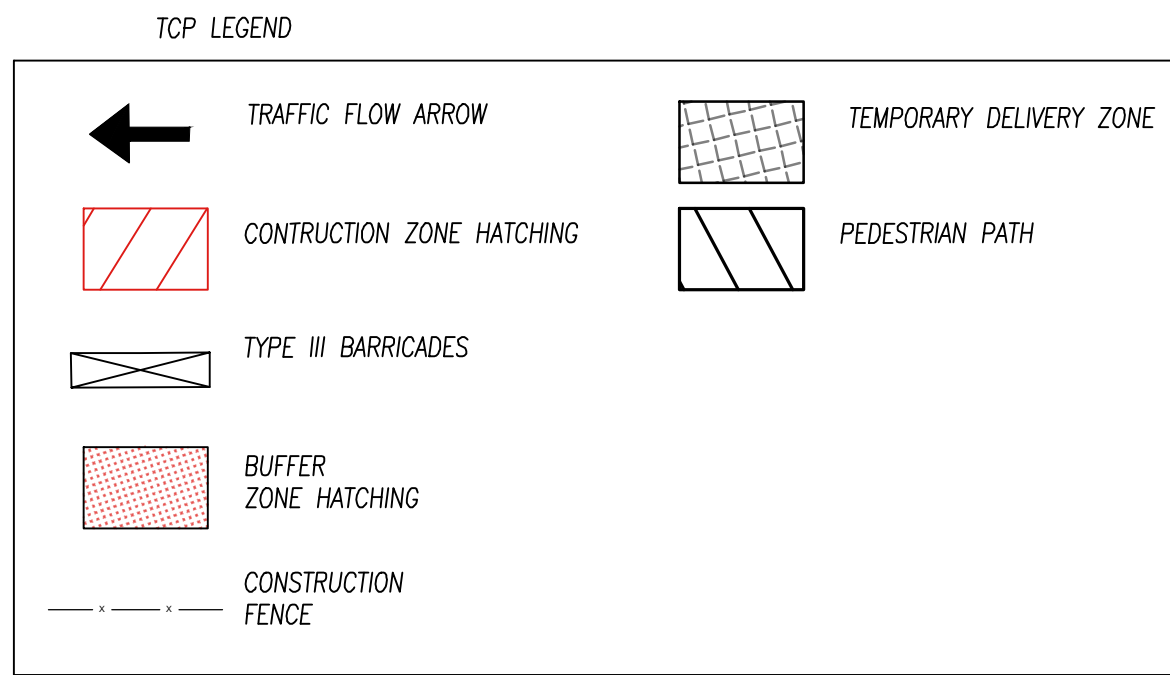
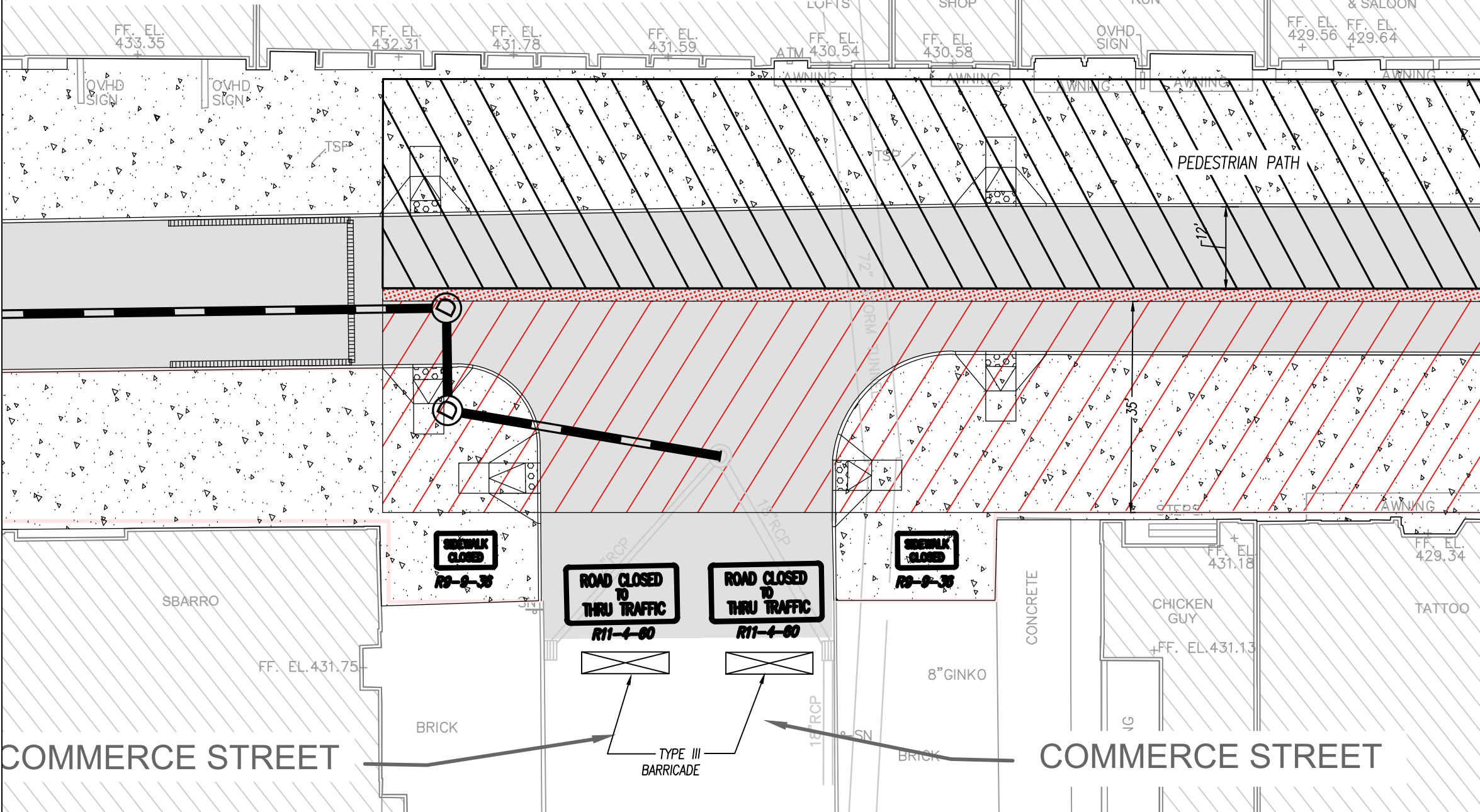

SEE INSERT FOR COMMERCE STREET INTERSECTION

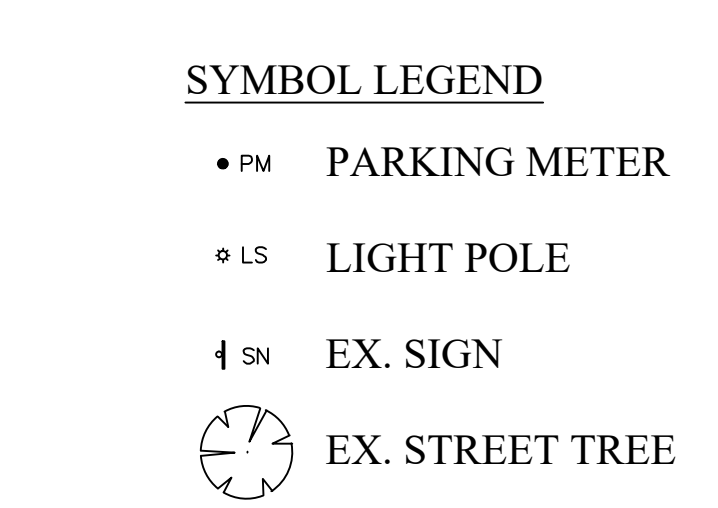

PHASE 2C

BEGIN CONSTRUCTION ON EAST SIDE OF 2ND AVE. FIRST:

- MAINTAIN 5' MIN. PEDESTRIAN PATH ON WEST SIDE.
- PEDESTRIAN ACCESS TO BUSINESSES WILL BE PROVIDED BY MARKED PEDESTRIAN BRIDGE AREAS.
- A 8 FT. MIN. FOOTPATH WILL BE PROVIDED IN THESE AREAS.
- INSTALL PROPOSED SIDEWALK, HARDSCAPE, AND LANDSCAPING ON EAST SIDE.

TRAFFIC CONTROL NOTES:

1. PLANNED CONSTRUCTION HOURS TO BE BETWEEN 7 AM-5 PM.
2. TEMPORARY LIGHTING TO BE PROVIDED ALONG PEDESTRIAN PATH DURING PHASE 2.
3. PHASE 2 DURATION ESTIMATED TO BE APPROXIMATELY 12 MONTHS.
4. COORDINATION FOR TRAFFIC SIGNALS AT THE INTERSECTION OF COMMERCE ST. AND BROADWAY REQUIRED.
5. BUSINESSES/STAKEHOLDER COORDINATION TO BE PROVIDED AS NEEDED BY REEVES YOUNG AND NDOT.
6. TRASH PICKUP WILL BE UNAFFECTED BY CONSTRUCTION CLOSURES DURING THIS PHASE.
7. DELIVERIES TO BUSINESSES WILL OCCUR IN TEMPORARY DELIVERY ZONES. SEE C633 FOR TEMPORARY DELIVERY ZONE DETAIL.
8. SIGNAGE TO BE PROVIDED FOR BUSINESSES AND PEDESTRIANS AS NEEDED.

CLEAR COURSE
KEEPING COMMUNITIES IN MOTION

807 2nd Avenue South
Nashville, TN 37206
P: (615) 610-1023
waengineering.com

ALL DRAWINGS SHALL REMAIN THE PROPERTY OF CLEAR COURSE. THESE INSTRUMENTS OF SERVICE ARE TO BE USED SOLELY FOR THIS SPECIFIC PROJECT. CLEAR COURSE SHALL RETAIN ALL LEGAL RIGHTS TO THE USE OF THE INSTRUMENTS OF SERVICE AND SHALL RETAIN FULL PROTECTION UNDER UNITED STATES COPYRIGHT LAW.

2ND AVENUE STREETSCAPE IMPROVEMENTS

NASHVILLE, TN
REEVES + YOUNG

Know what's below. Call before you dig.

REVISIONS

DATE	COMMENT
3/31/23	NDOT REVIEW COMMENTS
10/17/23	NDOT REVIEW COMMENTS
10/25/23	NDOT REVIEW COMMENTS

NDOT REVIEW

INITIAL SUB. DATE: 03/01/23
ISSUANCE DATE: 10/25/23



CC PROJECT #: CTS22049

TCP - PHASE 2C

C622

SCALE 1" = 30'

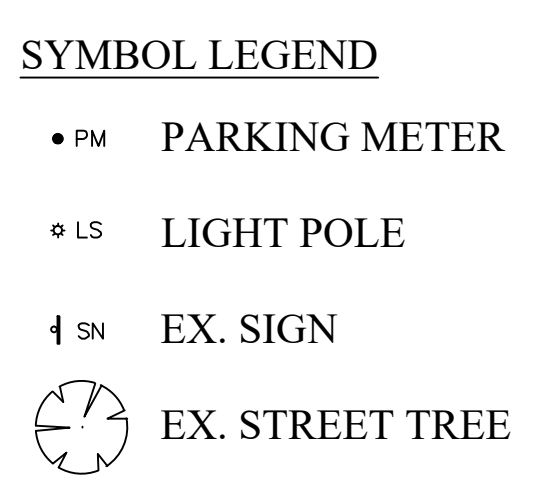
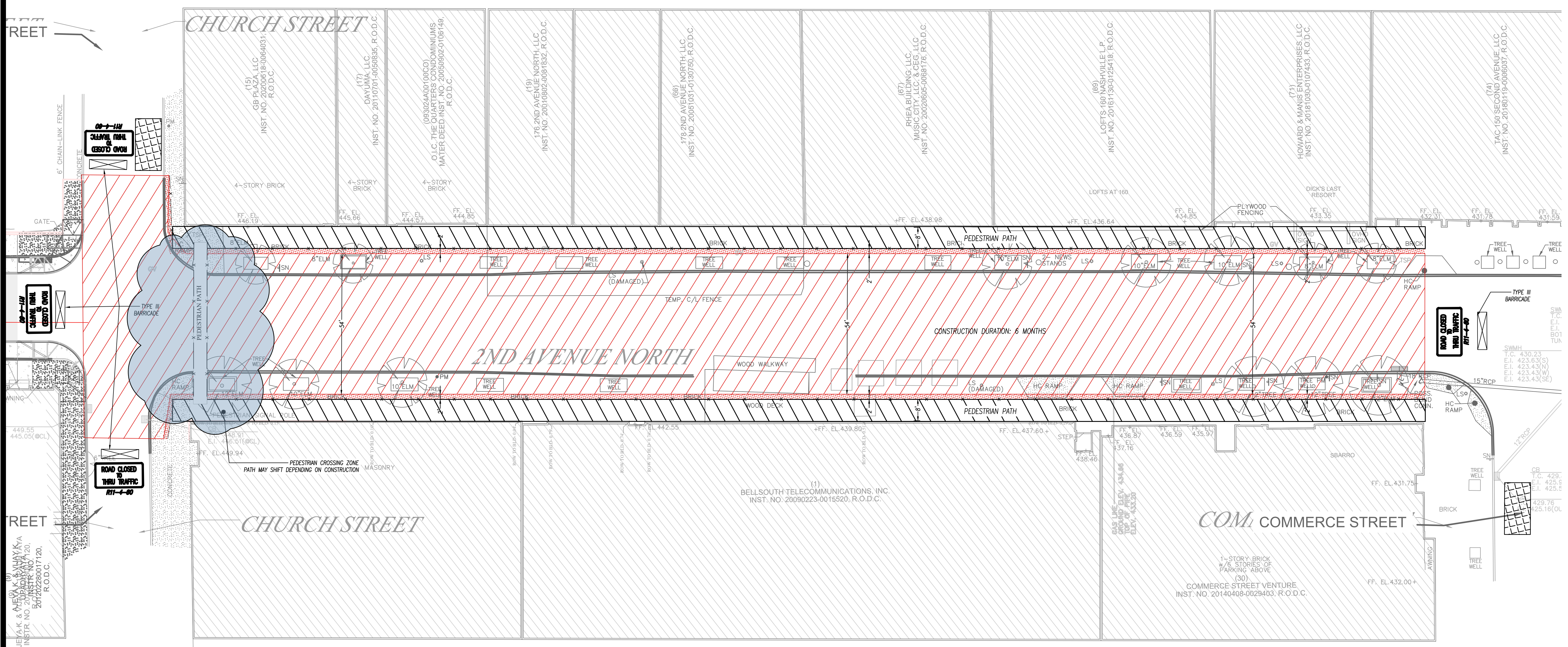
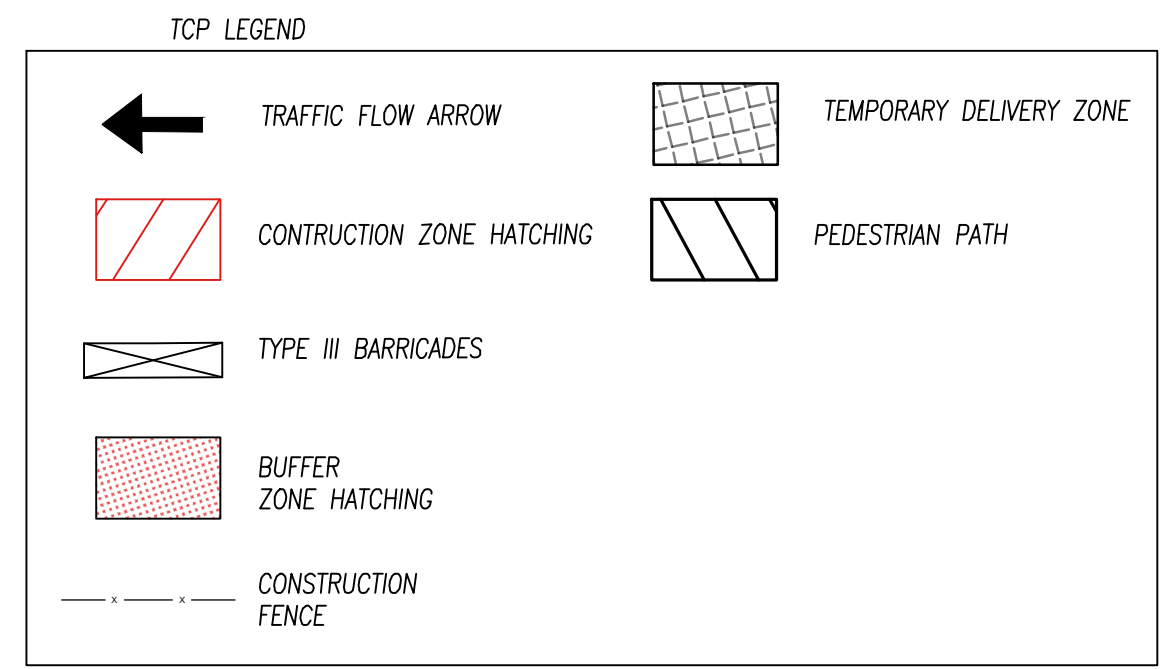

PHASE 3A

BEGIN CONSTRUCTION IN CENTER OF 2ND AVE. FIRST:

- MAINTAIN 5' MIN. PEDESTRIAN PATH ON WEST & EAST SIDES.
- DEMO EXISTING CURB & GUTTER AND EXISTING PAVEMENT.
- INSTALL PROPOSED CURB & GUTTER AND PROPOSED STORM DRAIN AND SANITARY SEWER LINES.
- INSTALL PROPOSED FULL DEPTH PAVEMENT.

- TRAFFIC CONTROL NOTES:
1. PLANNED CONSTRUCTION HOURS TO BE BETWEEN 7 AM-5 PM.
 2. TEMPORARY LIGHTING TO BE PROVIDED ALONG PEDESTRIAN PATH DURING PHASE 2.
 3. PHASE 2 DURATION ESTIMATED TO BE APPROXIMATELY 12 MONTHS.
 4. COORDINATION FOR TRAFFIC SIGNALS AT THE INTERSECTION OF COMMERCE ST. AND BROADWAY REQUIRED.
 5. BUSINESSES/STAKEHOLDER COORDINATION TO BE PROVIDED AS NEEDED BY REEVES YOUNG AND NDOT.
 6. TRASH PICKUP WILL BE UNAFFECTED BY CONSTRUCTION CLOSURES DURING THIS PHASE.
 7. DELIVERIES TO BUSINESSES WILL OCCUR IN TEMPORARY DELIVERY ZONES. SEE C633 FOR TEMPORARY DELIVERY ZONE DETAIL.
 8. SIGNAGE TO BE PROVIDED FOR BUSINESSES AND PEDESTRIANS AS NEEDED.

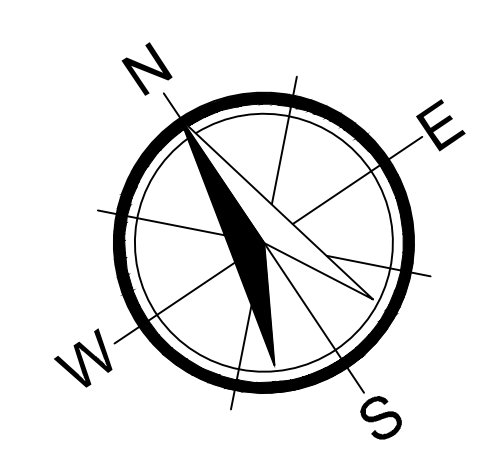

SCALE 1" = 20'

CLEAR COURSE
KEEPING COMMUNITIES IN MOTION

807 2nd Avenue South
Nashville, TN 37206
P: (615) 610-1023
waengineering.com

2ND AVENUE STREETSCAPE IMPROVEMENTS

NASHVILLE, TN
REEVES + YOUNG

Know what's below. Call before you dig.

REVISIONS

DATE	COMMENT
3/31/23	NDOT REVIEW COMMENTS
10/17/23	NDOT REVIEW COMMENTS
10/25/23	NDOT REVIEW COMMENTS

NDOT REVIEW

INITIAL SUB. DATE: 03/01/23
ISSUANCE DATE: 10/25/23



CC PROJECT #: CTS22049

TCP - PHASE 3A

C630

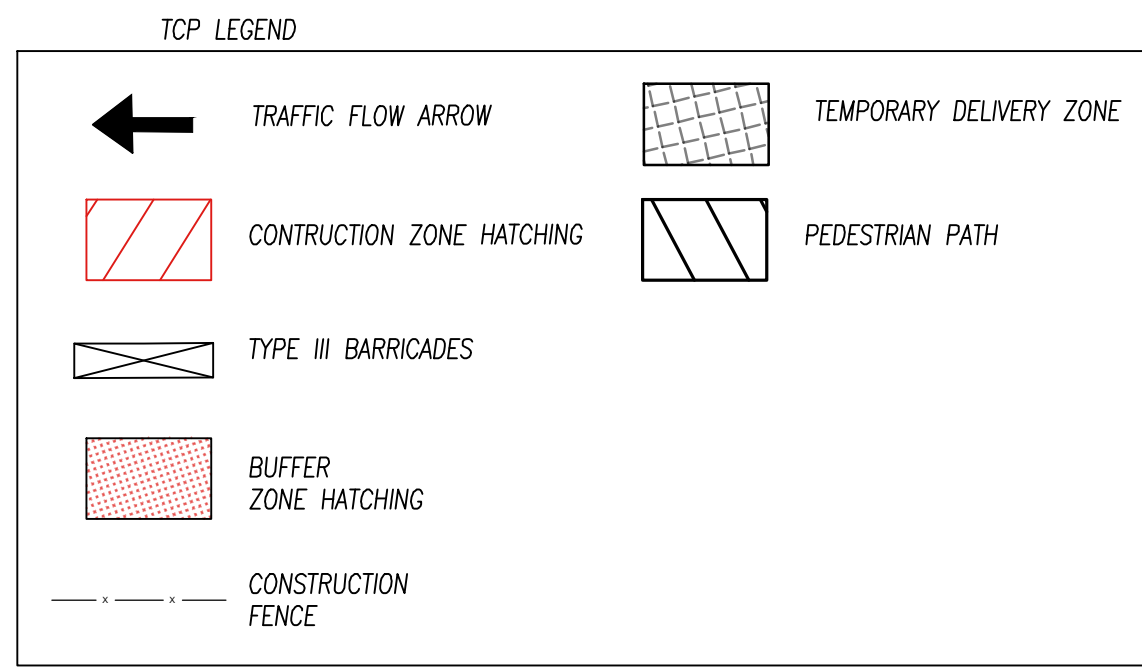
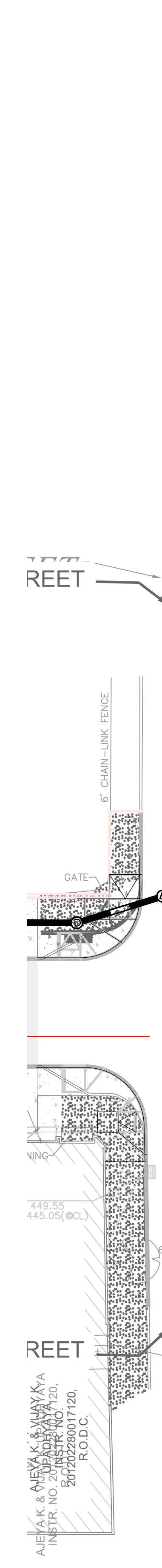

CLEAR COURSE
KEEPING COMMUNITIES IN MOTION

807 2nd Avenue South
Nashville, TN 37206
P: (615) 610-1023
waengineering.com

ALL DRAWINGS SHALL REMAIN THE PROPERTY OF CLEAR COURSE. THESE INSTRUMENTS OF SERVICE ARE TO BE USED SOLELY FOR THIS SPECIFIC PROJECT. CLEAR COURSE SHALL RETAIN ALL LEGAL RIGHTS TO THE USE OF THE INSTRUMENTS OF SERVICE AND SHALL RETAIN FULL PROTECTION UNDER UNITED STATES COPYRIGHT LAW.

2ND AVENUE STREETSCAPE IMPROVEMENTS
NASHVILLE, TN
REEVES + YOUNG

Know what's below. Call before you dig.

REVISIONS

DATE	COMMENT
3/31/23	NDOT REVIEW COMMENTS
10/17/23	NDOT REVIEW COMMENTS
10/25/23	NDOT REVIEW COMMENTS

NDOT REVIEW
INITIAL SUB. DATE: 03/01/23
ISSUANCE DATE: 10/25/23



CC PROJECT #: CTS22049

TCP - PHASE 3B

C631

SYMBOL LEGEND

- PM PARKING METER
- LS LIGHT POLE
- SN EX. SIGN
- EX. STREET TREE

PHASE 3B

BEGIN CONSTRUCTION ON EAST SIDE OF 2ND AVE. FIRST:

- MAINTAIN 5' MIN. PEDESTRIAN PATH ON WEST SIDE.
- PEDESTRIAN ACCESS TO BUSINESSES WILL BE PROVIDED BY MARKED PEDESTRIAN BRIDGE AREAS.
- A 8 FT. MIN. FOOTPATH WILL BE PROVIDED IN THESE AREAS.
- INSTALL PROPOSED SIDEWALK, HARDSCAPE, AND LANDSCAPING ON EAST SIDE.

- TRAFFIC CONTROL NOTES:**
1. PLANNED CONSTRUCTION HOURS TO BE BETWEEN 7 AM-5 PM.
 2. TEMPORARY LIGHTING TO BE PROVIDED ALONG PEDESTRIAN PATH DURING PHASE 2.
 3. PHASE 2 DURATION ESTIMATED TO BE APPROXIMATELY 12 MONTHS.
 4. COORDINATION FOR TRAFFIC SIGNALS AT THE INTERSECTION OF COMMERCE ST. AND BROADWAY REQUIRED.
 5. BUSINESSES/STAKEHOLDER COORDINATION TO BE PROVIDED AS NEEDED BY REEVES YOUNG AND NDOT.
 6. TRASH PICKUP WILL BE UNAFFECTED BY CONSTRUCTION CLOSURES DURING THIS PHASE.
 7. DELIVERIES TO BUSINESSES WILL OCCUR IN TEMPORARY DELIVERY ZONES. SEE C633 FOR TEMPORARY DELIVERY ZONE DETAIL.
 8. SIGNAGE TO BE PROVIDED FOR BUSINESSES AND PEDESTRIANS AS NEEDED.

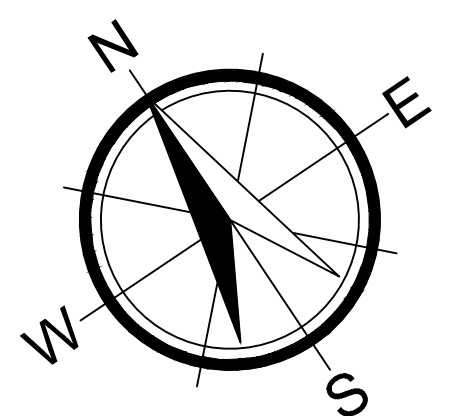

SCALE 1" = 20'

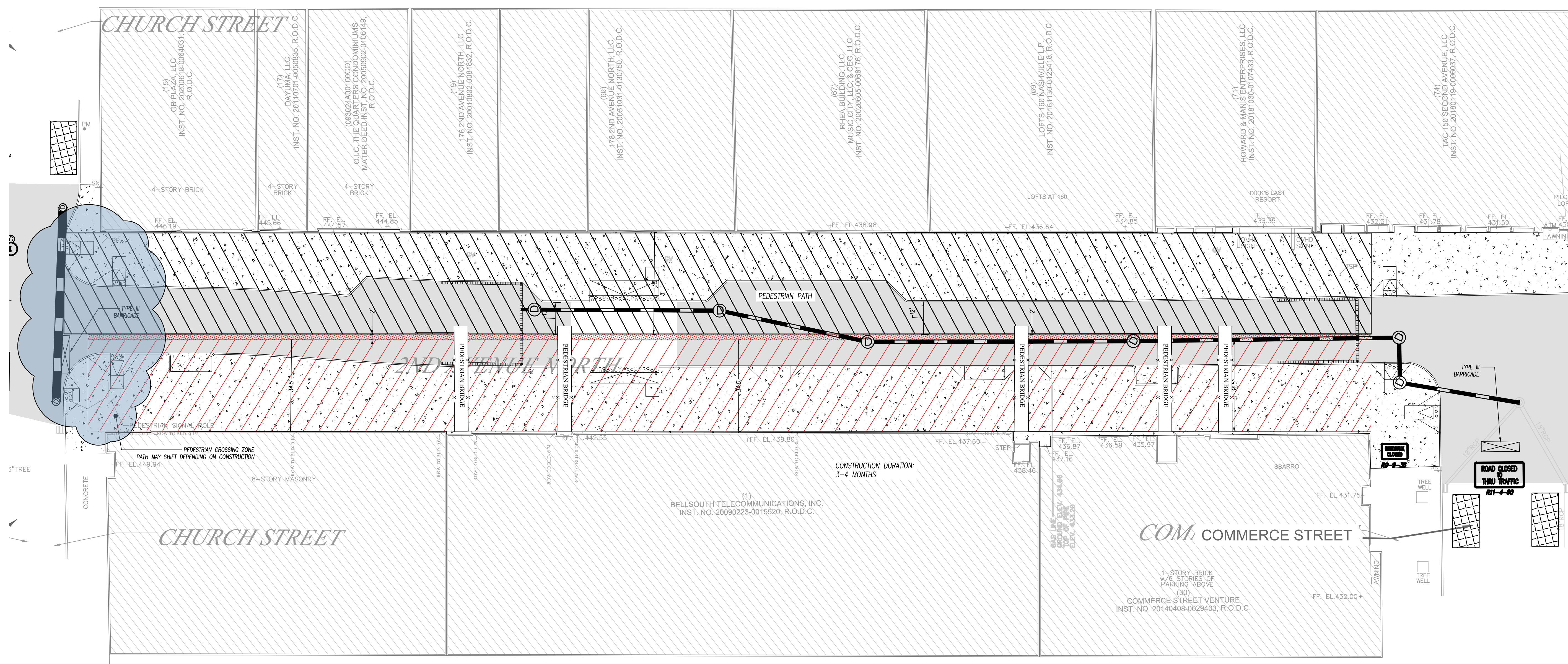
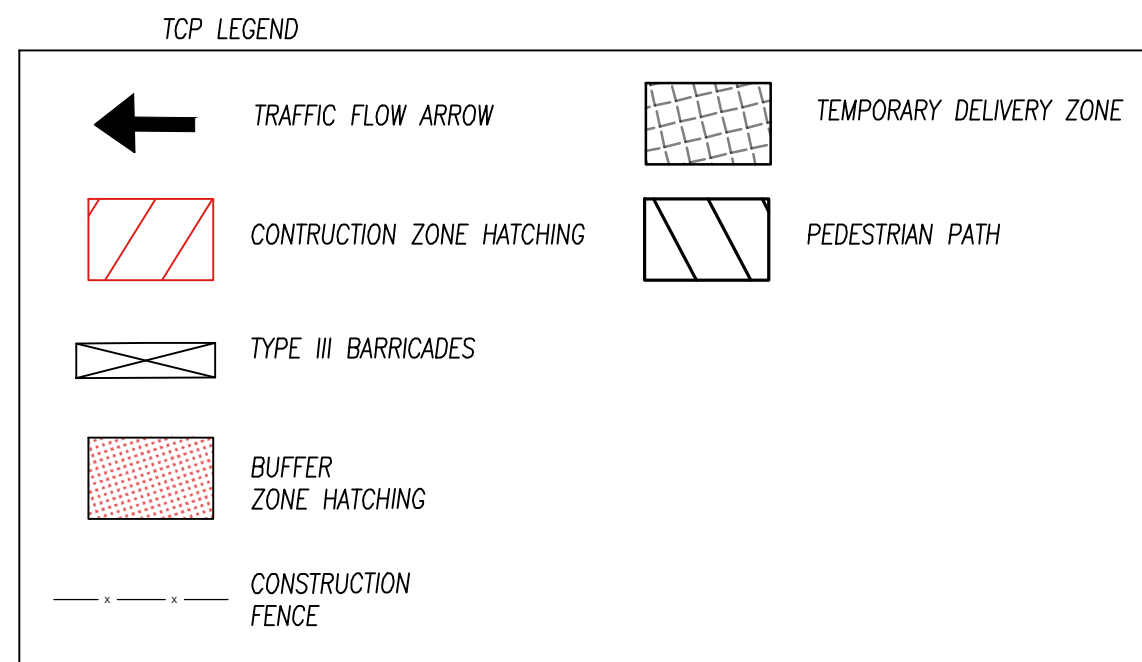

- SYMBOL LEGEND**
- PM PARKING METER
 - LS LIGHT POLE
 - ↑ SN EX. SIGN
 - ⊙ EX. STREET TREE

PHASE 3C

BEGIN CONSTRUCTION ON EAST SIDE OF 2ND AVE. FIRST:

- MAINTAIN 5' MIN. PEDESTRIAN PATH ON WEST SIDE.
- PEDESTRIAN ACCESS TO BUSINESSES WILL BE PROVIDED BY MARKED PEDESTRIAN BRIDGE AREAS.
- A 8 FT. MIN. FOOTPATH WILL BE PROVIDED IN THESE AREAS.
- INSTALL PROPOSED SIDEWALK, HARDSCAPE, AND LANDSCAPING ON EAST SIDE.

- TRAFFIC CONTROL NOTES:**
1. PLANNED CONSTRUCTION HOURS TO BE BETWEEN 7 AM-5 PM.
 2. TEMPORARY LIGHTING TO BE PROVIDED ALONG PEDESTRIAN PATH DURING PHASE 2.
 3. PHASE 2 DURATION ESTIMATED TO BE APPROXIMATELY 12 MONTHS.
 4. COORDINATION FOR TRAFFIC SIGNALS AT THE INTERSECTION OF COMMERCE ST. AND BROADWAY REQUIRED.
 5. BUSINESSES/STAKEHOLDER COORDINATION TO BE PROVIDED AS NEEDED BY REEVES YOUNG AND NDOT.
 6. TRASH PICKUP WILL BE UNAFFECTED BY CONSTRUCTION CLOSURES DURING THIS PHASE.
 7. DELIVERIES TO BUSINESSES WILL OCCUR IN TEMPORARY DELIVERY ZONES. SEE C633 FOR TEMPORARY DELIVERY ZONE DETAIL.
 8. SIGNAGE TO BE PROVIDED FOR BUSINESSES AND PEDESTRIANS AS NEEDED.

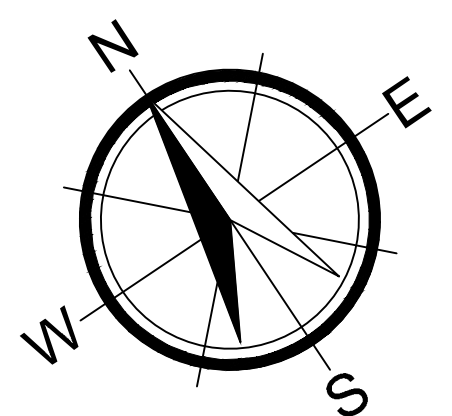

SCALE 1" = 20'

CLEAR COURSE
KEEPING COMMUNITIES IN MOTION

807 2nd Avenue South
Nashville, TN 37206
P: (615) 610-1023
waengineering.com

2ND AVENUE STREETSCAPE IMPROVEMENTS

NASHVILLE, TN
REEVES + YOUNG

Know what's below. Call before you dig.

REVISIONS

DATE	COMMENT
3/31/23	NDOT REVIEW COMMENTS
10/17/23	NDOT REVIEW COMMENTS
10/25/23	NDOT REVIEW COMMENTS

NDOT REVIEW

INITIAL SUB. DATE: 03/01/23
ISSUANCE DATE: 10/25/23



CC PROJECT #: CTS22049

TCP - PHASE 3C

C632

CONSTRUCTION PHASING NARRATIVE:
 SEE CONSTRUCTION NARRATIVE SUBMITTED WITH THE ROAD
 CLOSURE APPLICATION.
 ON-STREET PARKING TO BE CLOSED DURING PHASES 2 & 3.

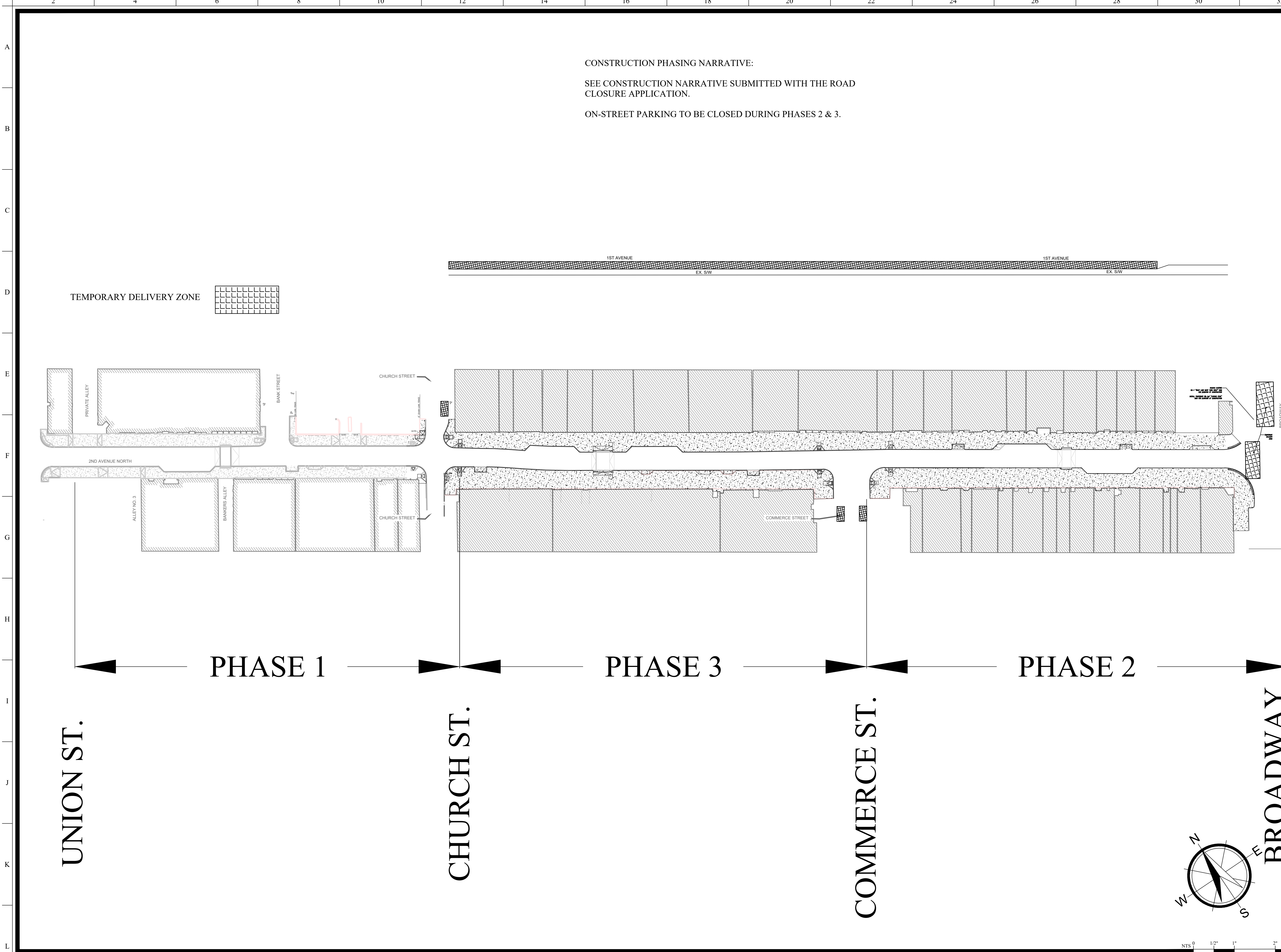

CLEAR COURSE
 KEEPING COMMUNITIES
 IN MOTION

807 2nd Avenue South
 Nashville, TN 37206
 P: (615) 610-1023
 waengineering.com

ALL DRAWINGS SHALL REMAIN THE PROPERTY OF CLEAR COURSE. THESE INSTRUMENTS OF SERVICE ARE TO BE USED SOLELY FOR THIS SPECIFIC PROJECT. CLEAR COURSE SHALL RETAIN ALL LEGAL RIGHTS TO THE USE OF THE INSTRUMENTS OF SERVICE AND SHALL RETAIN FULL PROTECTION UNDER UNITED STATES COPYRIGHT LAW.

**2ND AVENUE STREETSCAPE
 IMPROVEMENTS**

NASHVILLE, TN
 REEVES + YOUNG

Know what's below.
 Call before you dig.

REVISIONS

DATE	COMMENT
3/31/23	NDOT REVIEW COMMENTS

NDOT REVIEW
 INITIAL SUB. DATE: 03/01/23
 ISSUANCE DATE: 10/20/23



CC PROJECT #: CTS22049
 DELIVERY ZONE
 DETAIL
C633

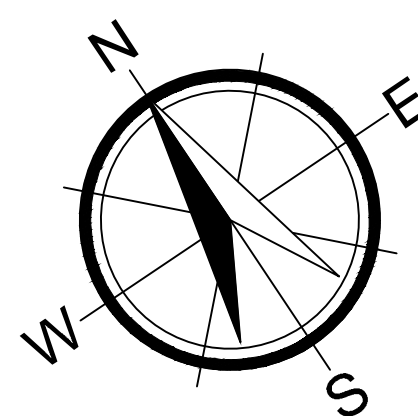

NTS 0 1/2" 1" 2"

X:\Projects\CTS2023\CTS22049-2nd Ave Streetscape - TTCP Design\Construction\Phase 2-3\DWG\CTS22049-2nd Ave Streetscape - TTCP P12&3.dwg 10-19-23 04:33:07 PM mmillins