

MEGAN BARRY
MAYOR



METROPOLITAN GOVERNMENT OF NASHVILLE AND DAVIDSON COUNTY

Metropolitan Historic Zoning Commission
Sunnyside in Sevier Park
3000 Granny White Pike
Nashville, Tennessee 37204
Telephone: (615) 862-7970
Fax: (615) 862-7974

STAFF RECOMMENDATION
1322 Sixth Avenue North
July 20, 2016

Application: New construction-appurtenances
District: Germantown Historic Preservation Zoning Overlay
Council District: 19
Map and Parcel Number: 08209005400
Applicant: Patrick Bales, Architect
Project Lead: Sean Alexander, sean.alexander@nashville.gov

<p>Description of Project: The applicant is proposing a revision to the width of the curb cut for a driveway from twelve feet (12'), as was approved by the Historic Zoning Commission in May 2016, to fourteen feet (14'). This change is based on a recommendation from the Fire Marshall.</p> <p>Recommendation Summary: Staff recommends approval of the fourteen foot (14') curb cut off of Sixth Avenue North.</p>	<p>Attachments A: Site Plan</p>
--	---

Vicinity Map:



Aerial Map:



Z:\PROJECT DATABASE\16142 - Dedecker - Germantown Bar - 6th & Taylor - Nashville TN\Plans\Engine\16142_Cover Bar_C4-1_Det_SitePlan-Layout1 Jun 14, 2016 - 11:31am.dwg

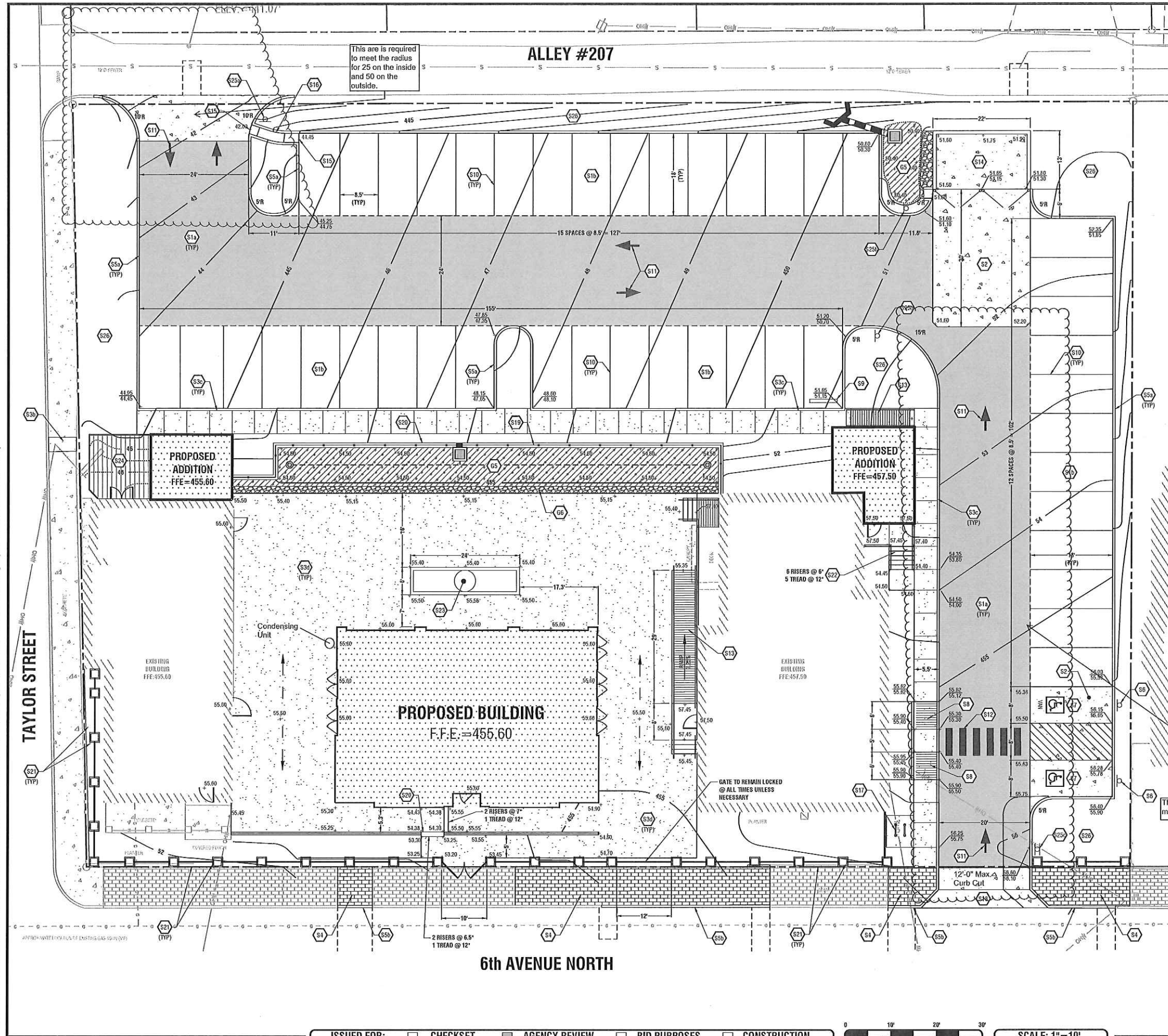

NOTES BY SYMBOL		
CODE	DESCRIPTION	DETAIL
S1A	ASPHALT PAVEMENT SECTION (HEAVY DUTY)	1/C&O
S1B	ASPHALT PAVEMENT SECTION (LIGHT DUTY)	1/C&O
S2	CONCRETE PAVEMENT SECTION	2/C&O
S3A	CONCRETE SIDEWALK	4/C&O
S3B	CONCRETE SIDEWALK (METRO)	6/C&O
S3C	CONCRETE SIDEWALK WITH TURN DOWN CURB	3/C&O
S3D	STAMPED CONCRETE	
S4	BRICK SIDEWALK (METRO) TO MATCH EXISTING	7/C&O
S5A	CONCRETE POST CURB	5/C&O
S5B	CONCRETE POST CURB (METRO)	8/C&O
S6	ADA ACCESSIBLE PARKING SIGN	2/C&I
S7	ADA ACCESSIBLE SYMBOL	1/C&I
S8	ADA ACCESSIBLE RAMP	3/C&I
S9	CONCRETE WHEEL STOP	5/C&I
S10	4" WIDE WHITE PAINTED LINE (5 MIL PAINT)	NA
S11	DIRECTIONAL ARROW	10/C&O
S12	PEDESTRIAN CROSSWALK	11/C&O
S13	CONCRETE RAMP WITH HANDRAIL	6/C&I
S14	DUMPSTER ENCLOSURE	1/C&I
S15	CONCRETE CURB CUT	10/C&I
S16	CONCRETE FLUME	7/C&I
S17	BICYCLE RACK / PAD	3/C&I
S18	COMMERCIAL DRIVEWAY RAMP	14/C&O
S19	WOODSH PRIVACY SCREEN FENCE (7' TALL)	
S20	RETAINING WALL	BY OTHERS
S21	WROUGHT IRON FENCE WITH BRICK COLUMNS	2/C&I
S22	CONCRETE STEPS WITH HANDRAIL	8/C&I
S23	FOUNTAIN	BY OTHERS
S24	WOOD DECK	BY OTHERS
S25	STOP SIGN	
S26	DO NOT ENTER SIGN	
S27	ONE WAY SIGN	
S28	LANDSCAPE AREA	

NOTES BY SYMBOL		
CODE	DESCRIPTION	DETAIL
G1	CATCH BASIN	9/C&I
G2	CONCRETE HEADWALL	11/C&I
G3	BIO-RETENTION POND	SEE LANDSCAPE PLANS
G4	STONE DIAPHRAGM	12/C&I

REVIEWED
By Melanie Hutchison at 8:49 am, Jul 07, 2016

The Fire Department will require a minimum of 14' for one-way traffic.

ISSUED FOR: CHECKSET AGENCY REVIEW BID PURPOSES CONSTRUCTION



SCALE: 1"=10'

PLANS PREPARED FOR:

GERMANTOWN BAR & RESTAURANT
6TH AND TAYLOR
NASHVILLE, TENNESSEE

PLANS PREPARED BY:

Development Management Group, LLC
4209 GALLATIN PIKE
NASHVILLE, TN 37216
TEL: (615) 227-5663

GERMANTOWN BAR & RESTAURANT
1324 6TH AVENUE NORTH
NASHVILLE, TENNESSEE

DAVID S. ABBEY
REGISTERED ENGINEER
STATE OF TENNESSEE
16

NO.	DATE	DESCRIPTION

DATE: 06-14-16
DMG Project No: 16142
DETAILED SITE LAYOUT & GRADING PLAN
C4.1