

RECEIVED  
MAY 17 2018  
GAK  
Property SERVICES

-----CAUTION-----  
THE POSITION OF THE WATER AND SANITARY  
SEWER MAINS SHOWN ARE APPROXIMATE  
AND ARE INTENDED TO SHOW THE GENERAL  
LOCATION ONLY. THE SIZES NOTED ARE TO  
THE BEST OF MWS KNOWLEDGE. IN ALL  
CASES WHERE PRECISE LOCATION AND MAIN  
SIZES ARE REQUIRED, FIELD VERIFICATION  
WILL BE NECESSARY.

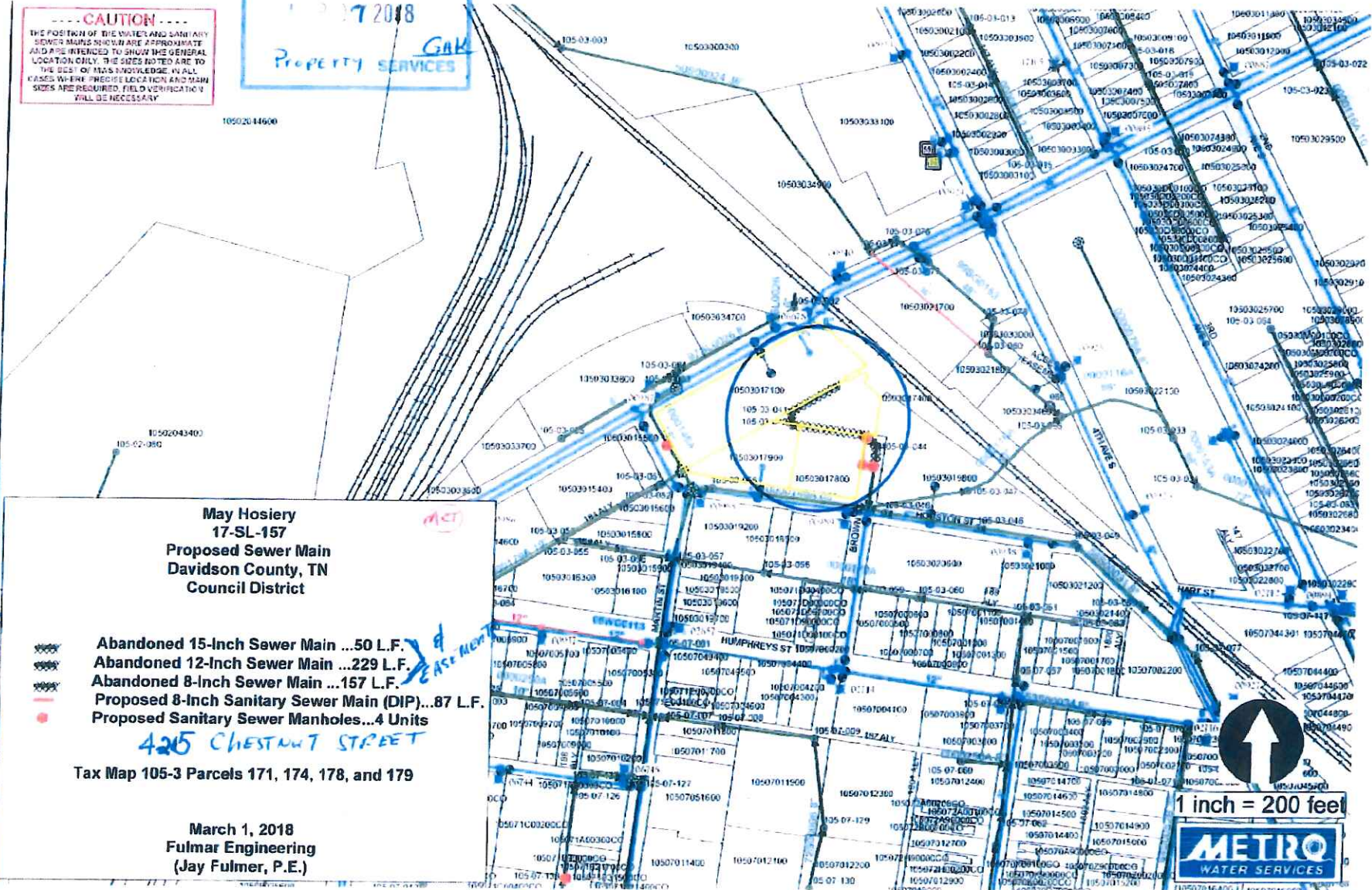

May Hosiers  
17-SL-157  
Proposed Sewer Main  
Davidson County, TN  
Council District

Abandoned 15-Inch Sewer Main ...50 L.F.  
Abandoned 12-Inch Sewer Main ...229 L.F.  
Abandoned 8-Inch Sewer Main ...157 L.F.  
Proposed 8-Inch Sanitary Sewer Main (DIP)...87 L.F.  
Proposed Sanitary Sewer Manholes...4 Units  
**425 CHESTNUT STREET**

Tax Map 105-3 Parcels 171, 174, 178, and 179

March 1, 2018  
Fulmar Engineering  
(Jay Fulmer, P.E.)

1 inch = 200 feet  
**METRO**  
WATER SERVICES