



Wharfi Park
Nashville, Tennessee

Nashville's Next Great Park



DOWNTOWN
NASHVILLE

ROLLING MILL
HILL

WHARF
PARK

SILLIMAN EVANS BRIDGE

I-24

Community Events!

FOUR WAYS TO ENGAGE

JANUARY 19 - 5:30 - 7:30 PM
MIDTOWN HILLS POLICE PRECINCT
1441 12TH AVE S

JANUARY 20 - 11:30 - 1:00 PM
NASHVILLE CIVIC DESIGN CENTER
[WWW.CIVICDESIGNCENTER.ORG/
ALL-EVENTS/WHARF-PARK](http://WWW.CIVICDESIGNCENTER.ORG/ALL-EVENTS/WHARF-PARK)

JANUARY 21 - 12:00 - 1:00 PM
WHARF PARK MASTER PLAN
FACEBOOK LIVE
FACEBOOK.COM/METRONASHVILLEPARKS

JANUARY 22 - 12:00 - 2:00 PM
NAPIER COMMUNITY CENTER
73 FAIRFIELD AVE

Wharf Park

community meeting #2!

THREE OPPORTUNITIES TO ENGAGE

JANUARY 19 - 5:30 - 7:30 PM
MIDTOWN HILLS POLICE PRECINCT
1441 12TH AVE S

JANUARY 21 - 12:00 - 1:00 PM
WHARF PARK MASTER PLAN
FACEBOOK LIVE
FACEBOOK.COM/METRONASHVILLEPARKS

JANUARY 22 - 12:00 - 2:00 PM
NAPIER COMMUNITY CENTER
73 FAIRFIELD AVE



Meet the Team

Agency Landscape + Planning

Brie Hensold
Principal Planner

Gina Ford
Landscape Principal

Susannah Ross
Project Manager

Kymberly Ware
Landscape Designer

HDLA

Richie Jones
Principal LA

Robert Waits
Project Manager

Luis Venegas
Landscape Designer

John Gore
Civil Engineer

Barge Cauthen

Chris Fleming
Environmental

BDY Environmental

Engagement Specialists

Zaragunda Programming

McNeely Brockman PR

Moffatt & Nichol

Mike Herrman
Marine Engineer

Mark Pirrello
Marine Engineer

Advisors

Hastings Architecture

Wilmot Sustainability

Connico Cost Estimating

**Metro Board
of Parks and
Recreation**

Metropolitan Government of Nashville and Davidson County

2020
FEB | MAR | APR |
2021
MAY | JUNE | JULY | AUG | SEPT | OCT | NOV | DEC |
2022
JAN | FEB | MAR | APR | MAY

Discover
Site Analysis and Data Collection

Focused Discussions
Connect with Key Focus Groups

Design
Programmatic Planning

Refine
Plan Development

1

2

3

4

COVID-19 PAUSE

WE ARE HERE!

COMMUNITY WORKSHOP #1
GATHER IDEAS

COMMUNITY WORKSHOP #2
DESIGN OPTIONS

COMMUNITY WORKSHOP #3
PLAN REVEAL





RIVER ACCESS



QUARRY



FLOODPLAIN FOREST



RAILWAY + BLUFF

Make It Your ...

Own!



River



Park



Greenway

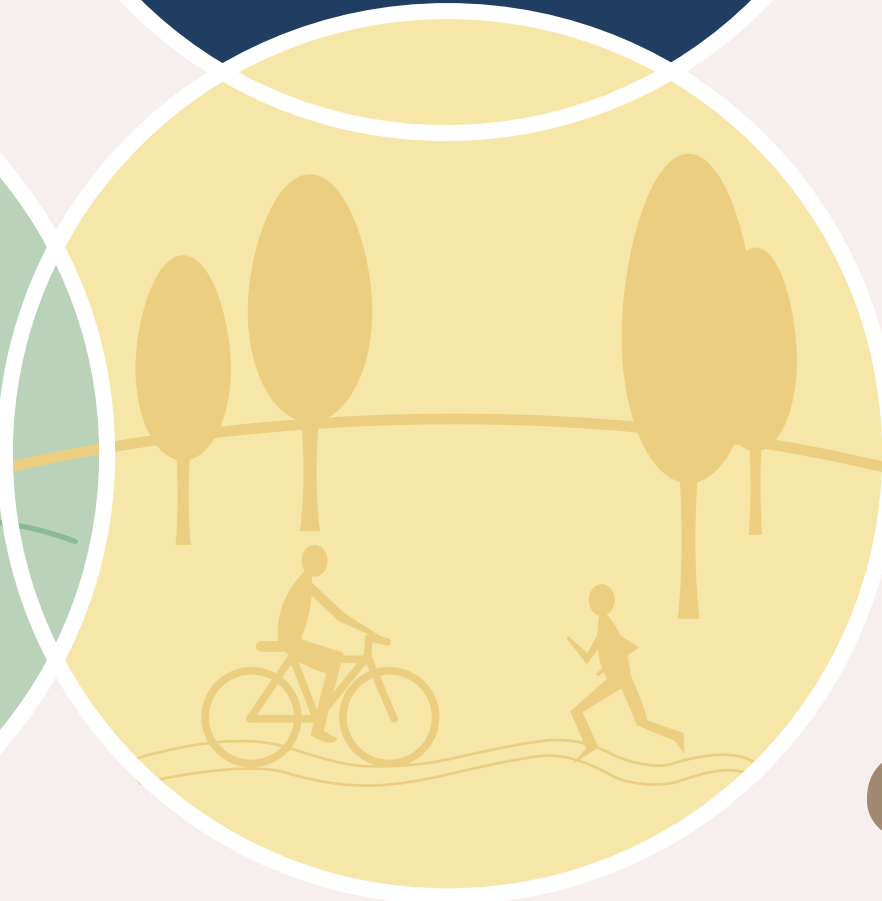

Make It Your Own

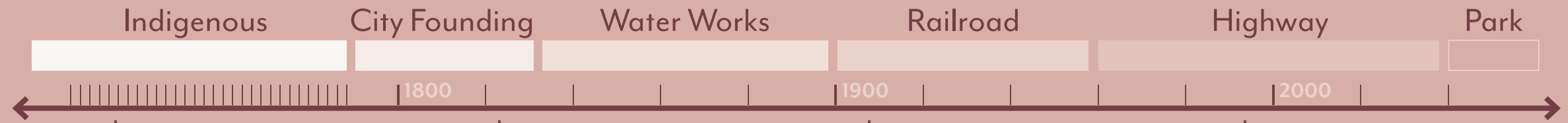

Early People
Topography and
the River



A Place of Utility
Water Works



A Place of Connection
Tennessee Central
Railroad



A Divided Place
The Interstate



A Unique Geology
Bluff and Floodplain



A Place of Fortification
Civil War Battery

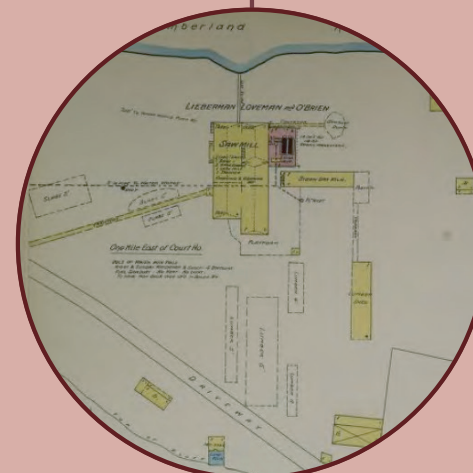

A Working Place
Saw Mills on the River



A Transitioning Place
Planning for a Park

Make It Your River

Water Systems



Adjacent Riverside Commercial Use



Adjacent Riverside Recreational Use

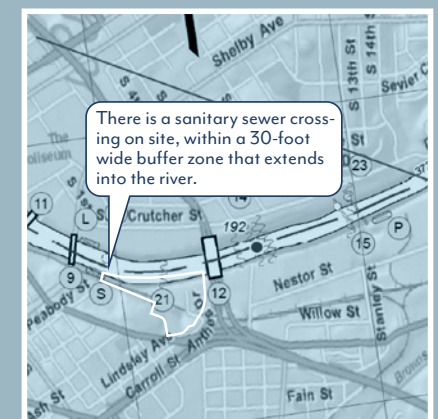
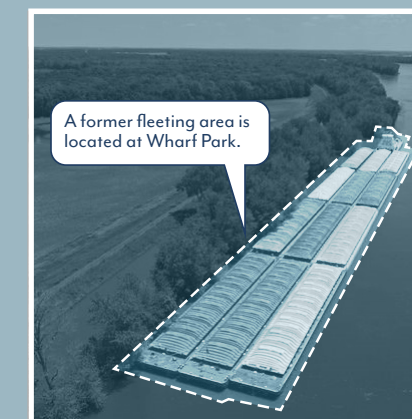
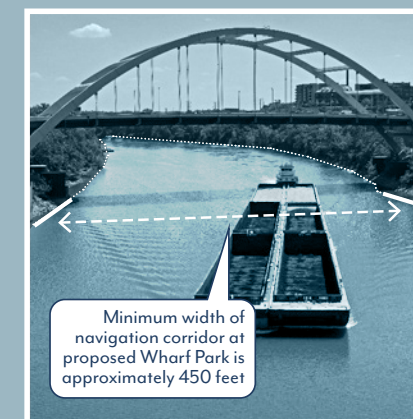
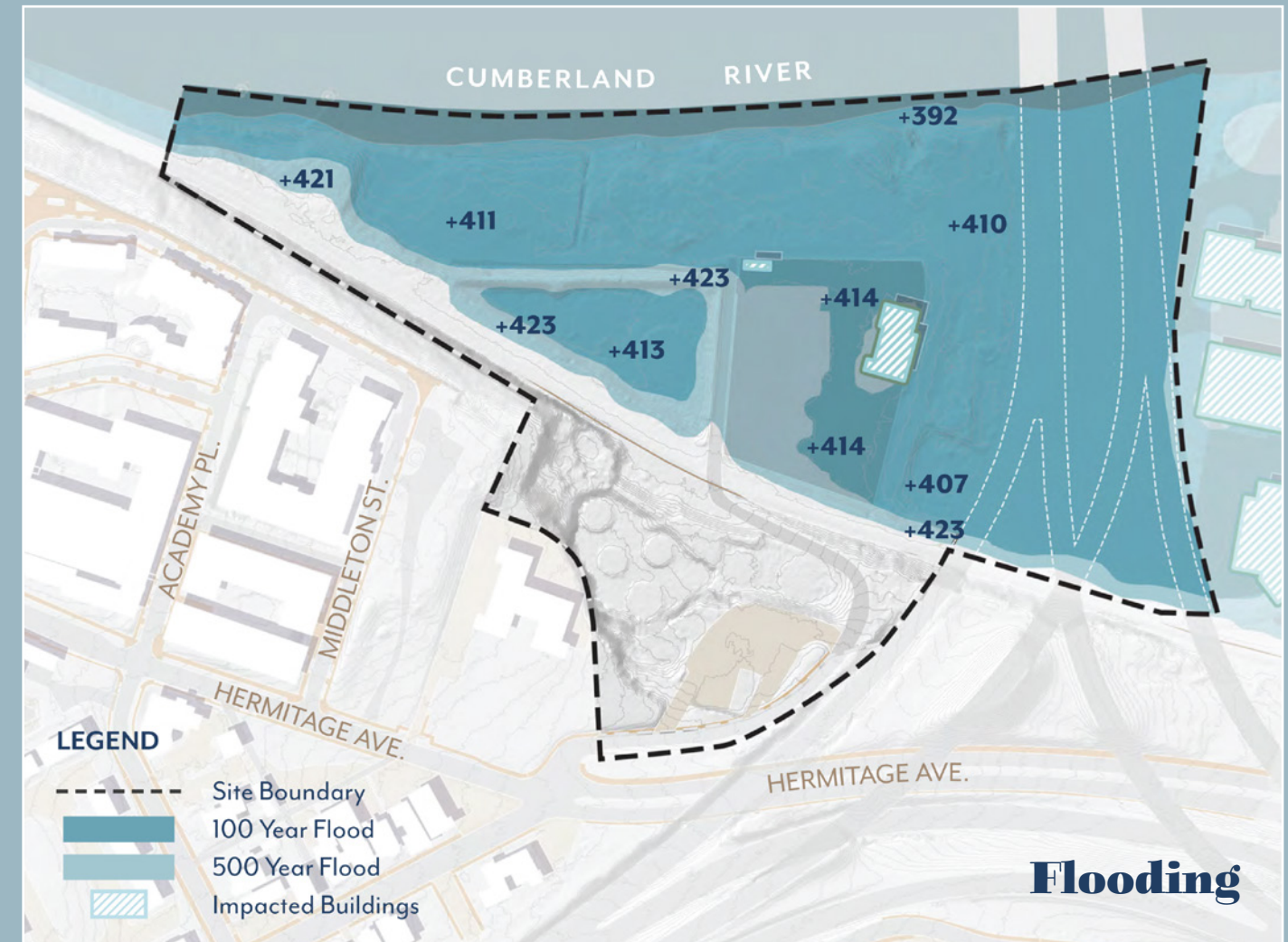

Make It Your Park

Neighborhood Character

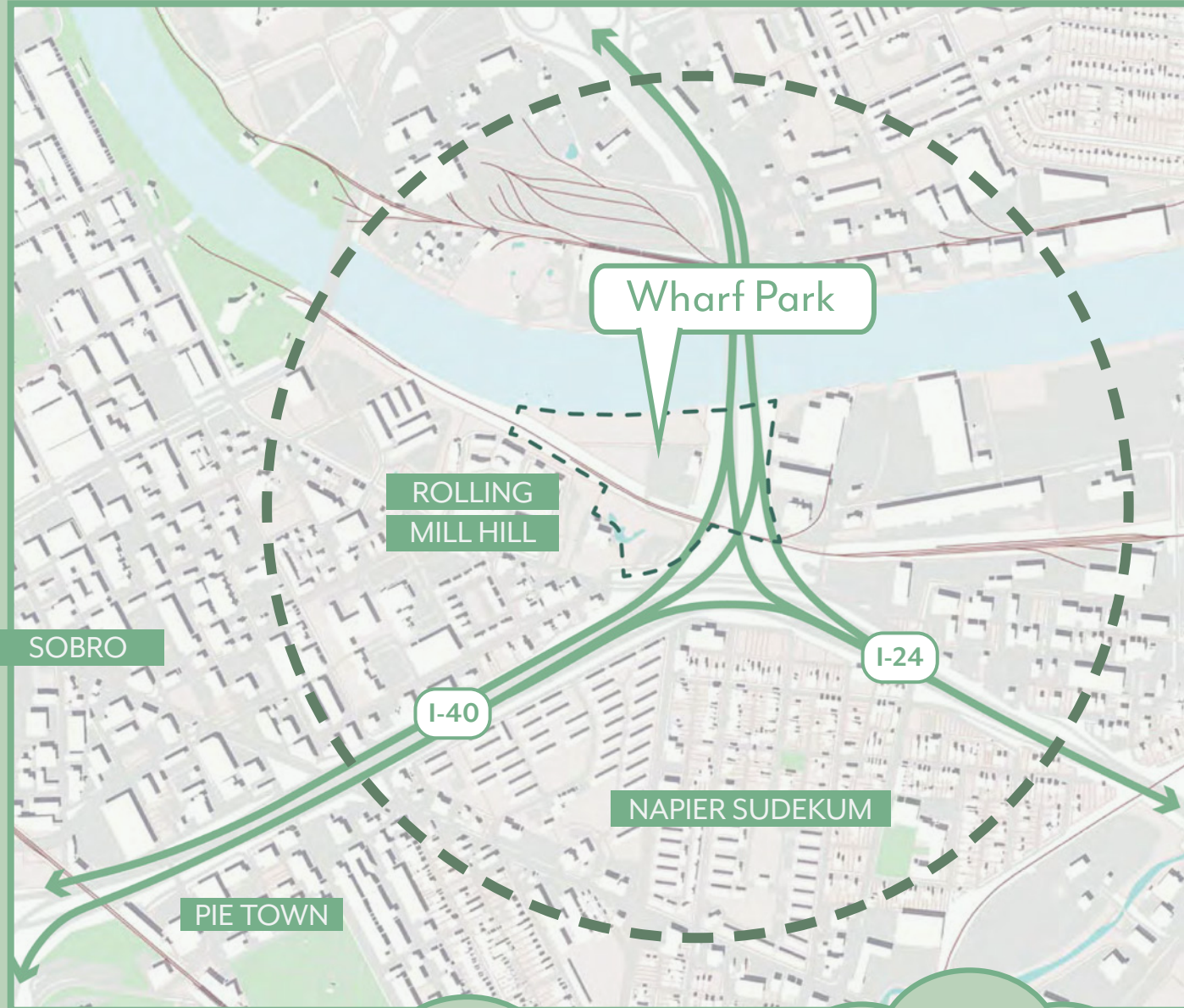

NAPIER



ROLLING MILL HILL



school partnerships

- infrastructure reuse
- after work/parks after dark
- recycling
- evidence-based programs

- more group activities
- events

- drones
- gender equity

National Park Trends & Programming



Make It Your Greenway



Foot



Bike



Bus



Car





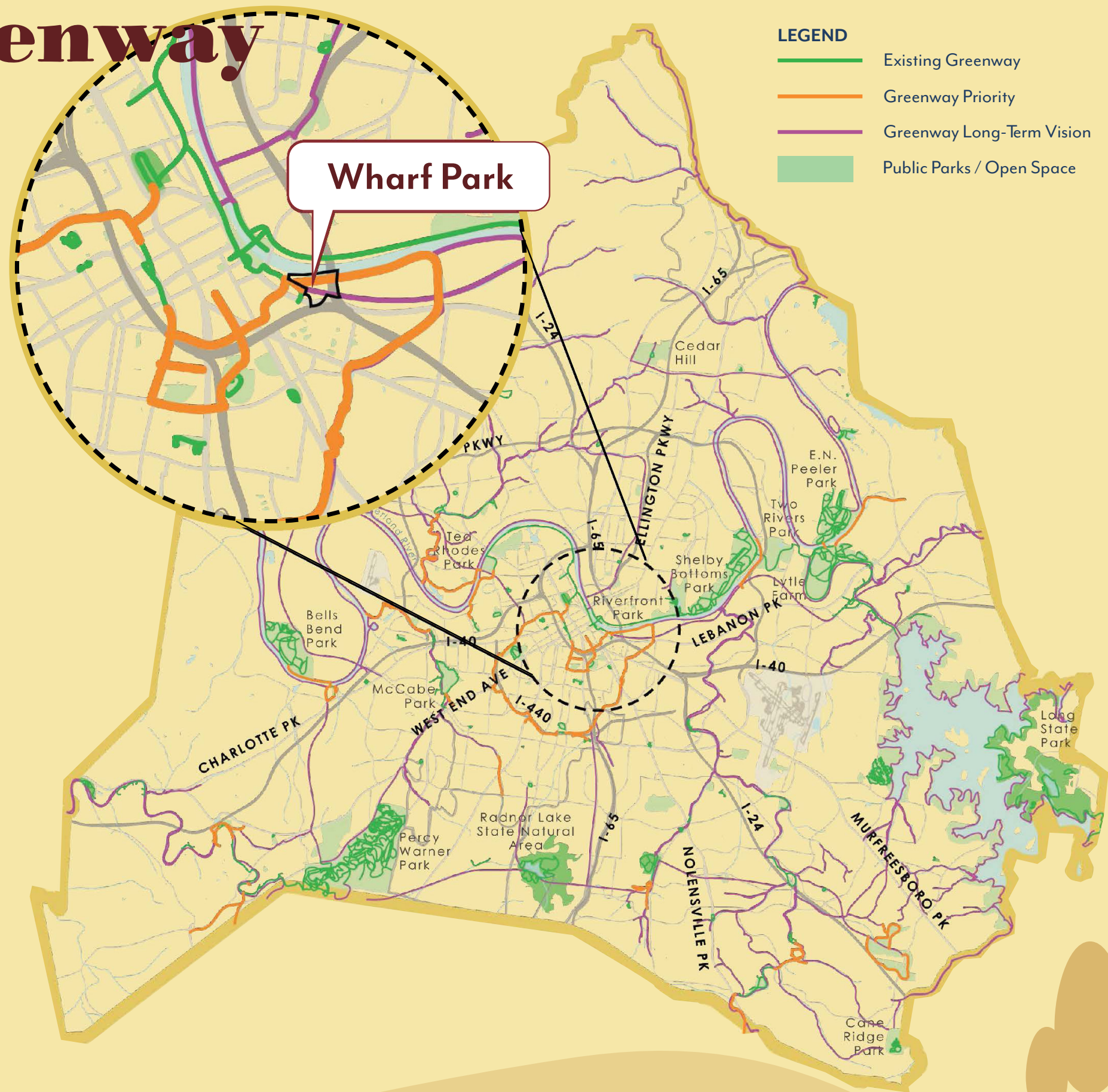

Rail

Transit Access



LEGEND

-  Existing Greenway
-  Greenway Priority
-  Greenway Long-Term Vision
-  Public Parks / Open Space

Community Outreach

08.03.2021 - 08.04.2021

Our first round of community engagement was a success!

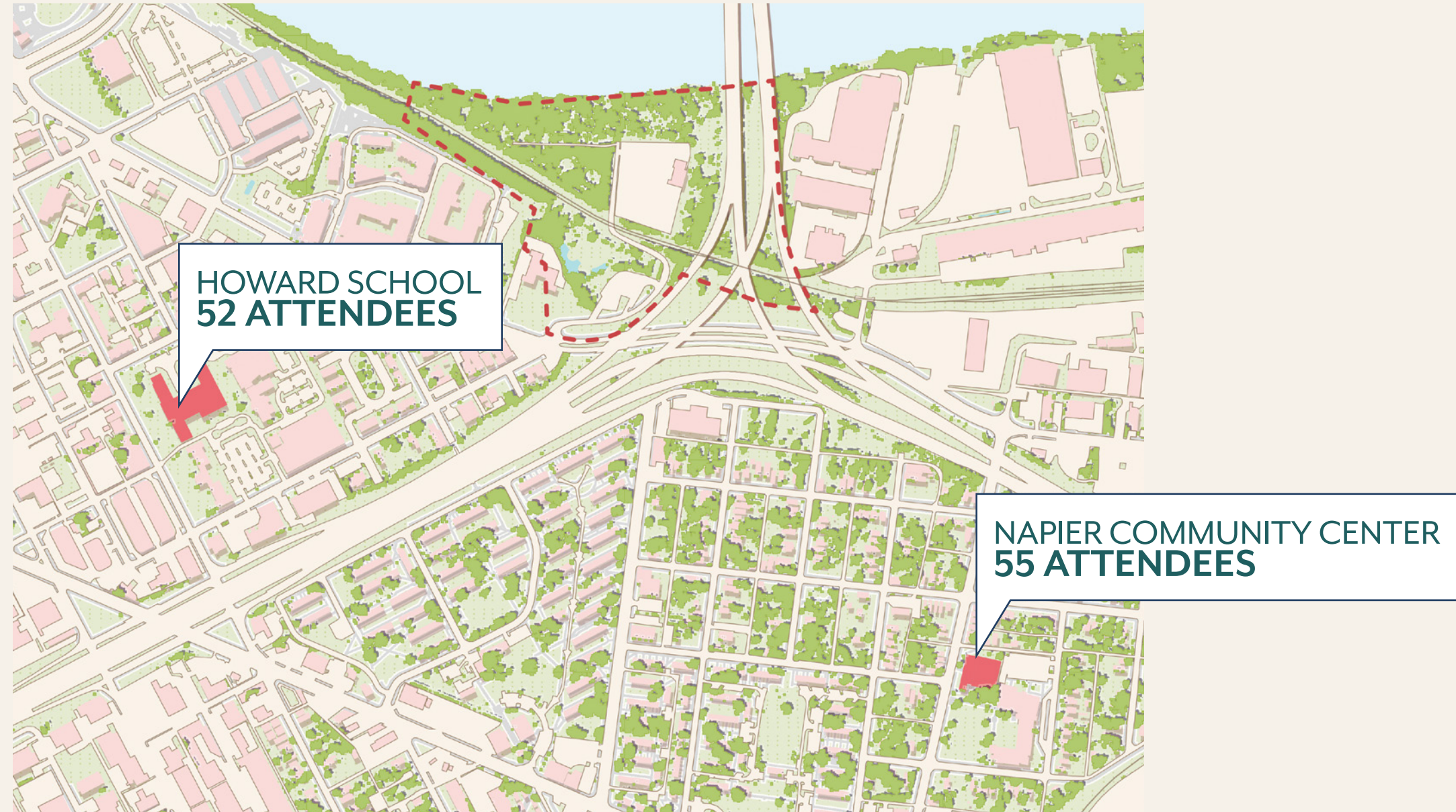

We hosted two sessions in two local neighborhoods

Community Outreach

08.03.2021 - 08.04.2021



2 ENGAGEMENT
EVENTS

107 TOTAL
ATTENDEES

400+ COMMENTS
RECORDED!

Community Outreach

Key Groups

While we received feedback and ideas from a diverse group of attendees, there are two community groups whose comments are represented the most...



Open Table Nashville

Open Table is a Nashville non-profit focused on homeless outreach, education, and advocacy. They are concerned that Wharf Park's development will add to a pattern of displacement and unhoused community trauma.

50+ COMMENTS RECORDED

Nashville Rowing Club

Nashville Rowing is a non-profit organization fostering water recreation and competition opportunities for amateur athletes. The club has some concerns about water safety but is generally excited by the prospect of water access and a potential rowing center at Wharf Park.

30+ COMMENTS RECORDED

Feedback Summary

Identity

Safe place for rowing, both from boat traffic on water

The best backyard!

Comments centered youth recreation, future access, and concerns about the social welfare of the current unhoused residents on site

Center for the youth after school and in the summer

Green! Healthy canopy, bio-diverse

River



Dedicated space for paddle watercraft, water safety and passive river viewing were important and recurring themes



Park



In addition to water access, skate parks and nature programming, attendees highlighted needs for facilities, 24 hour access, and water safety



Greenway

Attendees emphasized the need to connect to local neighborhoods through multimodal transportation and programming partnerships/

Bike shares

How will Wharf Park benefit/become accessible for the Napier Community?

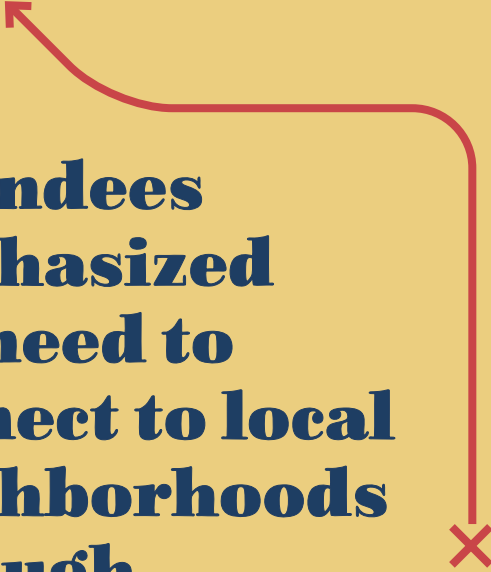

Model

As a space for more free-form discussion, the model served as a means for showcasing site topography and context...



...we asked attendees to share what they saw as opportunities and/or what they had concerns about. Conversations encompassed all four themes

Model

Areas of concern centered largely around issue of accessibility, safety, tourism identity, and displacement of unhoused and low income communities.



22 AREAS OF CONCERN

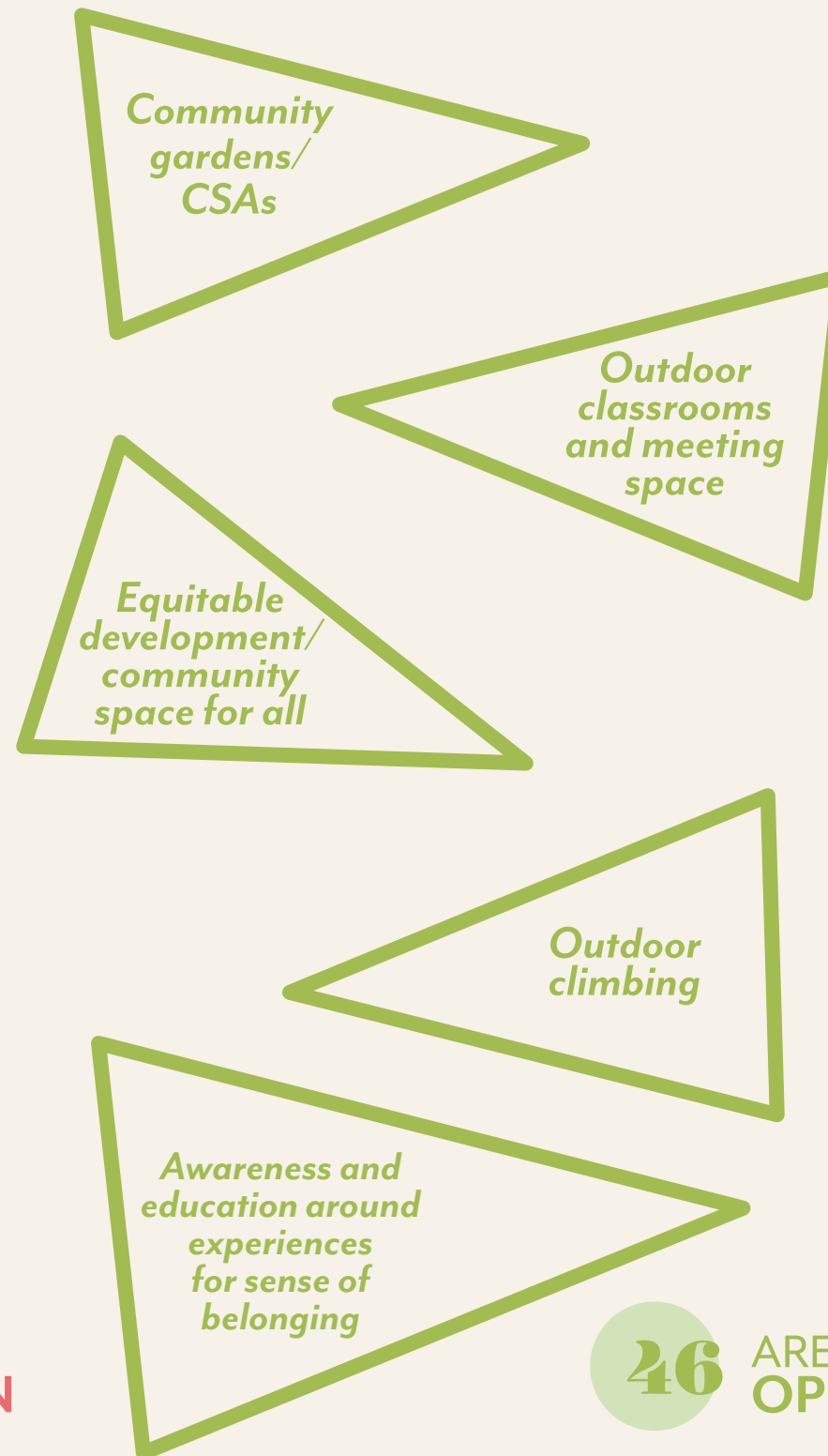

46 AREAS OF OPPORTUNITY

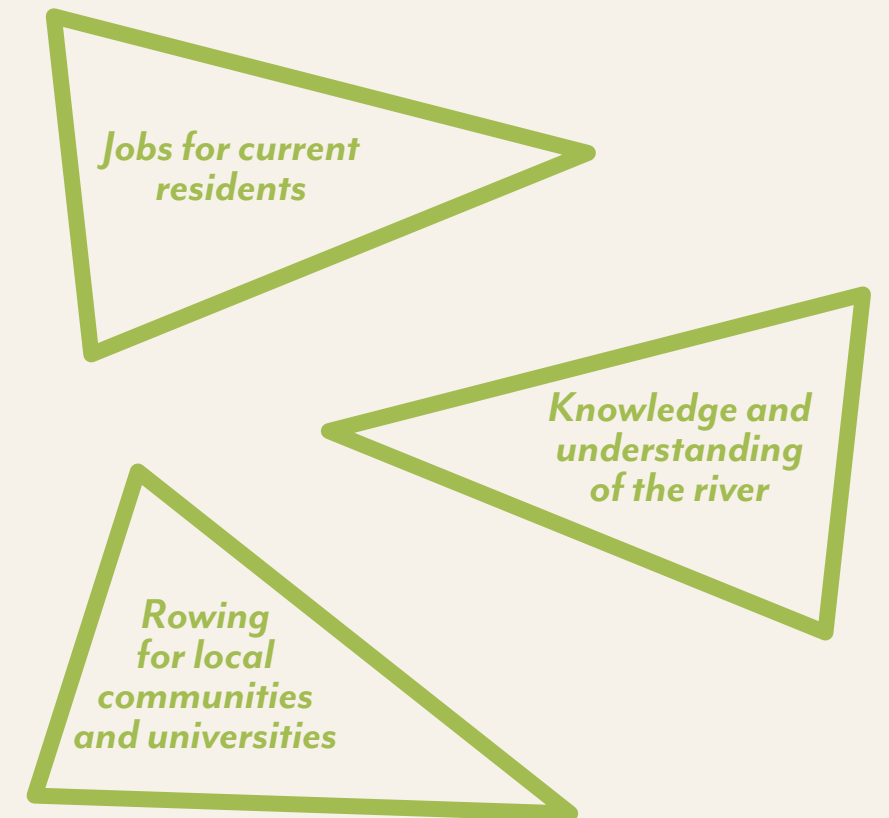

People saw opportunities in the potential for rowing/water access, nature recreation, connection to the neighborhood, and potential for community organization partnerships.

Three Design Approaches

River Forest



Bridge + Bowl



Wetland Braid



River Forest

C U M B E R L A N D R I V E R

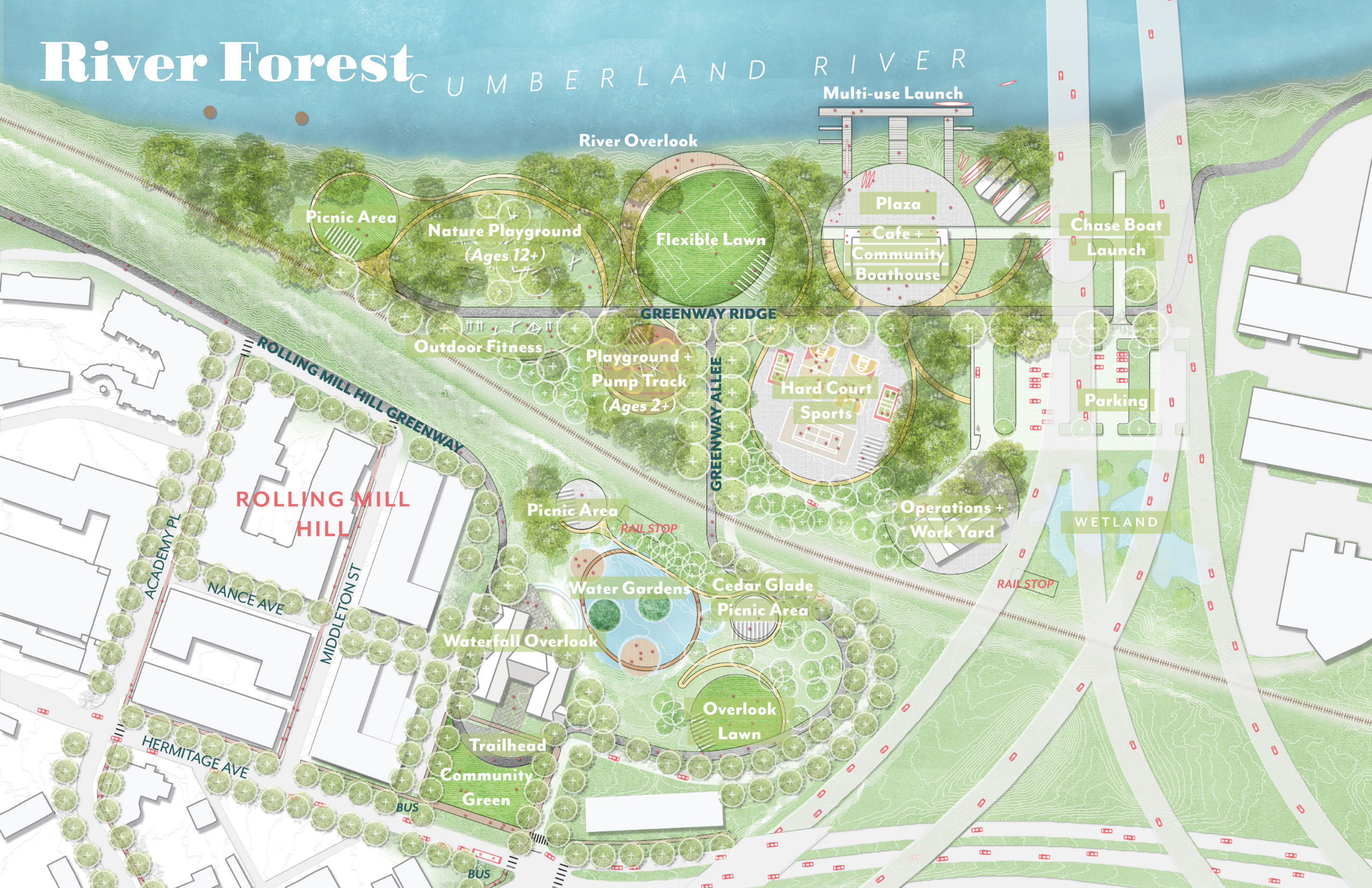

River Overlook

Multi-use Launch

Picnic Area

Nature Playground
(Ages 12+)

Flexible Lawn

Plaza

Cafe +
Community
Boathouse

Chase Boat
Launch

GREENWAY RIDGE

Outdoor Fitness

Playground +
Pump Track
(Ages 2+)

Hard Court
Sports

Parking

ROLLING MILL
HILL

Picnic Area

RAIL STOP

Operations +
Work Yard

WETLAND

ACADEMY PL

NANCE AVE

MIDDLETON ST

Water Gardens

Cedar Glade
Picnic Area

RAIL STOP

Waterfall Overlook

Overlook
Lawn

HERMITAGE AVE

Trailhead

Community
Green

BUS

BUS

River Forest

River Forest celebrates the legacy of the site. Special places take advantage of remnant industrial traces. Preservation and enhancement of the existing forest as a rare urban amenity and critical ecology is prioritized.

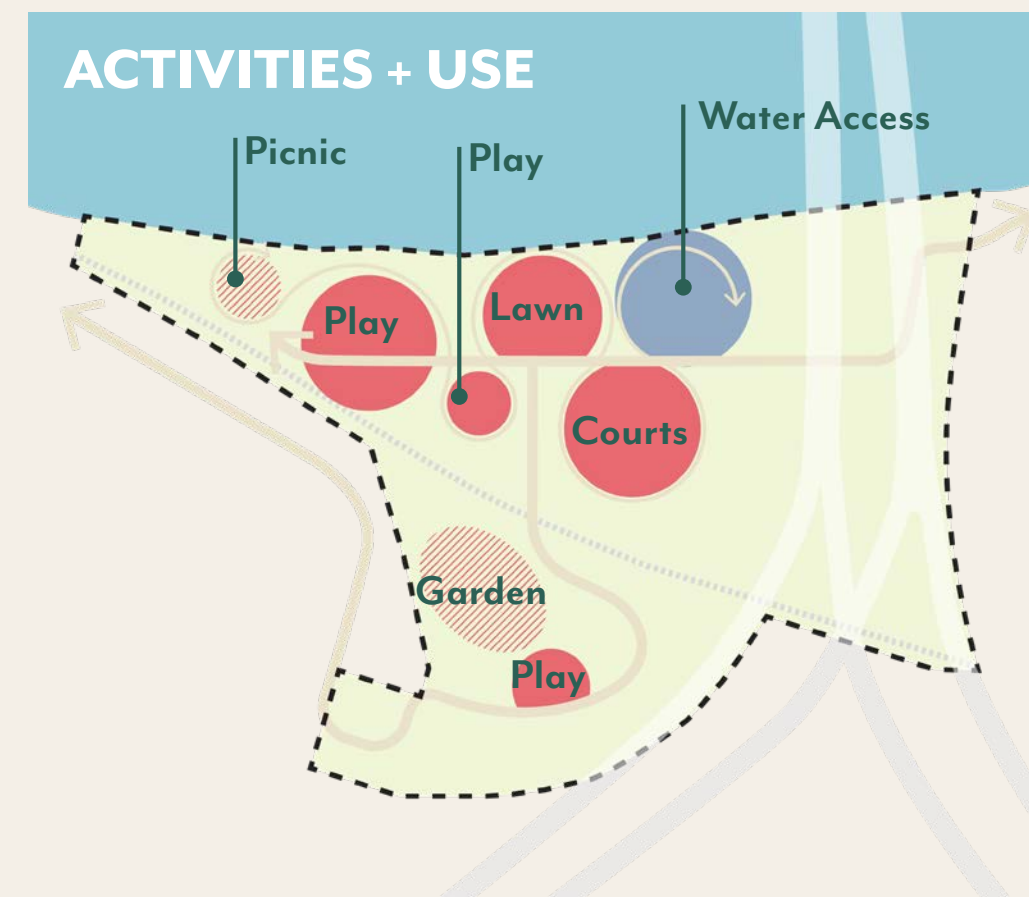
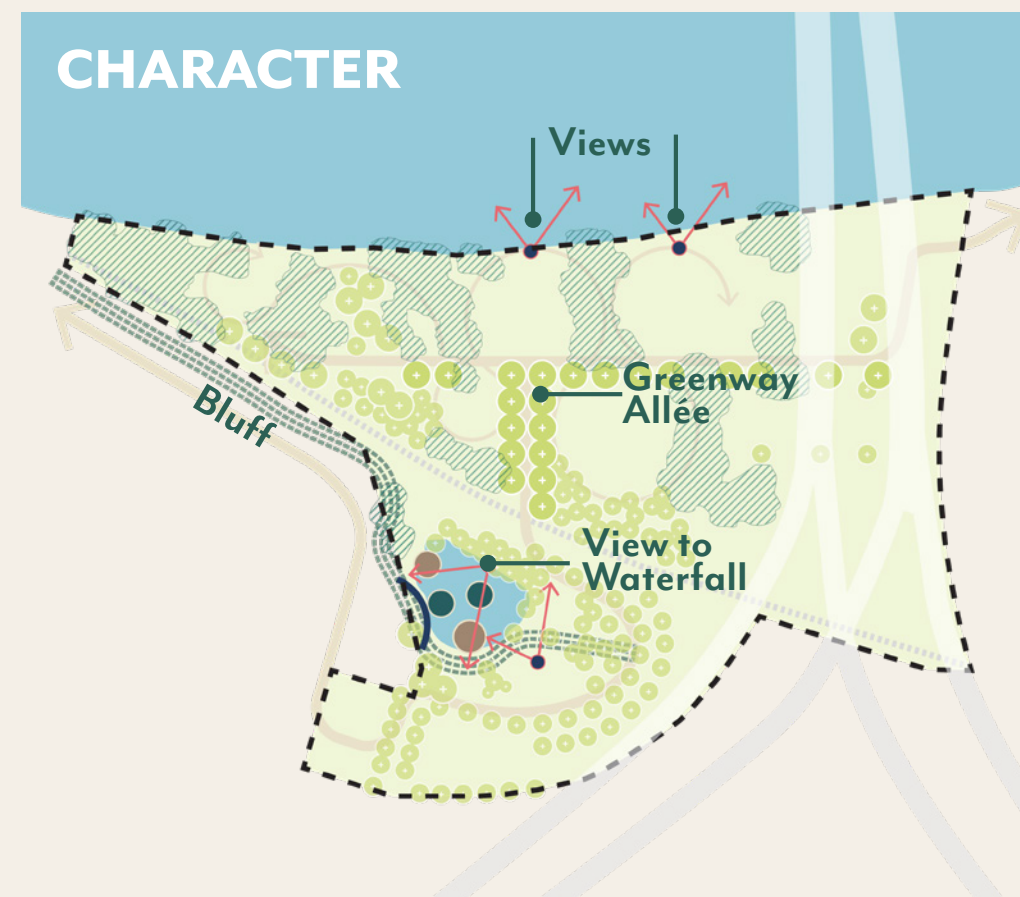
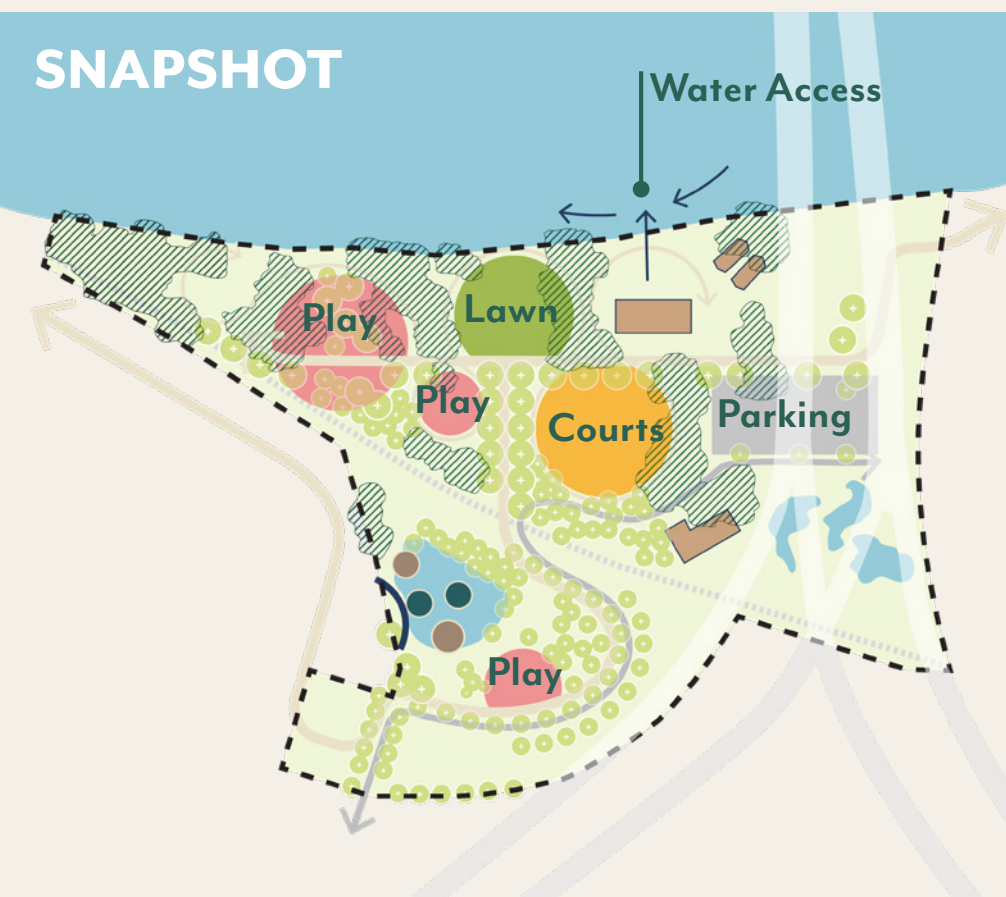
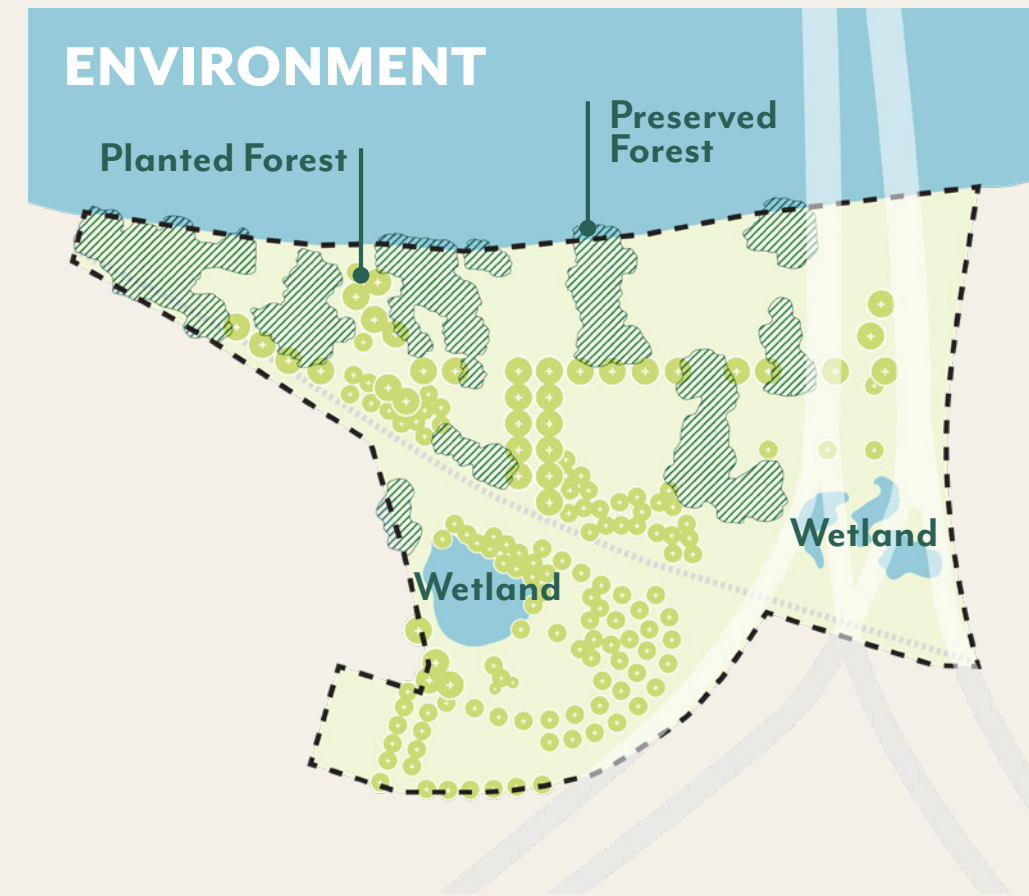
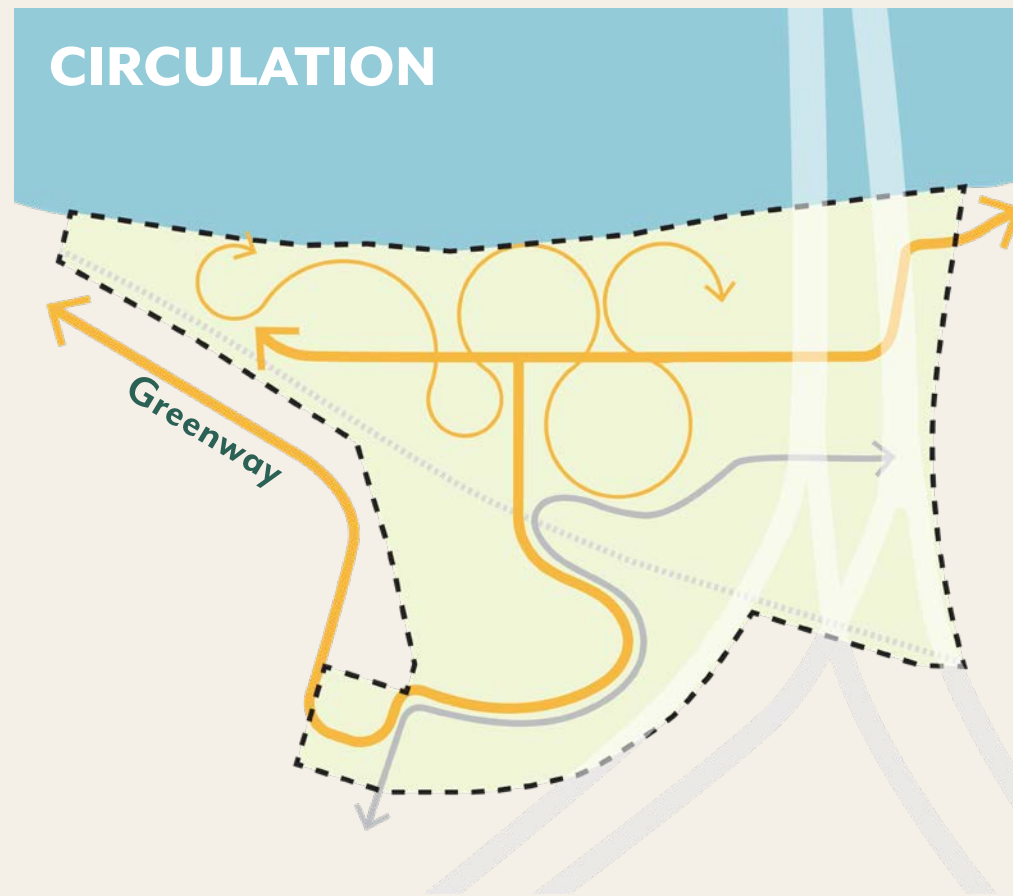

“Preserve historic African American School for the Blind”

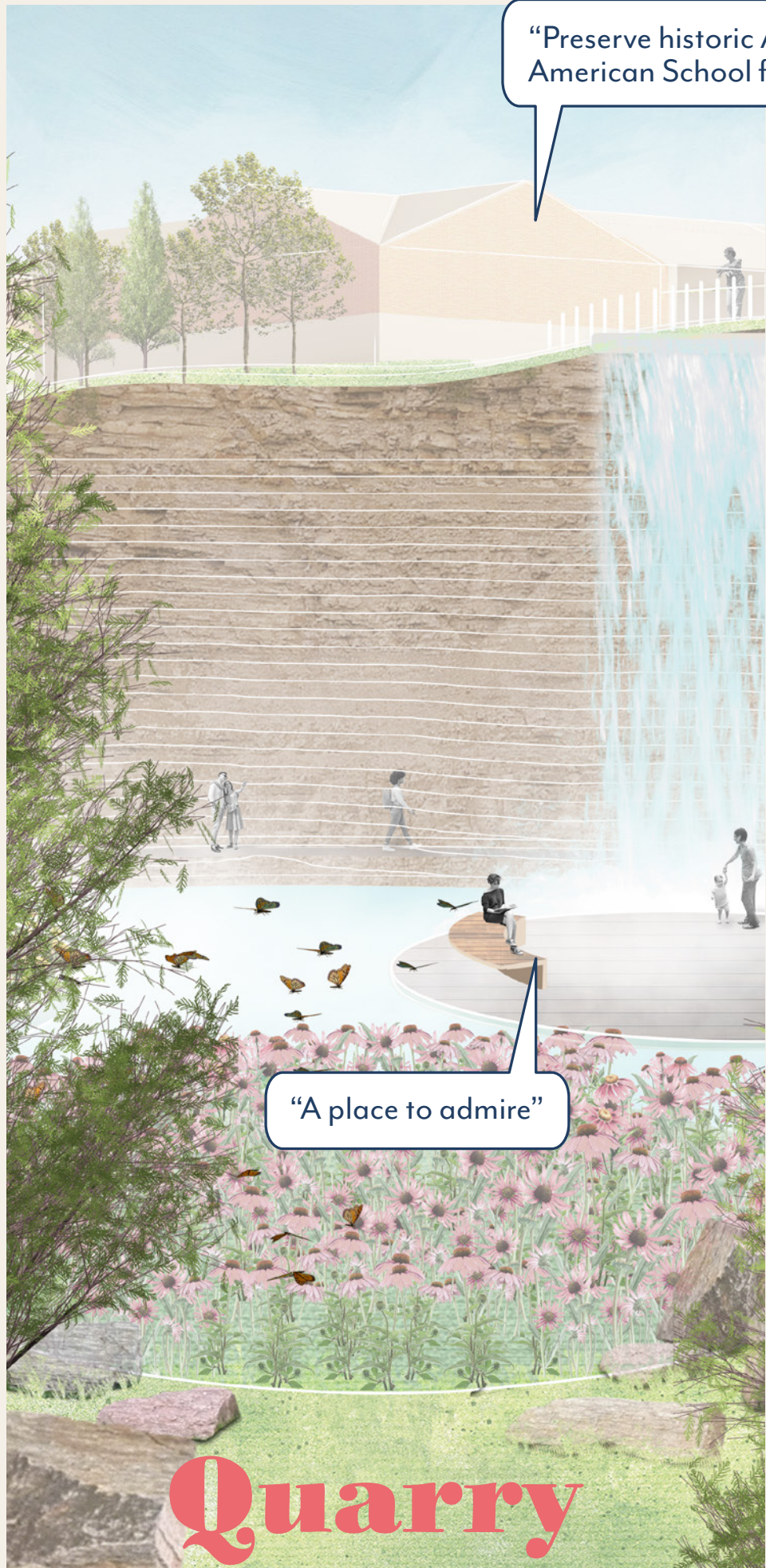

“A place to admire”

Quarry

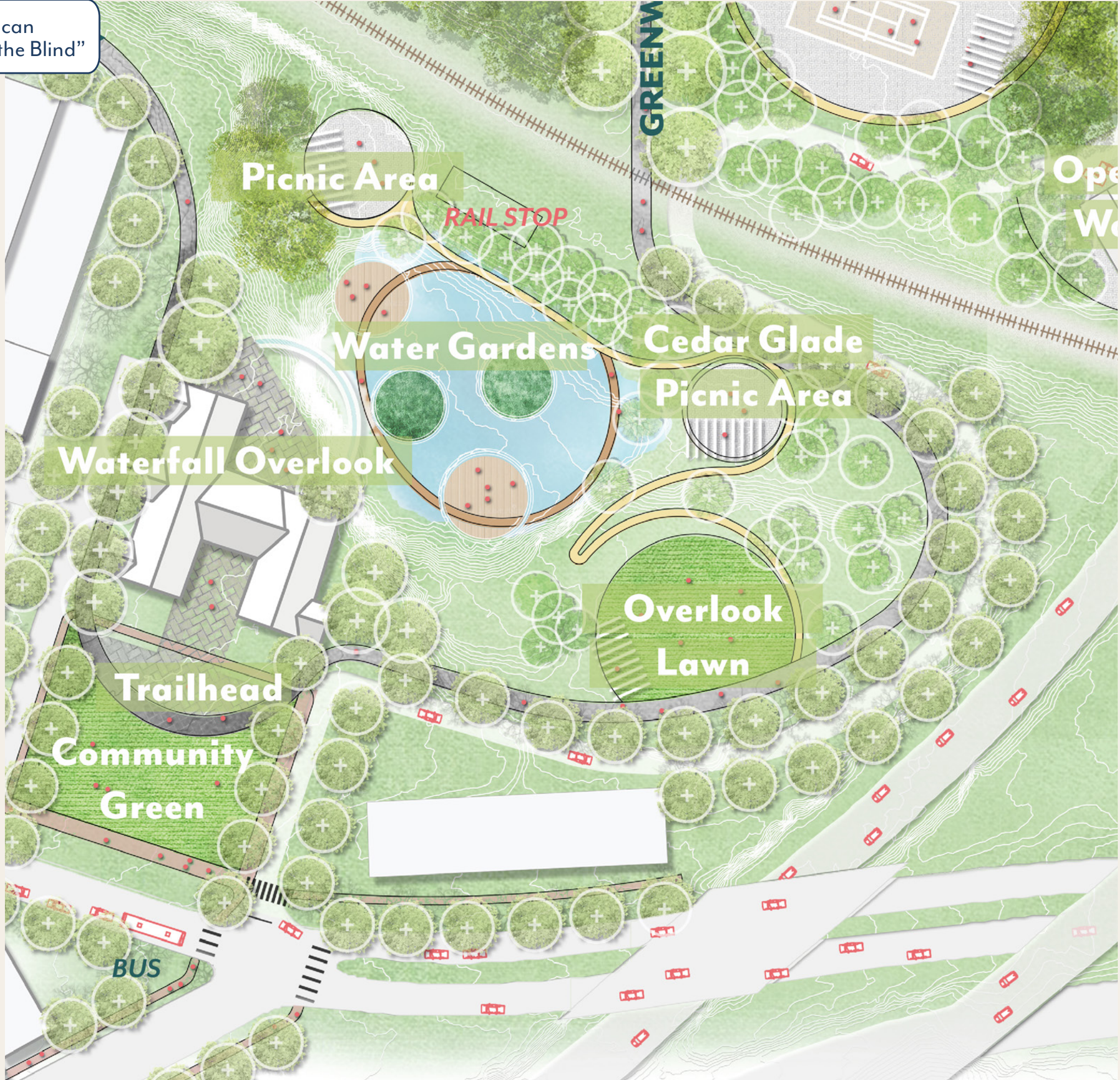



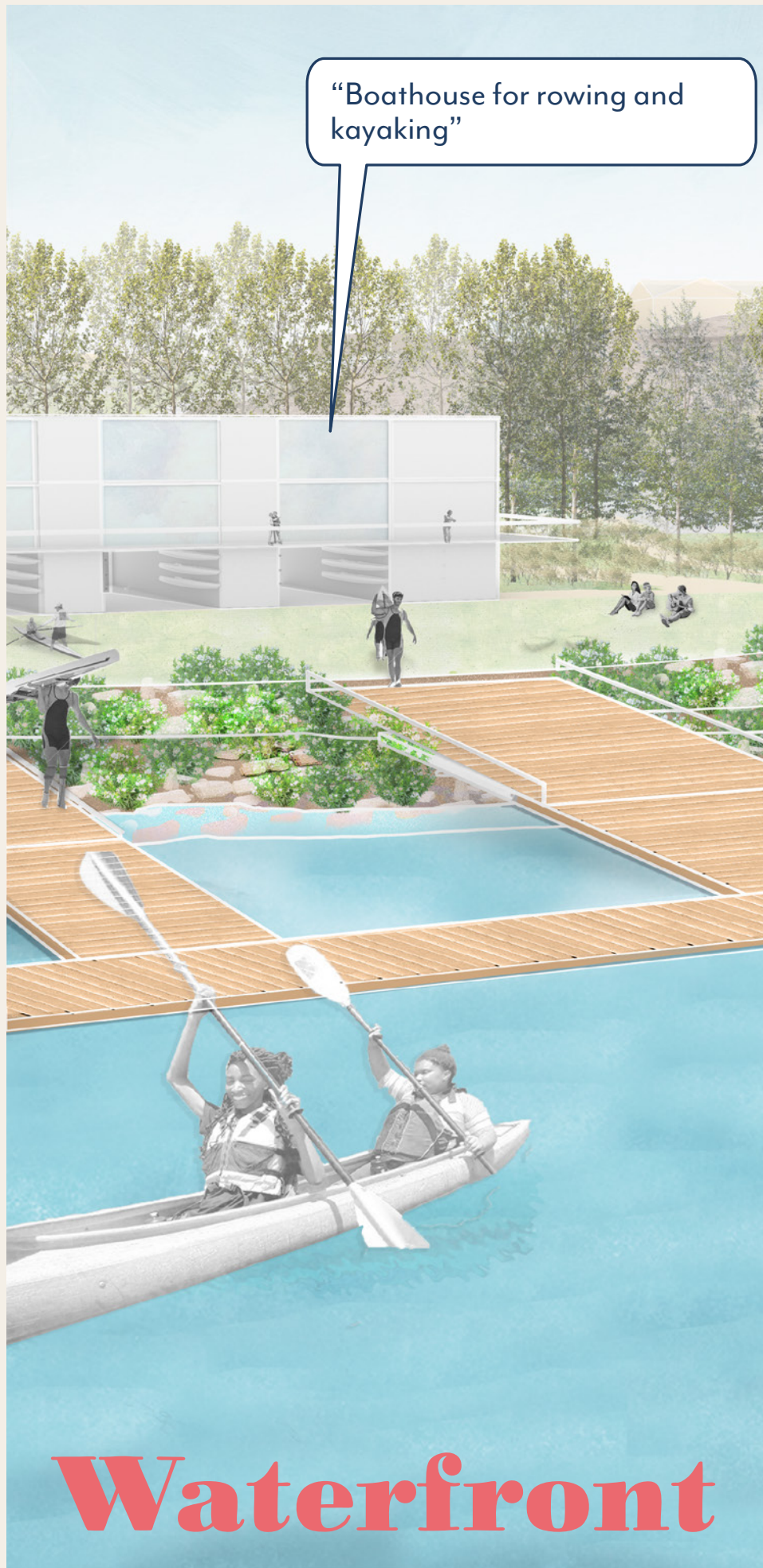

River Forest

Design Character: Industrial Nature

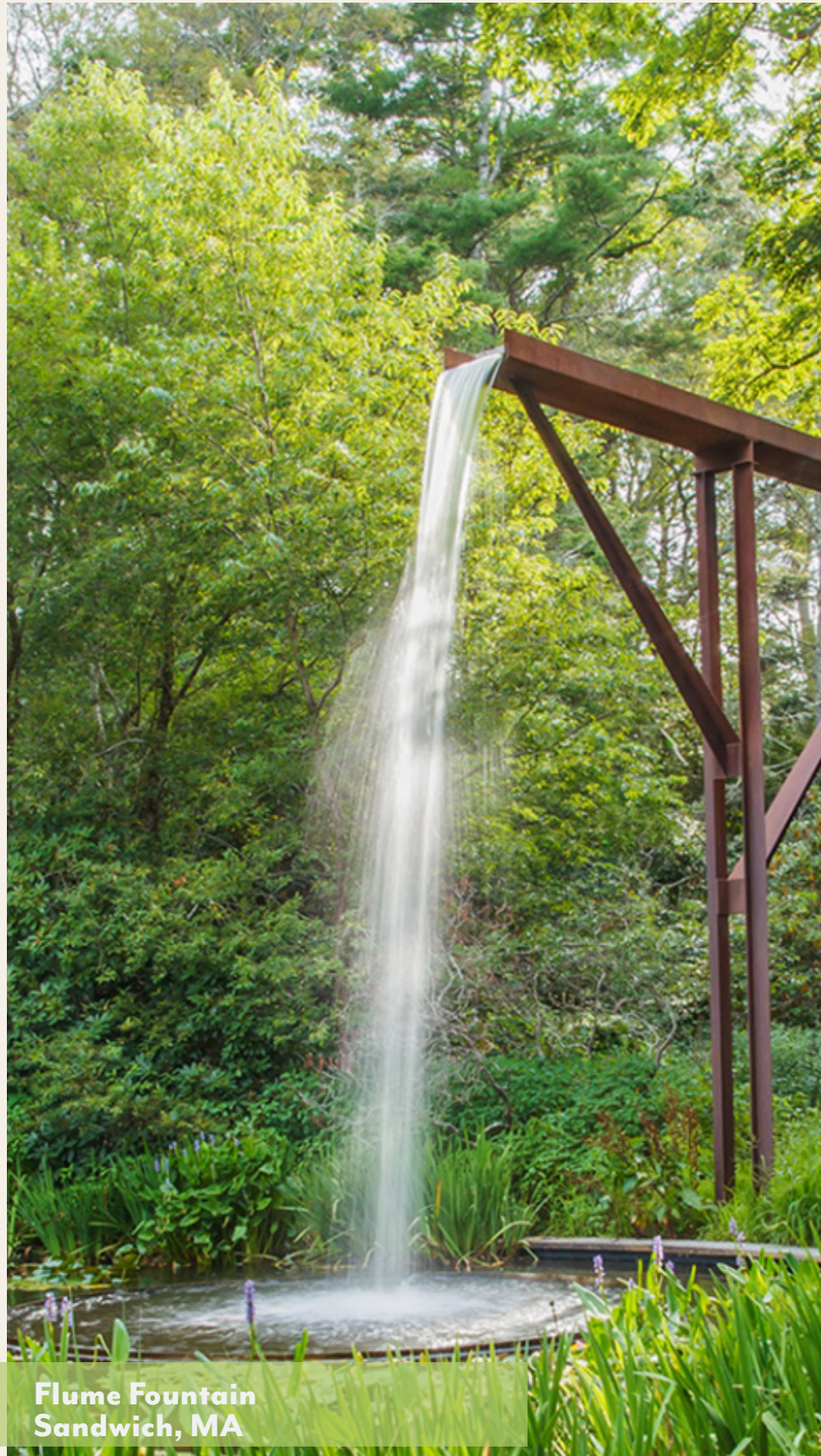

Flume Fountain
Sandwich, MA



Headington School Boat Club
Oxford, UK



Hoyt Sullivan Park
Somerville, MA

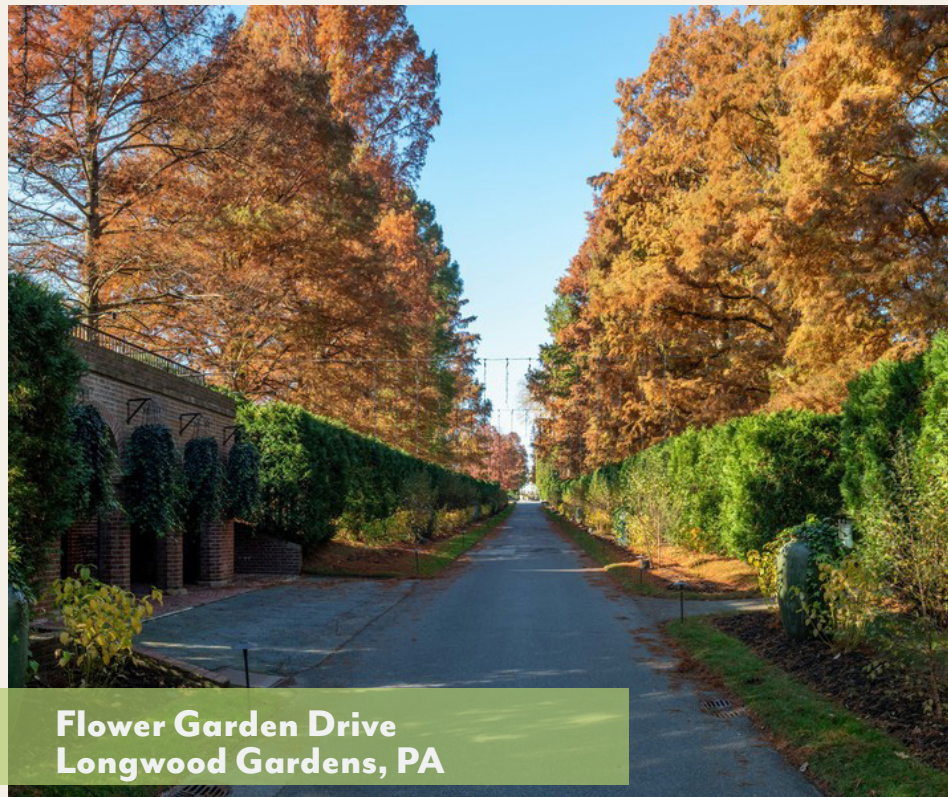

Flower Garden Drive
Longwood Gardens, PA



Hoshinoya Fuji
Japan

Bridge + Bowl CUMBERLAND RIVER

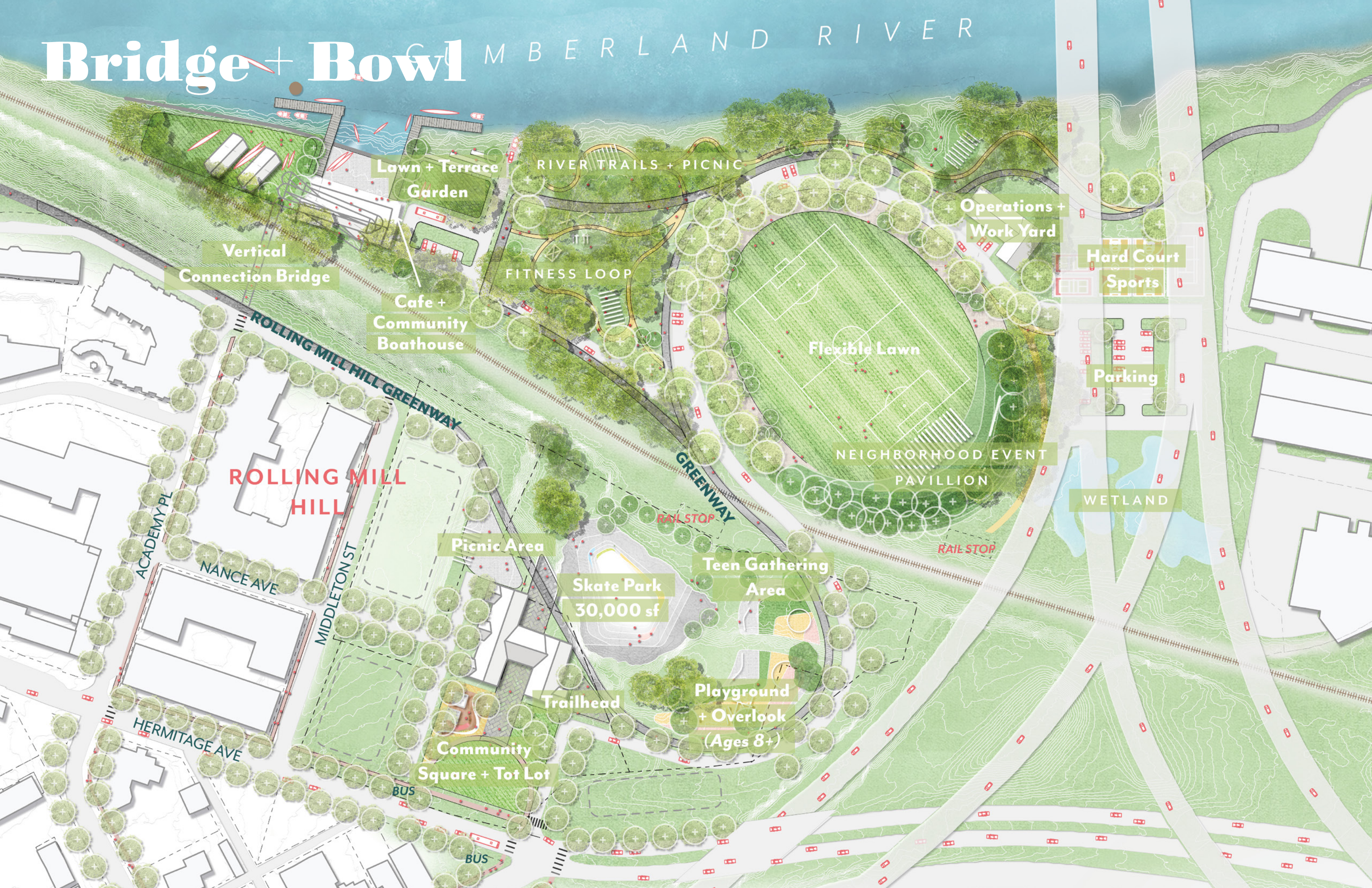

Vertical Connection Bridge

Lawn + Terrace
Garden

RIVER TRAILS + PICNIC

FITNESS LOOP

Cafe +
Community
Boathouse

Operations +
Work Yard

Hard Court
Sports

Flexible Lawn

Parking

ROLLING MILL
HILL

NEIGHBORHOOD EVENT
PAVILLION

WETLAND

Picnic Area

Skate Park
30,000 sf

Teen Gathering
Area

Trailhead

Playground
+ Overlook
(Ages 8+)

Community
Square + Tot Lot

ACADEMY PL

NANCE AVE

MIDDLETON ST

HERMITAGE AVE

BUS

BUS

RAIL STOP

RAIL STOP

Bridge + Bowl

This design option creates a neighborhood icon with three major community hubs: the Rowing Facility, the Quarry Park and the Bowl. These special gathering places are at points of key neighborhood connections. The bridge crossing the bluff creates an iconic connection and overlook.

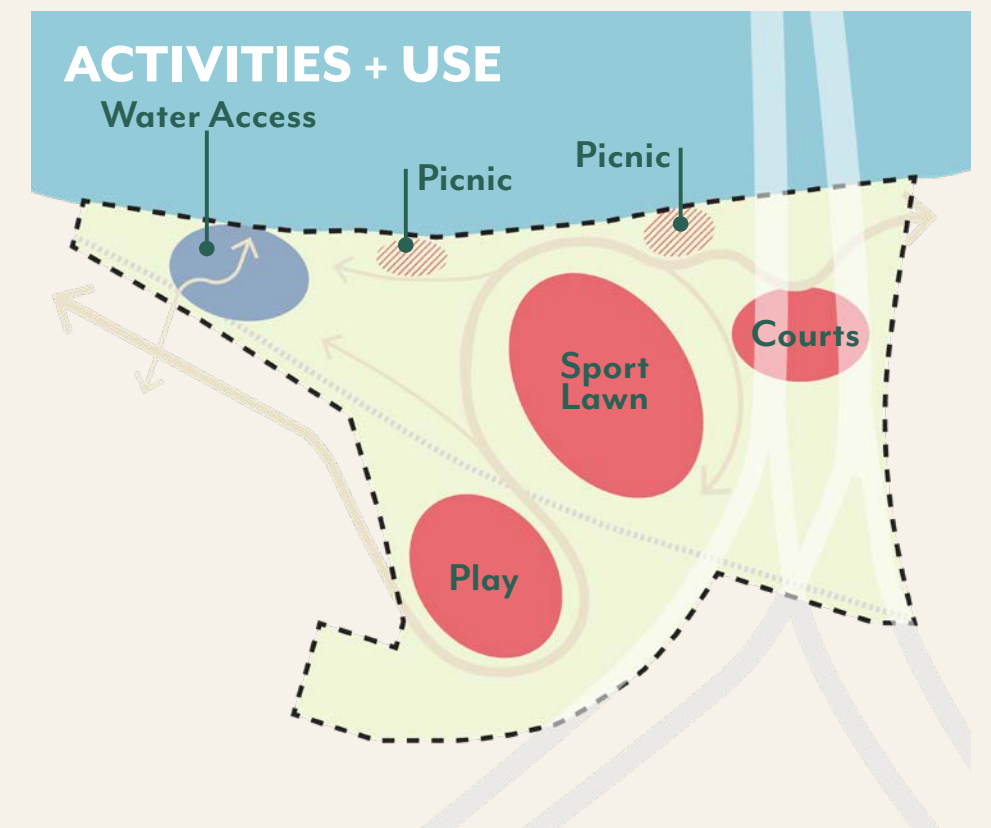
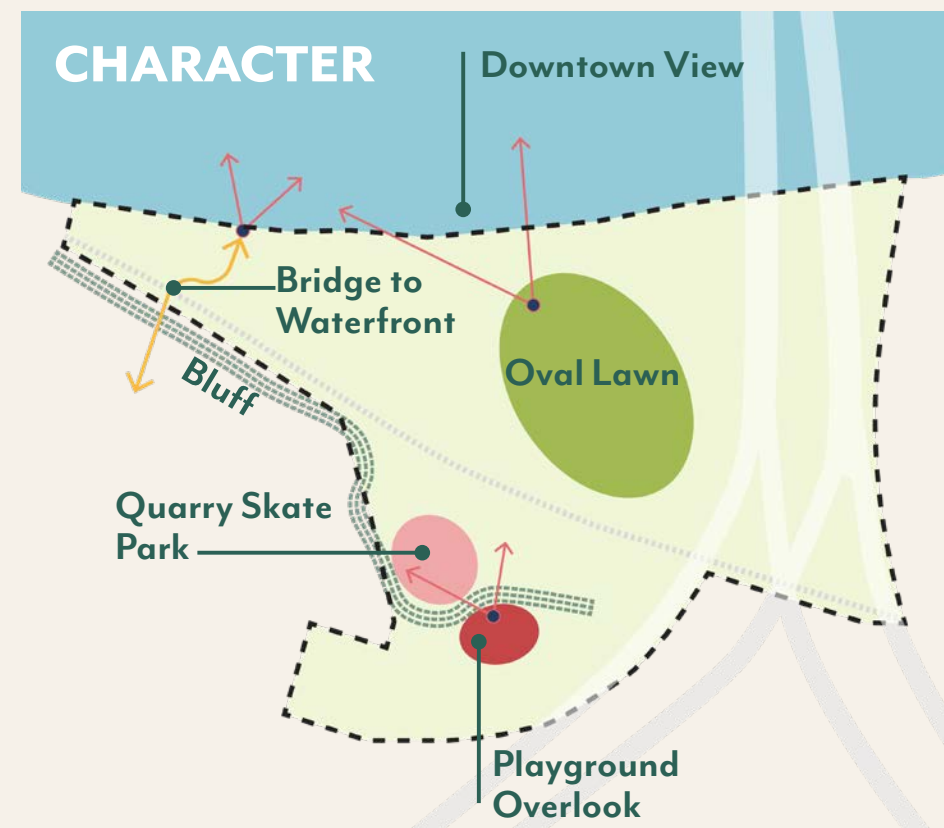
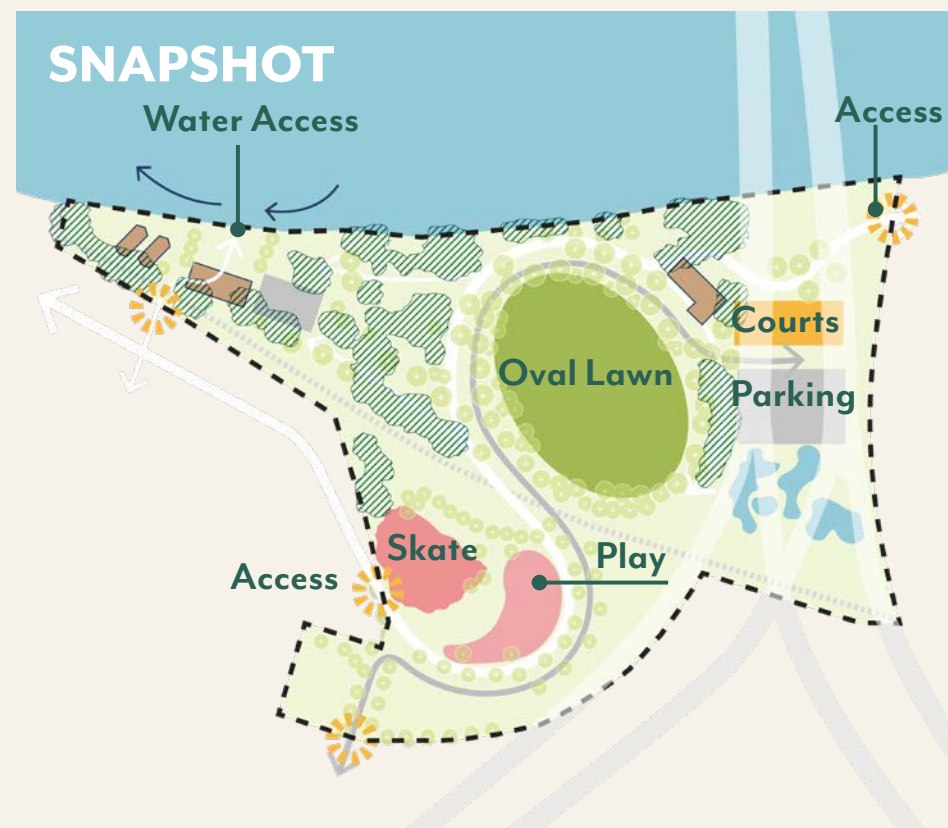
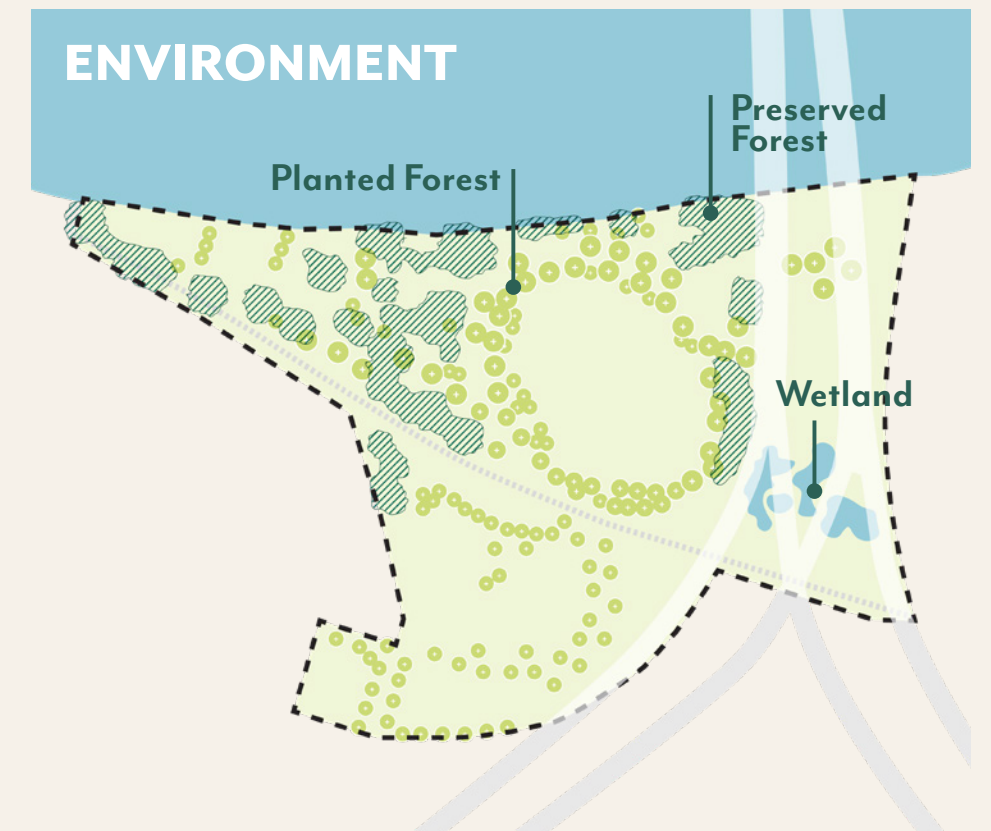
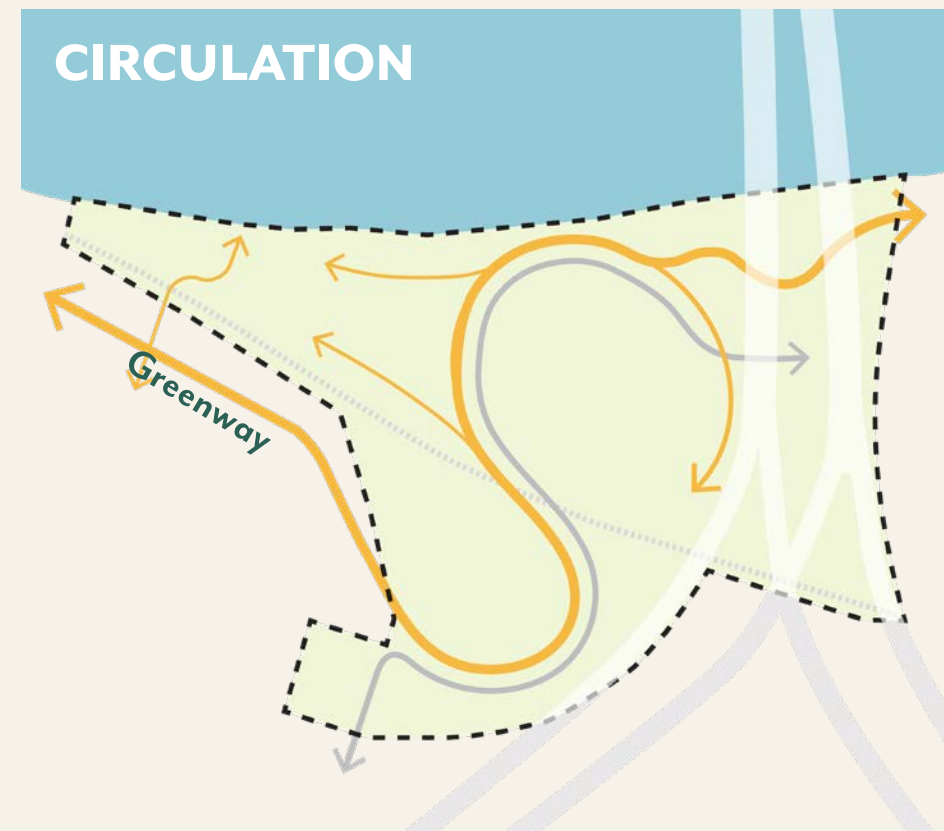

“Connect to
greenway”



“Skate park + skating
elements”

Quarry

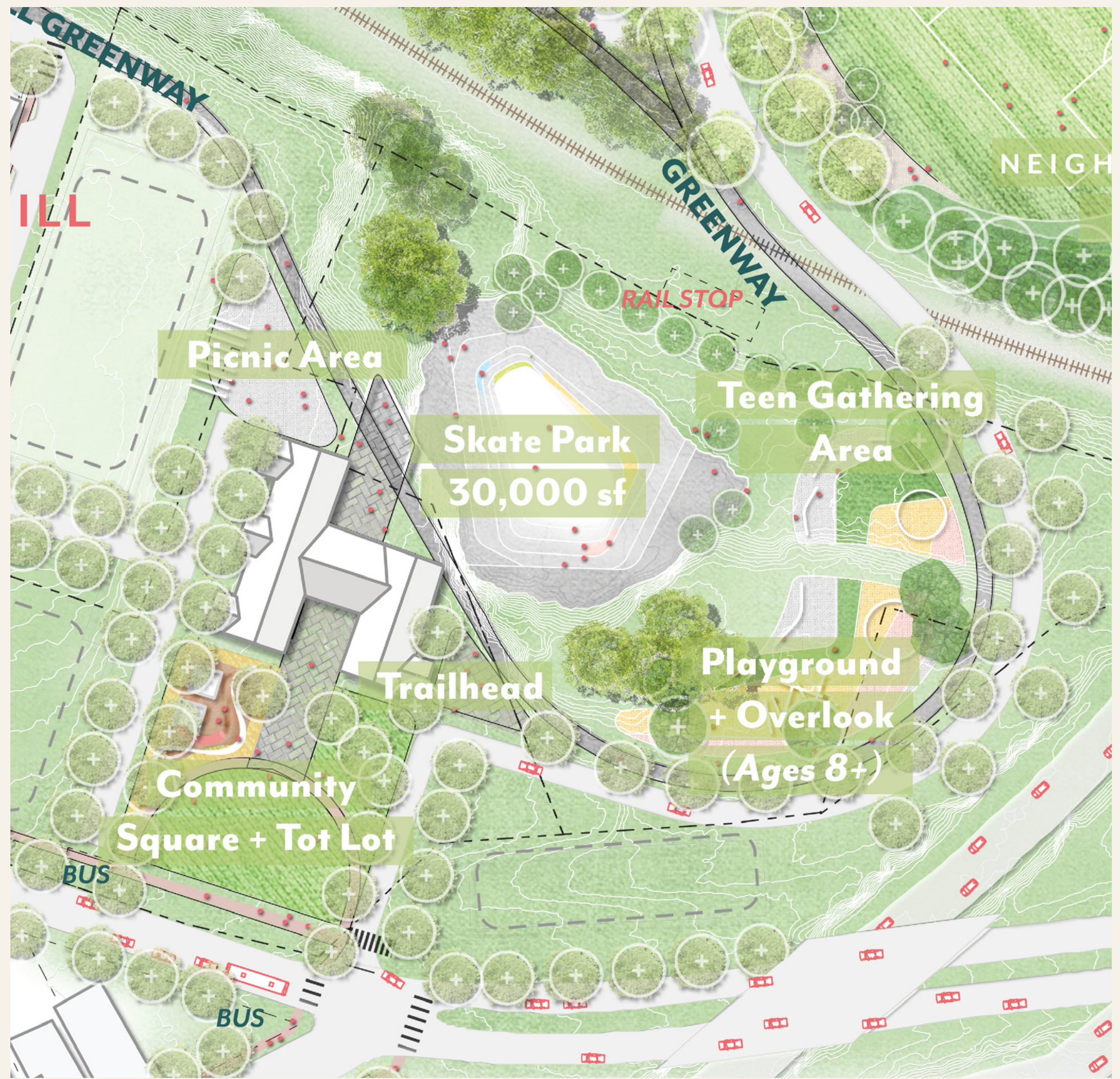



“Connect to adjacent neighborhoods”

“Community boathouse for water recreation and health”

“Kayak access and rental”

Waterfront

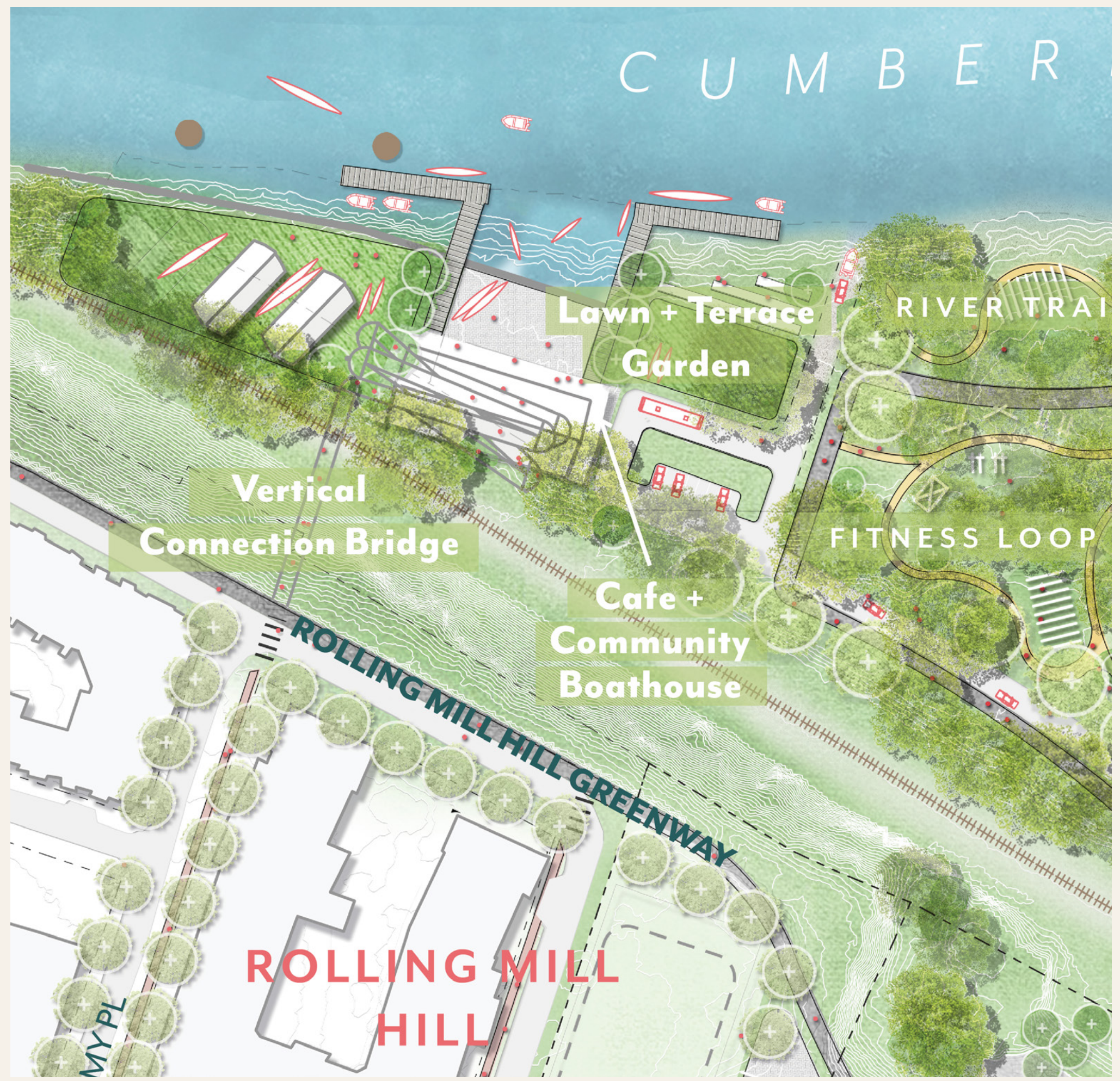

Bridge + Bowl

Design Character: Neighborhood Icon



Stovnerårnet
Oslo, Norway



Julian B Lane Riverfront
Tampa, FL



University of Texas
El Paso, TX



Skatepark Péitruuss
Luxembourg City, Luxembourg

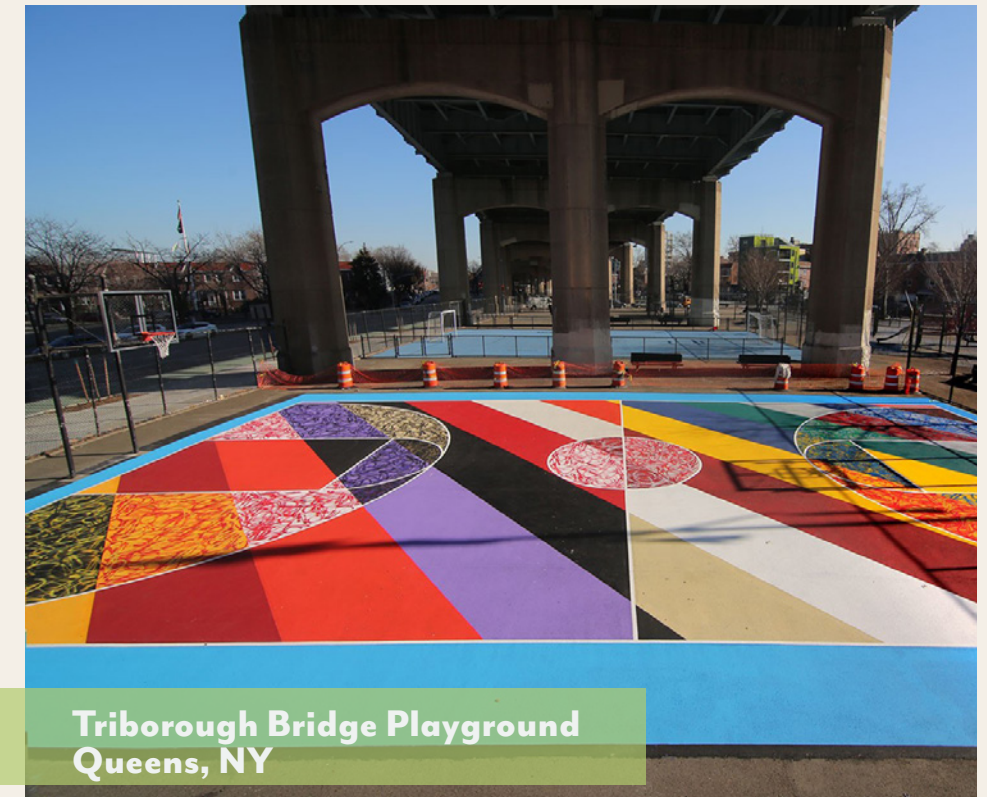

Triborough Bridge Playground
Queens, NY

Wetland Braid

CUMBERLAND RIVER

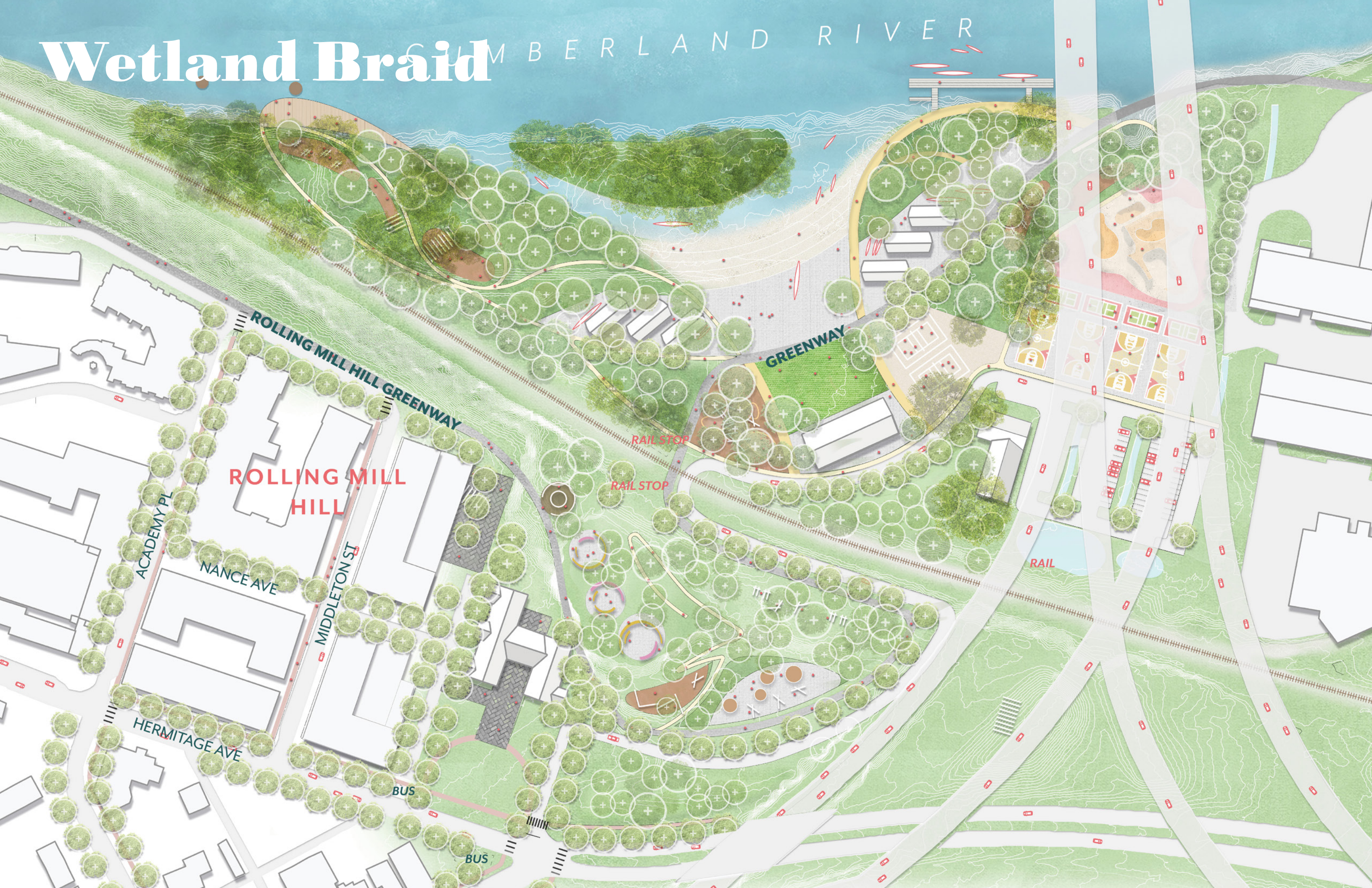

ROLLING MILL HILL

ROLLING MILL HILL GREENWAY

GREENWAY

RAIL STOP

RAIL STOP

RAIL

BUS

BUS

ACADEMY PL

NANCE AVE

MIDDLETON ST

HERMITAGE AVE

Wetland Braid

The river is celebrated in the Wetland Braid - with a new safe harbor channel carved into a newly restored and unique floodplain forest. Opportunities to engage with water and riparian education abound!

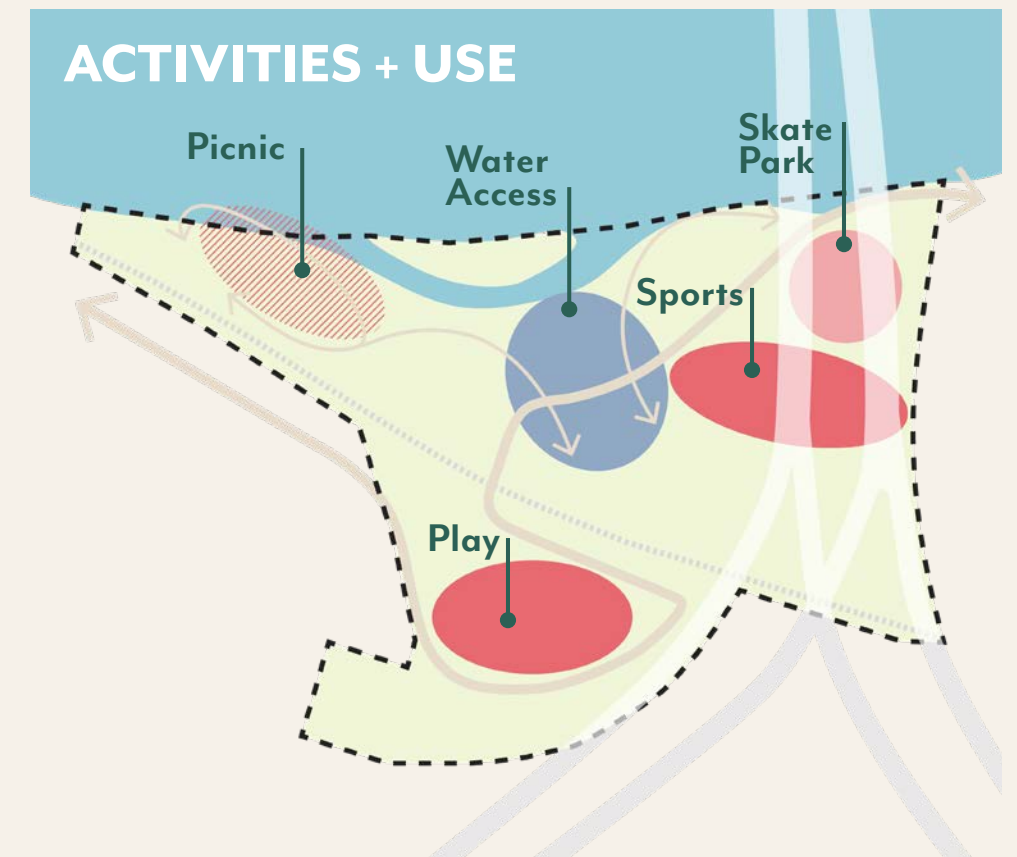
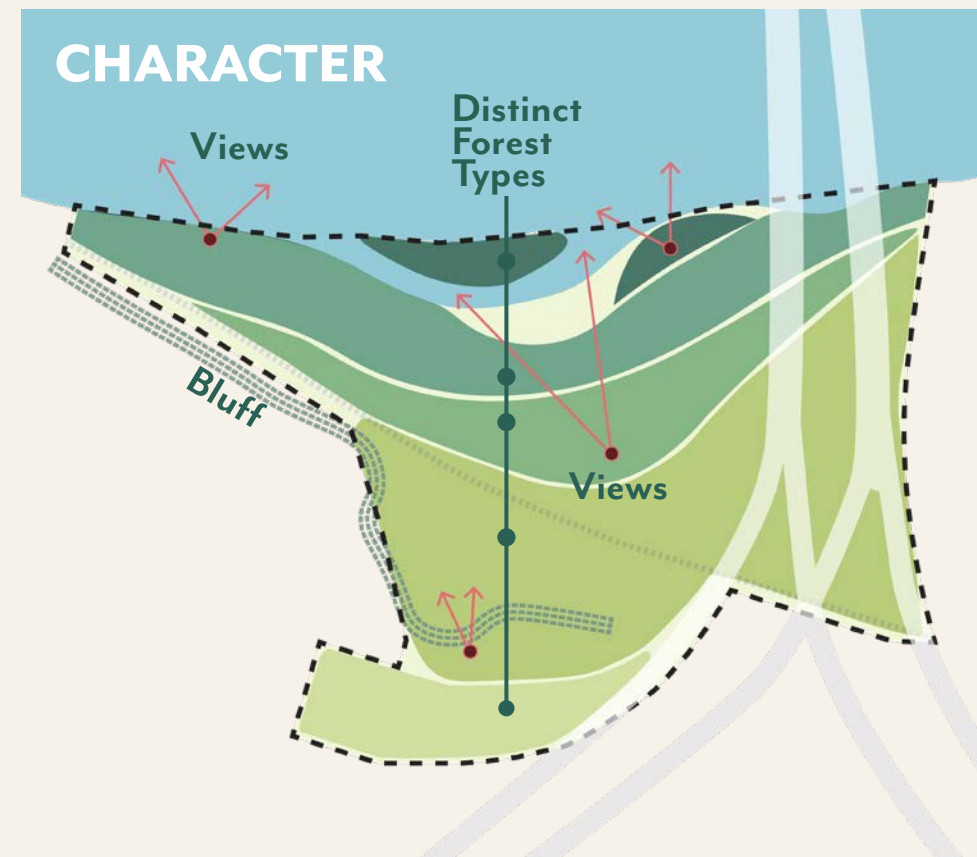
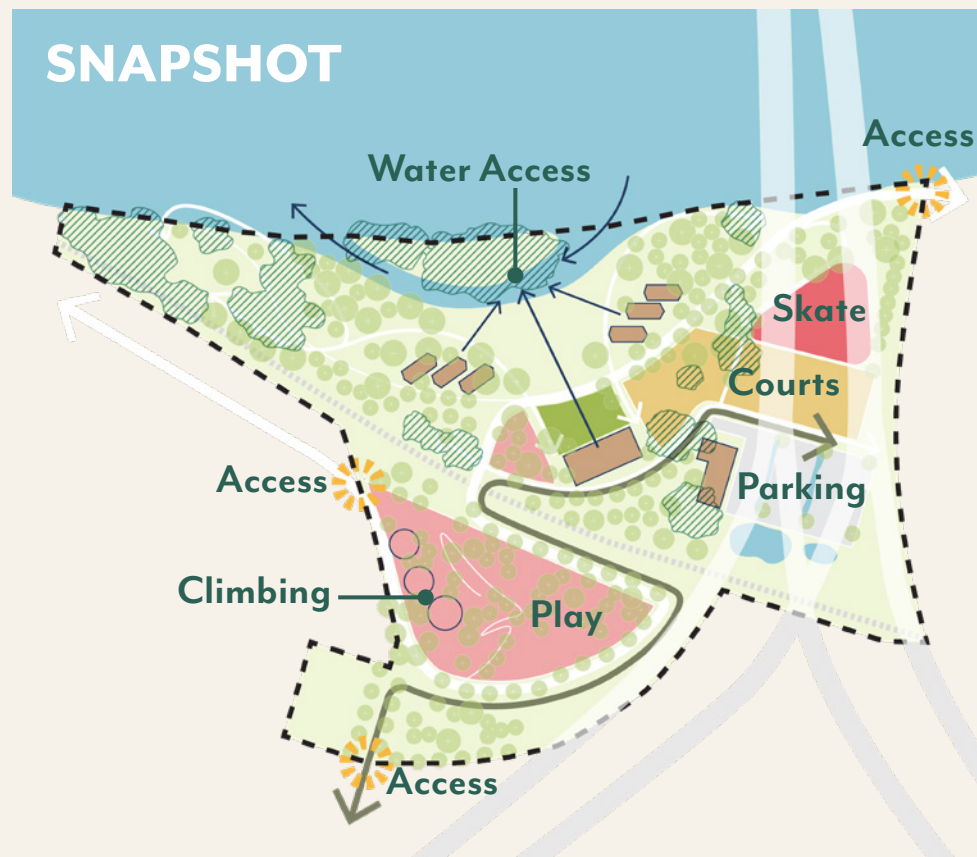
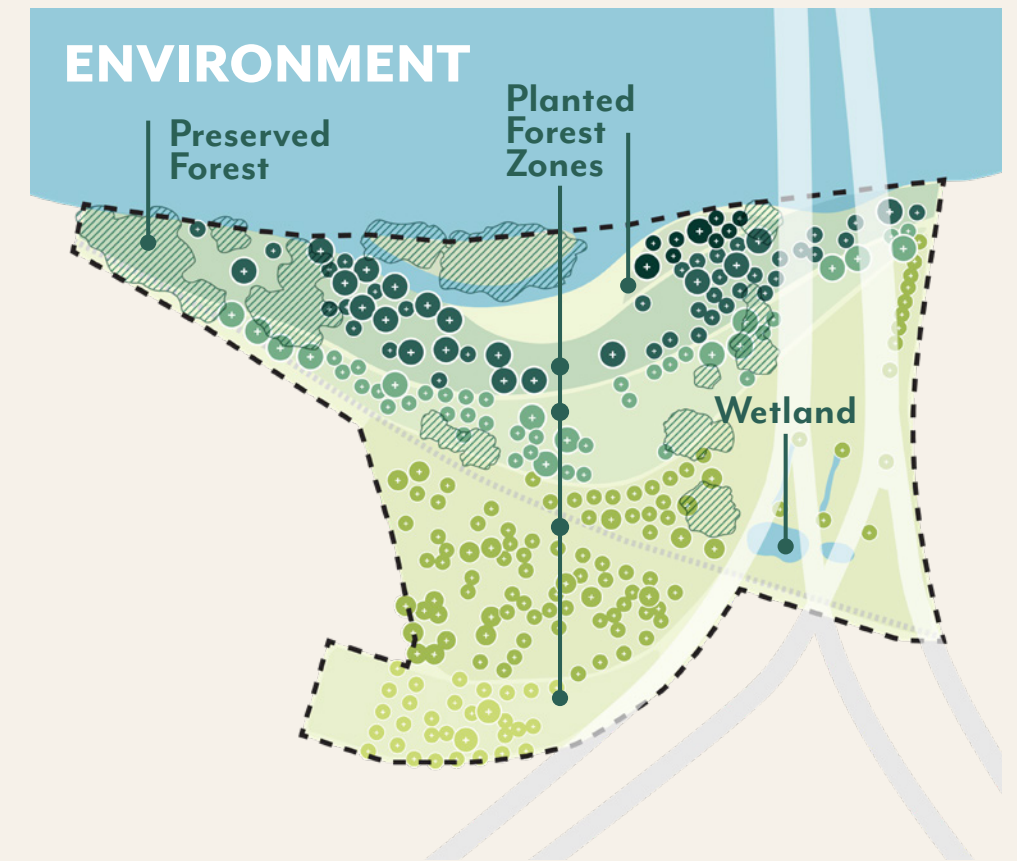
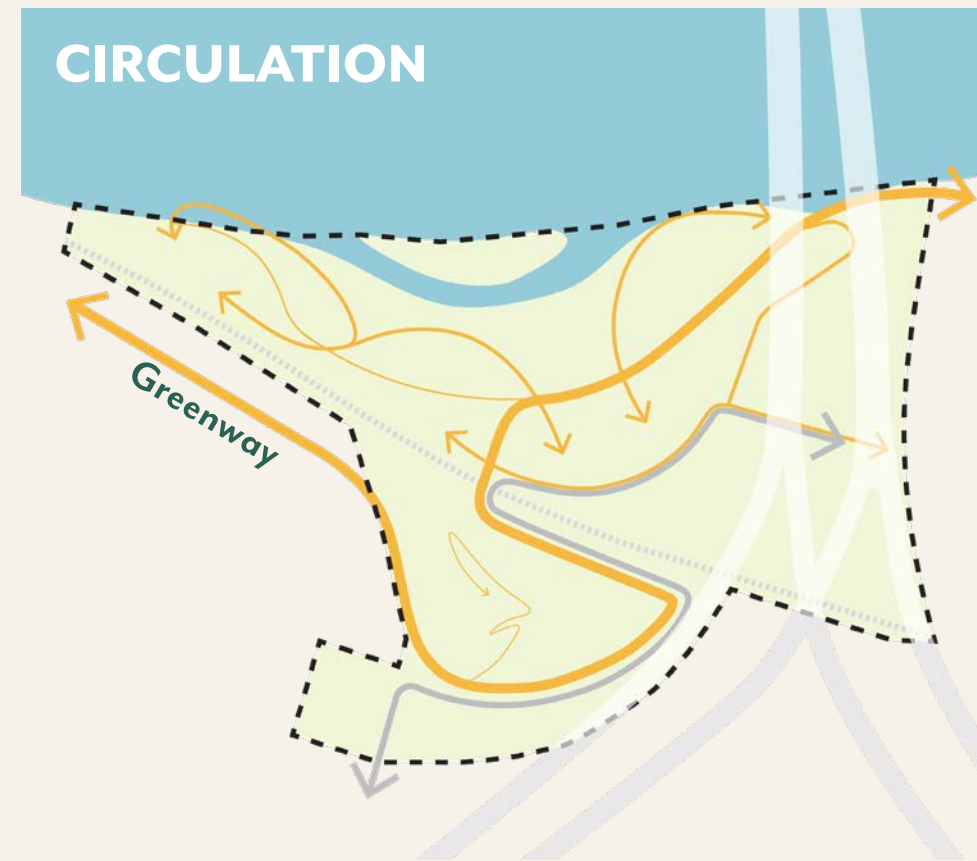

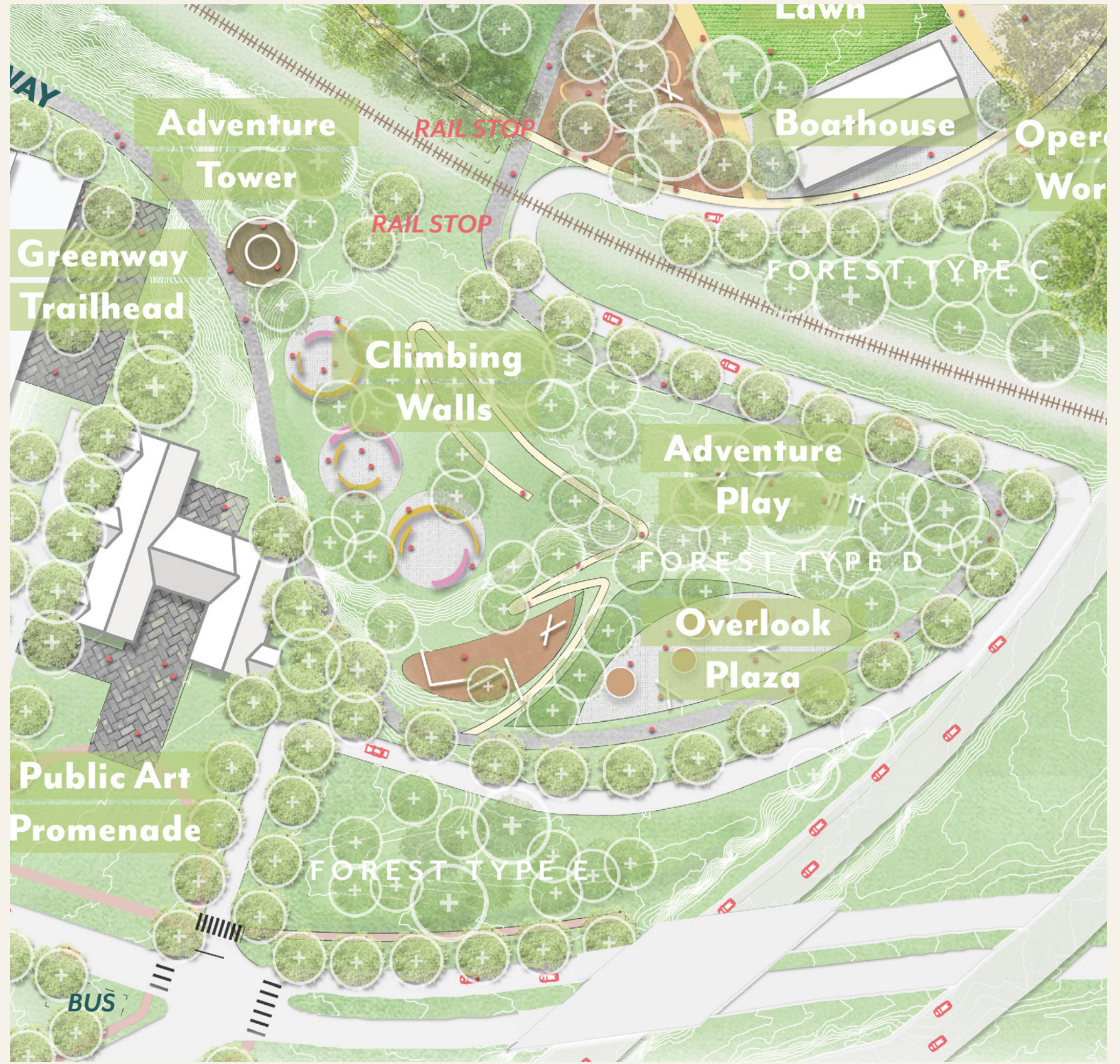





Wetland Braid

Design Character: A Celebration of Water



Qunli National Urban Wetland
China



Changsha Baxizhou Island
Hunan Province, China



Brooklyn Bridge Park
Brooklyn, NY



Flower Garden Drive
Longwood Gardens, PA



Normond Park
London, UK

Three Design Approaches

River Forest



Bridge + Bowl



Wetland Braid



Evaluation Matrix

Each neighborhood park design option has something unique to offer the community. Compare and contrast the three design options with the four community principles: Connectivity, Character, Environment and Activities.



	CONNECTIONS Connect to greater Nashville system of greenways, pedestrian walkability, and water access				CHARACTER Celebrate the unique bluff and riverside location	ENVIRONMENT Create a healthy and resilient relationship with water and ecological systems			ACTIVITIES Offer a range of activities—passive, recreational, educational—for people of all ages, backgrounds and abilities				
	trail landscape	greenway miles	parking spaces	% road access	design character	preserved forest	planted forest	storm water	water access	play	gathering	skate park	
RIVER FOREST	9 acres	1.66 miles	90 spaces (in one lot)	0.25 miles	INDUSTRIAL NATURE Special places - the wetland gardens and greenway ridgeline, for example - take advantage of remnant industrial traces. Preservation and enhancement of the existing forest is prioritized.	8 acres	4 acres	2 acres (quarry water garden and treatment wetland at parking)	500 lf	1 acre (age 12+) 1/2 acre (tot lot)	1 acres (Community Green) 1/2 acre (two picnic areas)	7,500 sf (tot skate spot)	45% active 55% passive
BRIDGE + BOWL	9.5 acres	1.5 miles	120 spaces (in two lots and on-street)	0.5 miles	NEIGHBORHOOD ICON Three major community hubs - the Rowing Facility, the Quarry Park and the Bowl - create special gathering places at points of key neighborhood connections. The bridge crossing the bluff creates an iconic connection and overlook.	6 acres	6 acres	1 acre (treatment wetland at parking)	300 lf	3,500sf (ages 2+) 1/2 acre (ages 8+) 4,500sf (ages 12+)	4 acre (Bowl) 1/2 acre (Community Green)	30,000 sf (destination skate park)	30% active 70% passive
WETLAND BRAID	8 acres	1.33 miles	110 spaces (in one lot)	0.25 miles	A CELEBRATION OF WATER The river is celebrated in the Wetland Braid - with a new safe harbor channel carved into a newly restored and unique floodplain forest. Opportunities to engage in riparian education abound!	3 acres	9 acres	2 acres (wetland forest) 1 acre (water channel) 3/4 acre (treatment wetland)	600 lf	1.5 acres (adventure play) 1/2 acre (play area)	1 acre (Two Plazas) 3/4 acre (two picnic areas) 1/2 acre (Flex Lawn)	25,000 sf (destination skate park)	40% active 60% passive



Use your scorecard to tell us how YOU think each option aligns with the design principles and your own vision for your future riverfront neighborhood park!

Give Us Your Feedback!

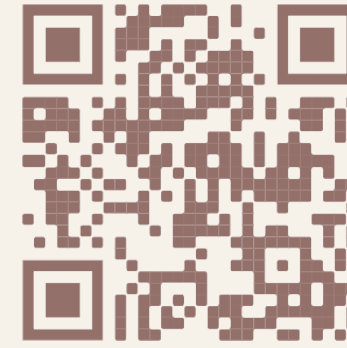

bit.ly/wharfparkfeedback

Wharf Park Recap!

Here is a recap of the three design scenarios.
Use the other side of this sheet to share your thoughts!

RIVER FOREST

(Station 1)



BRIDGE + BOWL

(Station 2)



WETLAND BRAID

(Station 3)



INDUSTRIAL NATURE

Special places - the wetland gardens and greenway ridgeline, for example, take advantage of remnant industrial traces. Preservation and enhancement of the existing forest is prioritized.

NEIGHBORHOOD ICON

Three major community hubs - the Rowing Facility, the Quarry Park and the Bowl - create special gathering places at points of key neighborhood connections. The bridge crossing the bluff creates an iconic connection and overlook.

A CELEBRATION C

The river is celebrated in th
- with a new safe harbor c
into a newly restored and u
forest. Opportunities to en
education abo

Wharf Park Scorecard

Use this scorecard to tell us how well each concept design aligns with the principles and your vision of your future riverfront neighborhood park!

	CONNECTIONS	CHARACTER	ENVIRONMENT	ACTIVITY + USE
	Connect to greater Nashville system of greenways, pedestrian walkability, and water access (0) Place an "X" on the scale below (10)	Celebrate the unique bluff and riverside location (0) Place an "X" on the scale below (10)	Create a healthy and resilient relationship with water and ecological systems (0) Place an "X" on the scale below (10)	Offer a range of activities—passive, recreational, educational—for people of all ages, backgrounds and abilities (0) Place an "X" on the scale below (10)
RIVER FOREST (Station 1)				
BRIDGE + BOWL (Station 2)				
WETLAND BRAID (Station 3)				

Additional Comments:

Community Events!

FOUR WAYS TO ENGAGE

JANUARY 19 - 5:30 - 7:30 PM
MIDTOWN HILLS POLICE PRECINCT
1441 12TH AVE S

JANUARY 20 - 11:30 - 1:00 PM
NASHVILLE CIVIC DESIGN CENTER
[WWW.CIVICDESIGNCENTER.ORG/
ALL-EVENTS/WHARF-PARK](http://WWW.CIVICDESIGNCENTER.ORG/ALL-EVENTS/WHARF-PARK)

JANUARY 21 - 12:00 - 1:00 PM
WHARF PARK MASTER PLAN
FACEBOOK LIVE
FACEBOOK.COM/METRONASHVILLEPARKS

JANUARY 22 - 12:00 - 2:00 PM
NAPIER COMMUNITY CENTER
73 FAIRFIELD AVE

Wharf Park

community meeting #2!

THREE OPPORTUNITIES TO ENGAGE

JANUARY 19 - 5:30 - 7:30 PM
MIDTOWN HILLS POLICE PRECINCT
1441 12TH AVE S

JANUARY 21 - 12:00 - 1:00 PM
WHARF PARK MASTER PLAN
FACEBOOK LIVE
FACEBOOK.COM/METRONASHVILLEPARKS

JANUARY 22 - 12:00 - 2:00 PM
NAPIER COMMUNITY CENTER
73 FAIRFIELD AVE



Questions?

Thank you!