

# Virtual Community Meeting Notice for Proposed Bellevue Community Plan Amendment

Metro Planning Commission Case Number **2021CP-006-001**

**WHAT IS THE VIRTUAL COMMUNITY MEETING ABOUT?** To discuss a request to amend the Bellevue Community Plan, by changing land use policy for property located at 1084 Morton Mill Rd, currently accessed from the terminus of Morton Mill Rd. The plan amendment area is shown on the map on the back of this notice. The request would change the land use policy from Rural Maintenance (T2 RM) to Suburban Neighborhood Evolving (T3 NE) policy.

## *Virtual Community Meeting*

**Thursday, July 7, 2022**

**6:00 – 7:30 p.m.**

For more information on how to take part in the meeting, go online and:

- Visit <https://www.nashville.gov/departments/planning> click on the event information in the calendar toward the bottom of the page; OR
- Visit the Bellevue Community Plan webpage: <https://www.nashville.gov/departments/planning/long-range-planning/community-plans/bellevue>
- Joining the meeting through your computer/tablet allows you to view slides and presentation materials as well as ask questions and share thoughts.

To join the live meeting by phone:

- Dial 1 415 655 0002
- When prompted for the meeting access code, dial 2483 413 2581 followed by #
- NOTE — JOINING BY PHONE: you will *not* be able to view the presentation, unless the meeting is available for streaming online.

**WHAT IS A COMMUNITY PLAN?** Community Plans guide future growth and preservation decisions made by Metro government. This includes recommendations to Metro Council on zone change requests. The Community Character Manual (CCM) contains more information about the current community plan (land use) policies, and is available at: <https://www.nashville.gov/departments/planning/long-range-planning/community-character-manual>

**WHAT IS THE CURRENT COMMUNITY PLAN (LAND USE) POLICIES?** The current land use policy for the plan amendment area is Rural Maintenance (T2 RM). This policy is intended to maintain rural character as a permanent choice for living within Davidson County. T2 RM areas have established low-density residential and agricultural development patterns.

**WHAT CHANGES ARE PROPOSED? (SEE MAP ON REVERSE FOR MORE DETAIL)** The plan amendment request would change the area of T2 RM, outlined on the map, to Suburban Neighborhood Evolving (T3 NE) policy. T3 NE policy is intended to create and enhance suburban residential neighborhoods with more housing choices, improved pedestrian, bicycle, and vehicular connectivity, and moderate density development patterns. T3 NE areas are developed with creative thinking in environmentally sensitive building and site development techniques to balance the increased growth and density with its impact on area streams and rivers. In order to achieve these goals, the property proposes bridging the river and connecting to Coley Davis Rd. as well as connecting and enhancing the parks and greenways systems.

**WHY ARE THESE CHANGES PROPOSED?** The property owner or representative has requested this policy amendment, which requires a community meeting so that Planning staff can hear from you. Planners facilitated a community meeting on August 10, 2021. However, there were a lot of outstanding questions and issues that the applicant team needed to follow up on. Now, planners are hosting a second community meeting to discuss more details regarding the proposed development and gather additional feedback.

**WHO CAN I CONTACT?** For more information about the land use policy change or the virtual meeting, please contact Anita McCaig at [anita.mccaig@nashville.gov](mailto:anita.mccaig@nashville.gov) or 615 862 7156.

You can also visit <https://maps.nashville.gov/DevelopmentTracker/> for more information. Click on the magnifying glass, then Case # to search for case number 2021CP-006-001.

## Map of Proposed Community Plan Amendment Area

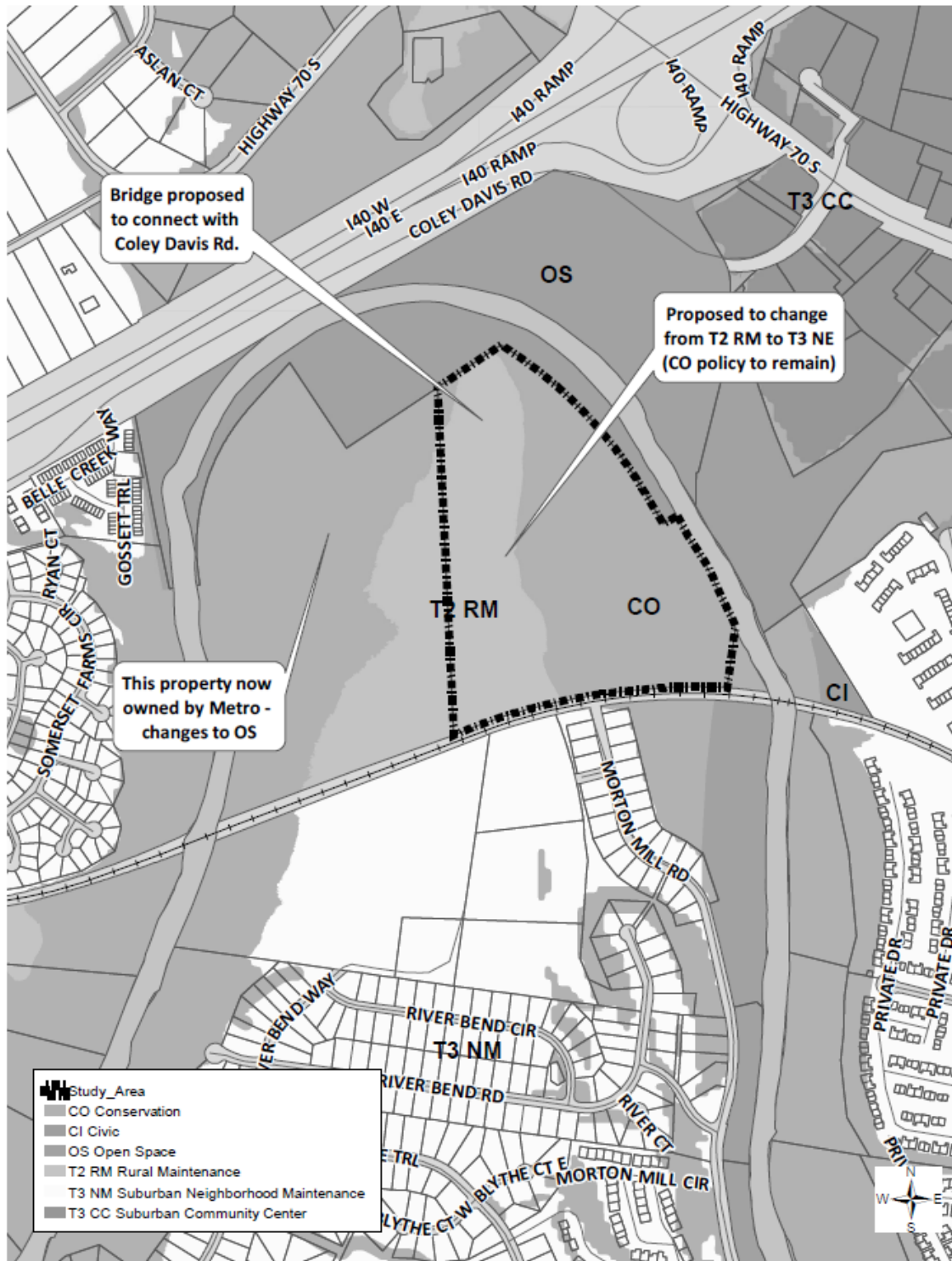

The Planning Department does not discriminate on the basis of race, color, national origin, gender, gender identity, sexual orientation, age, religion, creed or disability in admission to, access to, or operations of its programs, services, or activities. Discrimination against any person in recruitment, examination, appointment, training, promotion, retention, discipline or any other employment practices because of non-merit factors shall be prohibited. For ADA inquiries, contact Josie Bass, ADA Compliance Coordinator, at (615) 862-7150 or [josie.bass@nashville.gov](mailto:josie.bass@nashville.gov).

For Title VI inquiries, contact Melody Fowler-Green, executive director of Human Relations at (615) 880-3374.

For all employment-related inquiries, call 862-6640. Please see the Metro Planning Commission website at [www.nashville.gov/mpc](http://www.nashville.gov/mpc) for the most up-to-date version of this statement.