

5246 Brick Church Pike Culvert Replacement

Existing Conditions

Description:

Pike. The existing culvert consists of a 33' long 72"x56" CMP with stone headwalls. There is an area of pavement settlement that has since been patched. The corrugated metal pipe has 100% section loss throughout the pipe invert. The stone headwalls have missing stones and mortar loss. The headwalls have started to fail. Additionally, there is evidence of ponding and sediment deposit at the outlet.

Spans: 1

Length: 33'

Width: 72"

Rise: 56"

Reasons for replacement:

- ✓ Embankment Erosion
- ✓ Headwall Failure
- ✓ 100% Section Loss
- ✓ Water Main Relocation



Failing Headwall



100% Section Loss throughout Invert



Patched Roadway Settlement

5246 Brick Church Pike Culvert Replacement

Proposed Conditions

Description:

The proposed culvert construction will include a 14.5'x5' reinforced concrete slab bridge, the installation of guardrail, roadway reconstruction, and site restoration to ensure proper functionality. Due to the depth and width of construction, the road will need to be closed to through traffic throughout the duration of the project. The project has been scheduled while school is out for summer in order to have the least impact on the community.

Spans: 1

Length: 50'

Width: 14.5'

Rise: 5'

Opinion of Probable Cost: \$450,000

Anticipated Construction Duration: 3 Months

Anticipated Schedule for Construction:

June 8th through August 22nd

Intermittent Road Closures:

June 8th through August 22nd

Project Status: Ready for construction

Construction Challenges:

- ✓ Waterline Coordination
- ✓ Coordination Between Utilities and the NDOT Annual Contractor

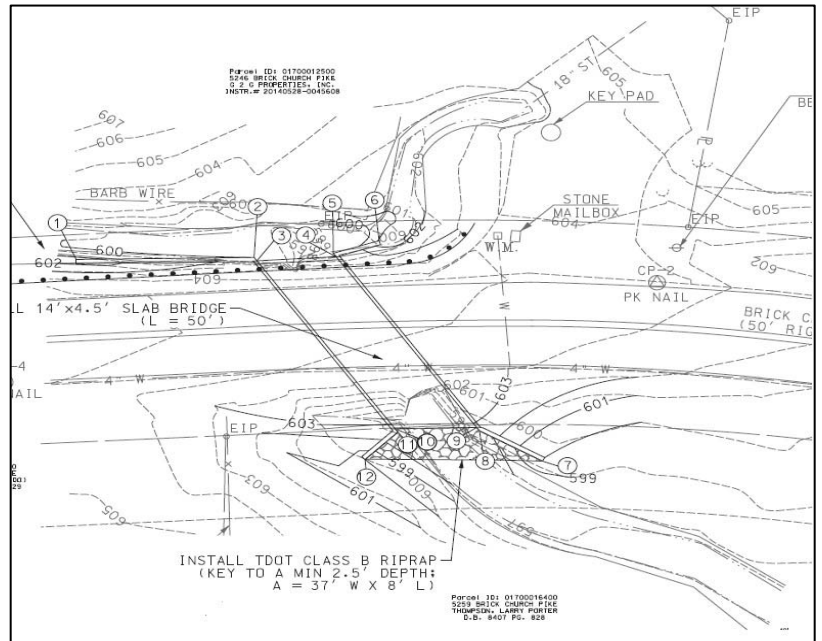

Project Plan View

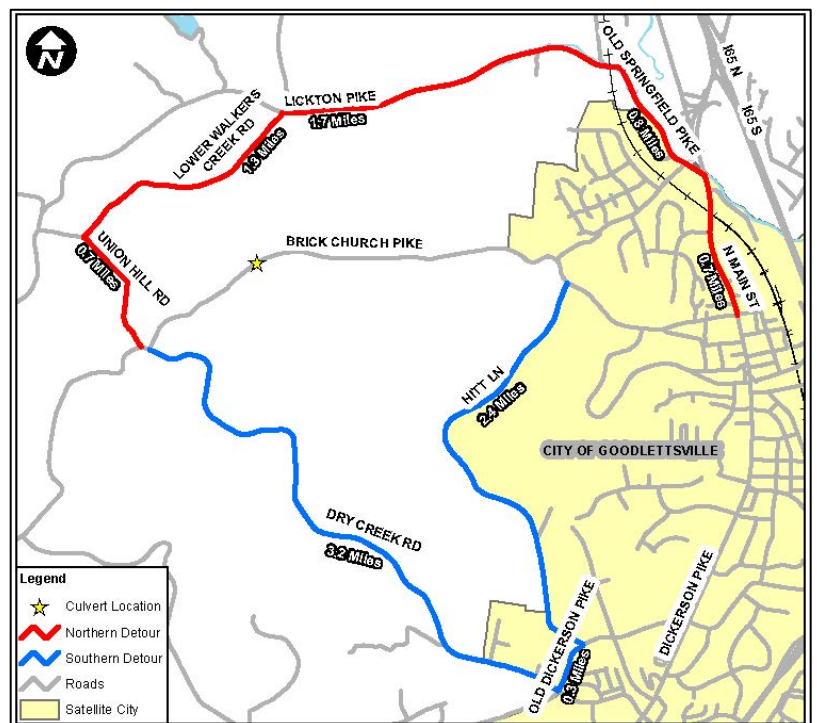

Vicinity Map