



Community Workshop #3 Draft Master Plan

August 24, 2023

Tonight's Agenda

- Community Engagement
- Draft Master Plan
- Implementation

COMMUNITY ENGAGEMENT

Planning Process

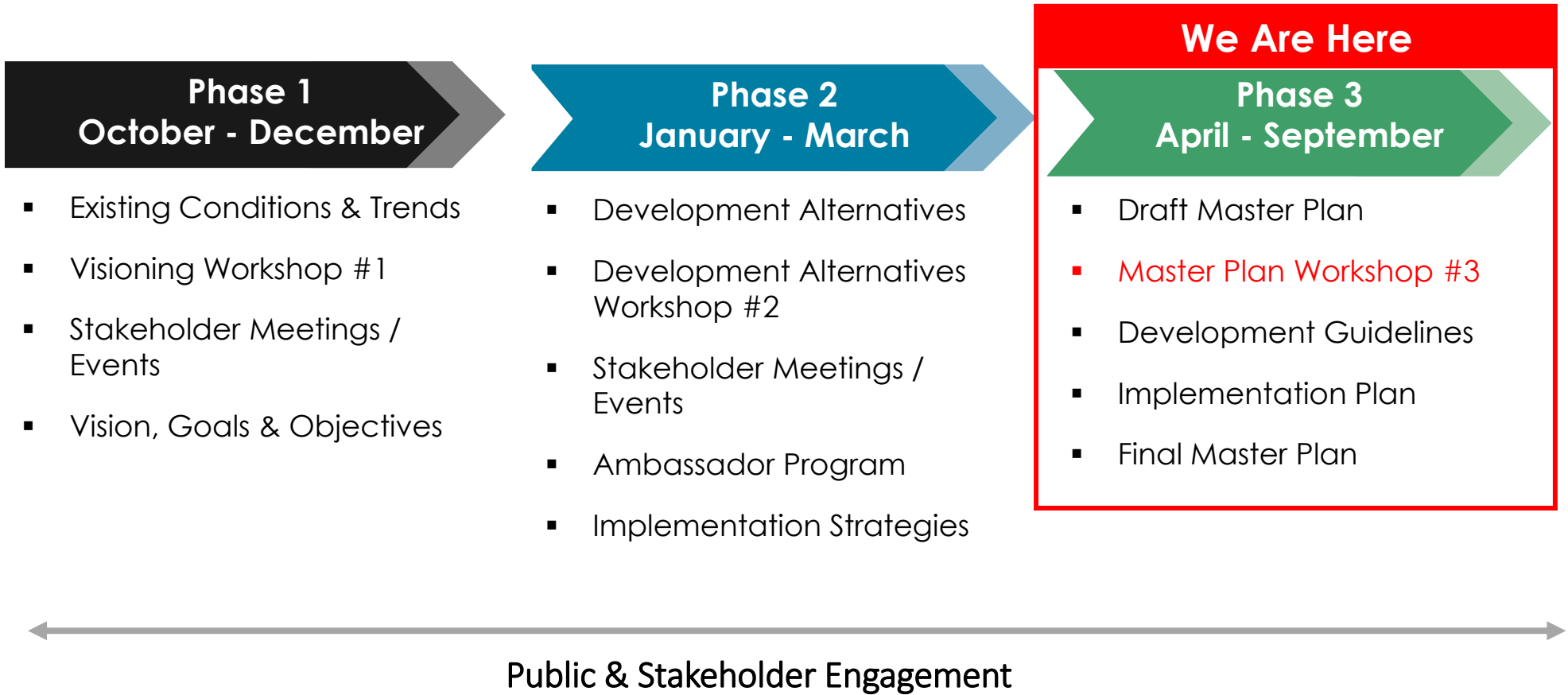



VISION

Reinvent the Global Mall area as a lively mixed-use, walkable, connected, arts-centered district and regional destination that enriches quality of life, expands economic and life-path opportunities, and celebrates diversity and shared community for Antioch and the greater region.

 25+

Stakeholder Meetings

with local community groups, leaders, and institutions within the Global Mall area and in greater Nashville.

 650+

Comments Received

at two community workshops, the project website, write-in comments at pop up events, and survey responses.

 1,100+

Community Members Reached

through two community workshops, pop ups at NSCC and local apartments, Metro Council District 32 meetings, the project website, and through a Community Ambassador Program.

COMMUNITY FEEDBACK

“We need greenspaces, a farmers market, multi-cultural arts and event space, safe space to walk and bike, access to affordable healthcare that can support multiple languages, and more affordable housing.”

“We have Slim and Huskies close by. I would love more opportunities for local food vendors, maybe a food truck park or an indoor restaurant space similar to Hunter Station.”

“This parking lot is not safe. My kids play hockey here, and there are no safe (or identified) walkways through the parking lot.”

“More bike lanes, especially bike lanes with vertical delineators or true concrete-protected bike lanes. Less sharrows. They do not add any amount of safety for cyclists.”

DRAFT MASTER PLAN

Global Mall Site Existing Properties

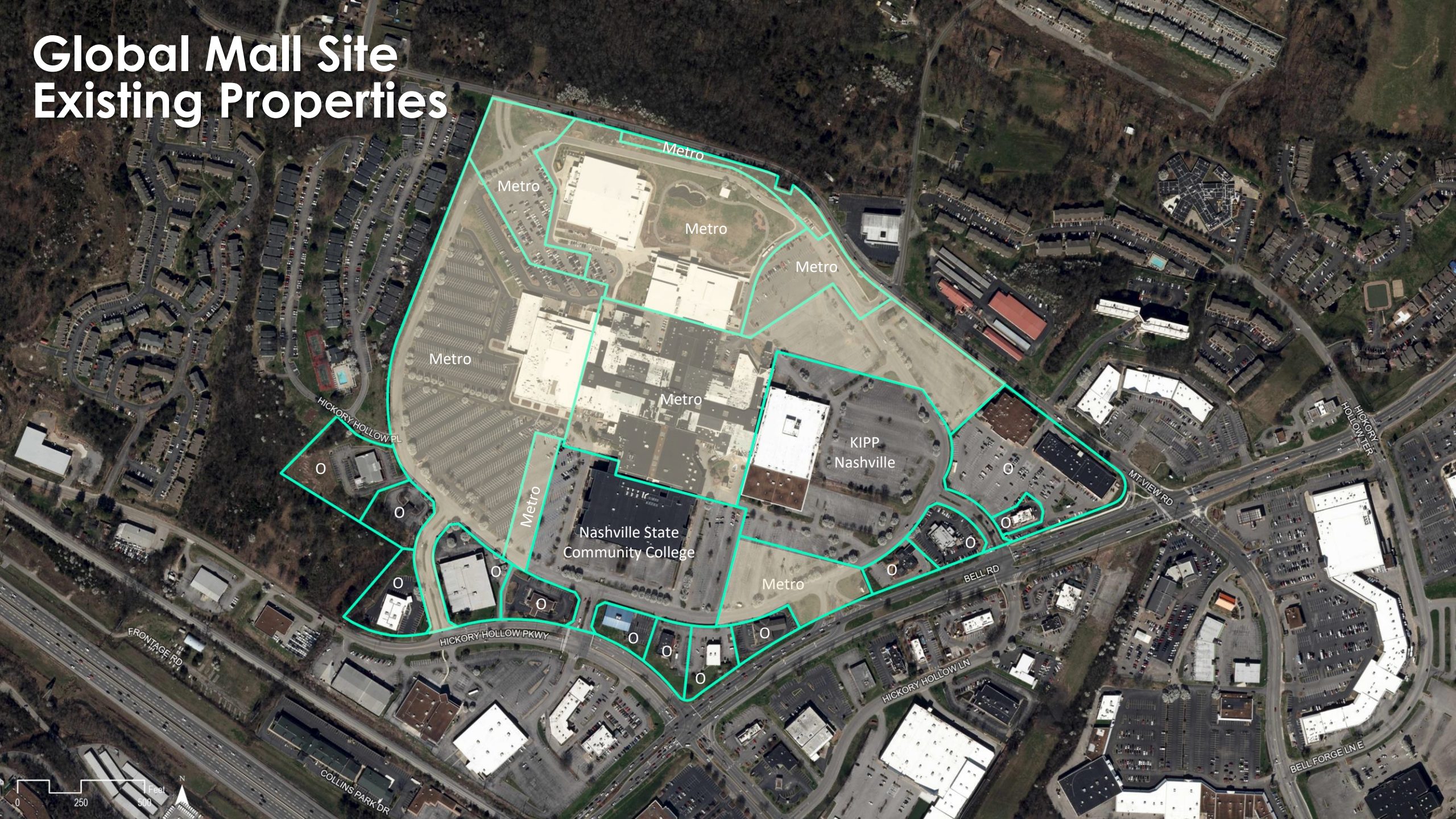

Metro

Metro

Metro

Metro

Metro

Metro

KIPP
Nashville

Nashville State
Community College

Metro

HICKORY HOLLOW PL

HICKORY HOLLOW TER

MT VIEW RD

BELL RD

FRONTAGE RD

HICKORY HOLLOW PKWY

HICKORY HOLLOW LN

COLLINS PARK DR

BELL FORGE LN E



EXISTING SITE PLAN

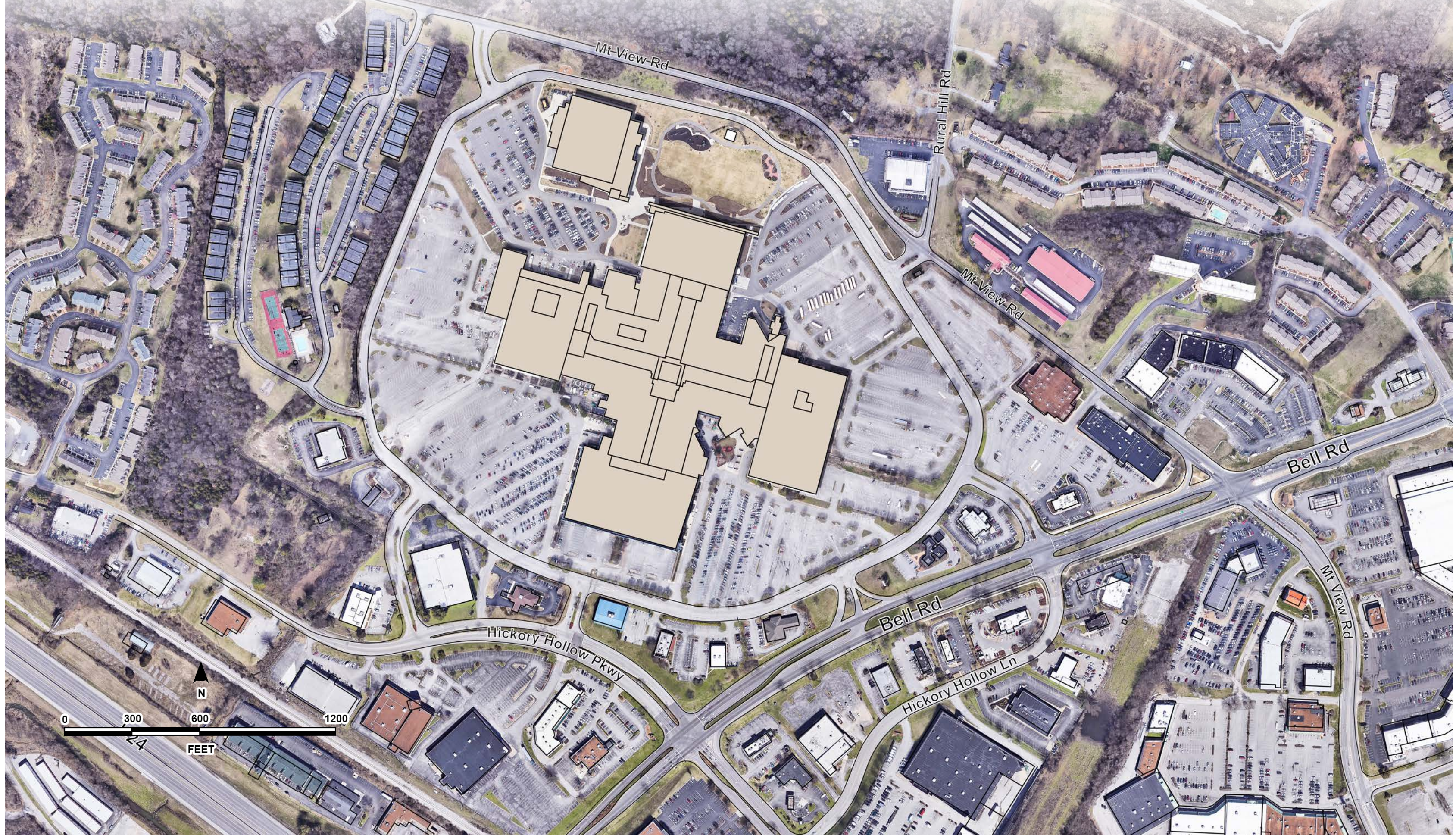

DRAFT MASTER PLAN CONCEPT



DRAFT SITE CROSS SECTION

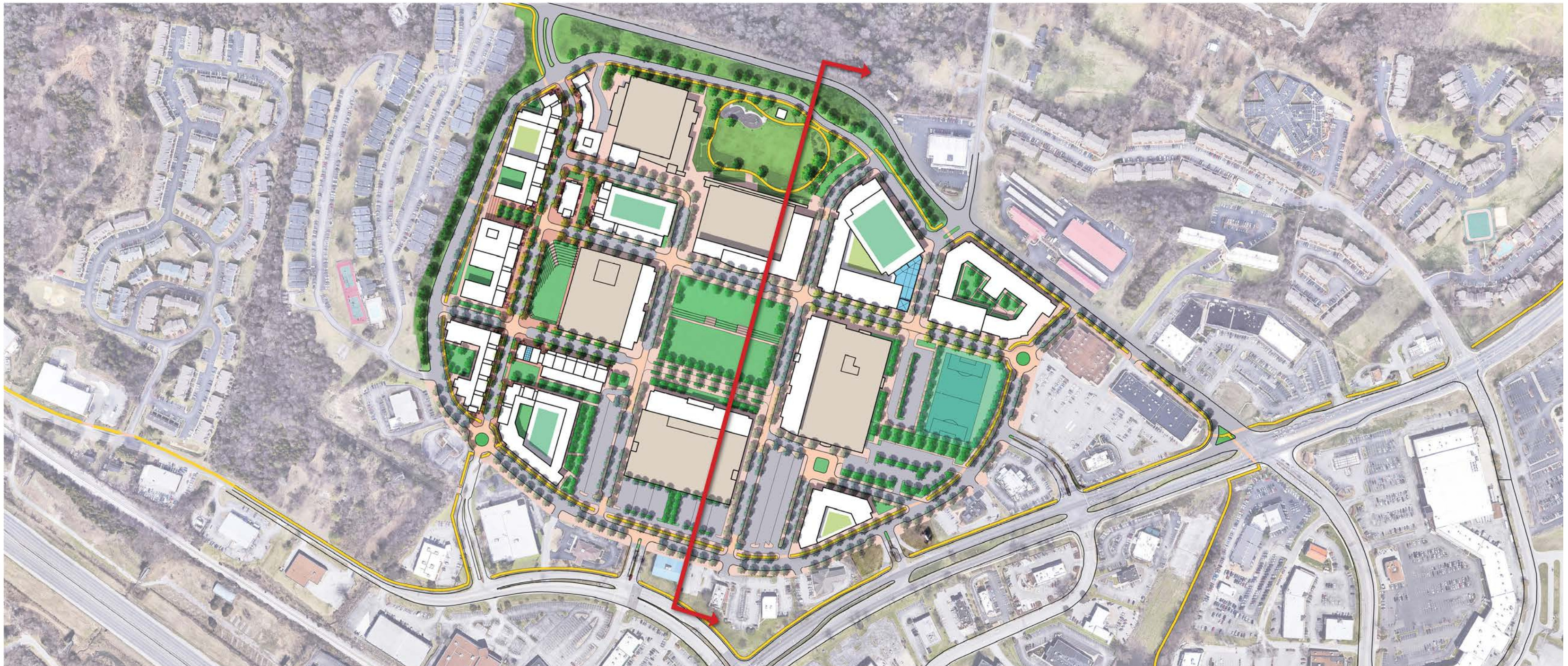
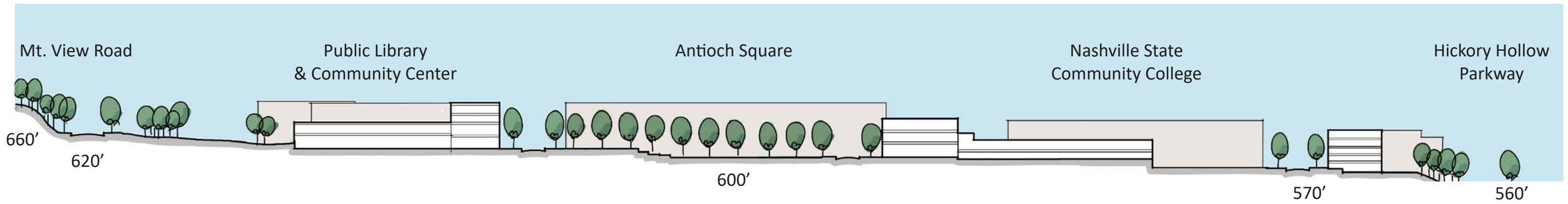

DRAFT CONCEPT MASSING MODEL WITH LAND USES



DRAFT PERSPECTIVES

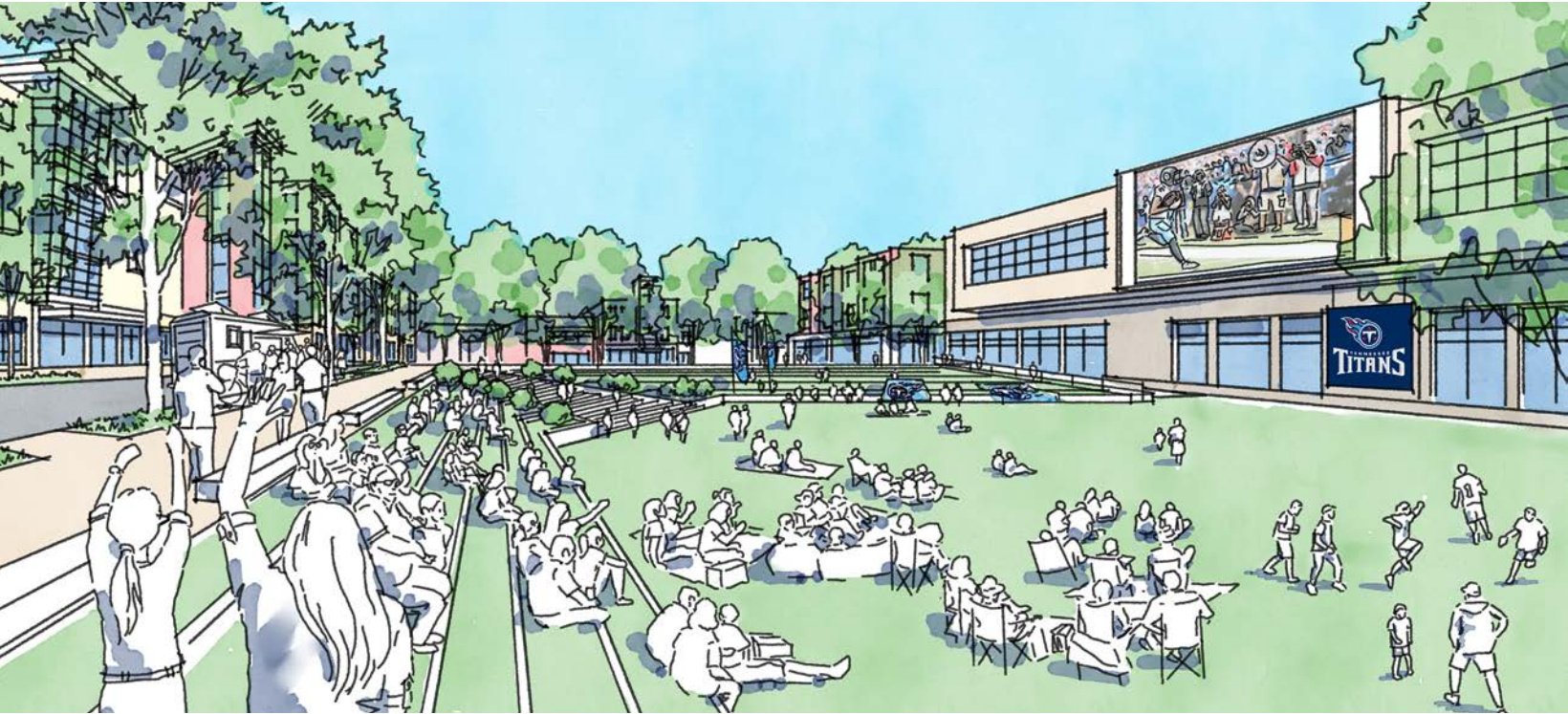

ARTS WAY



TOWN SQUARE



INNOVATION BOULEVARD



PERIMETER LOOP

IMPLEMENTATION

DRAFT MOBILITY IMPROVEMENTS

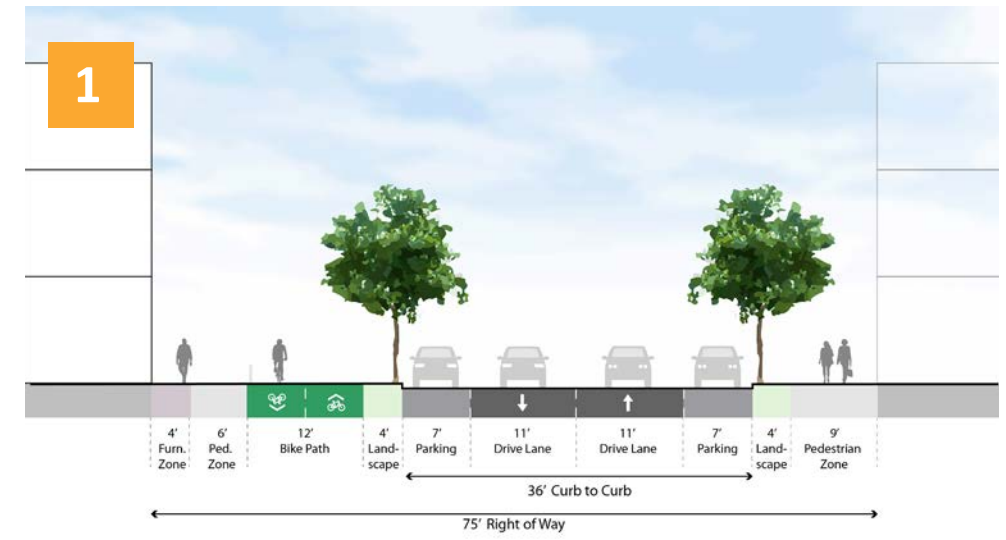
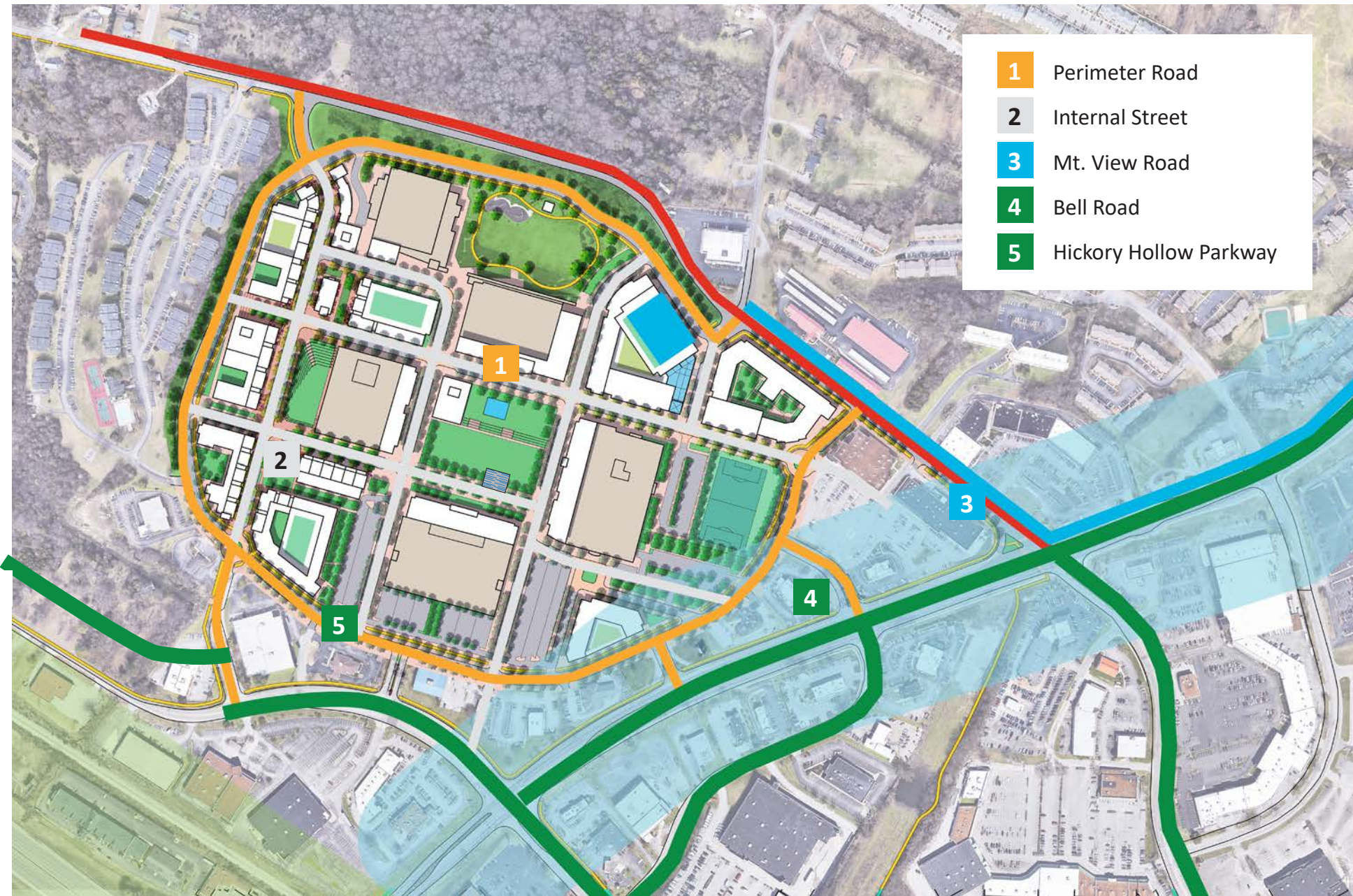

Perimeter Road

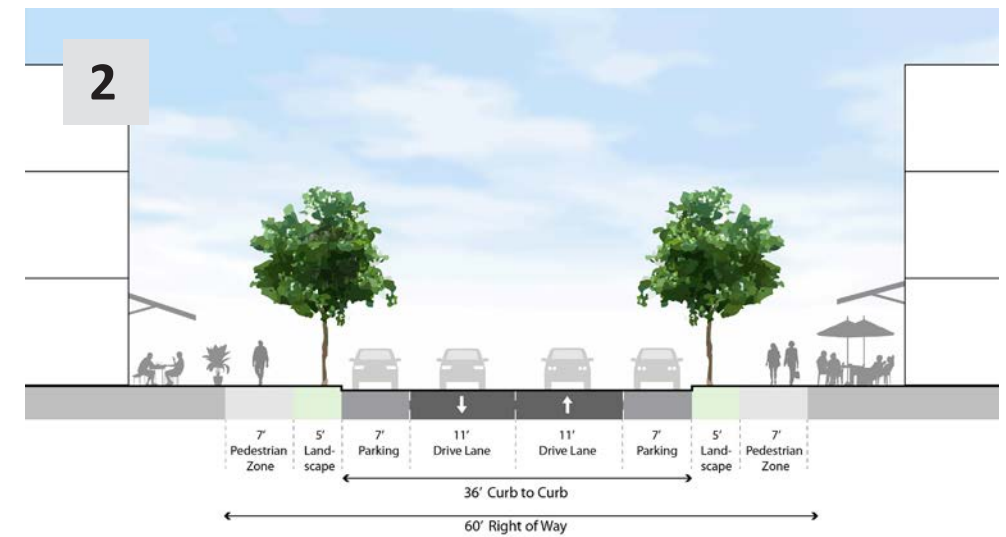

Internal Street

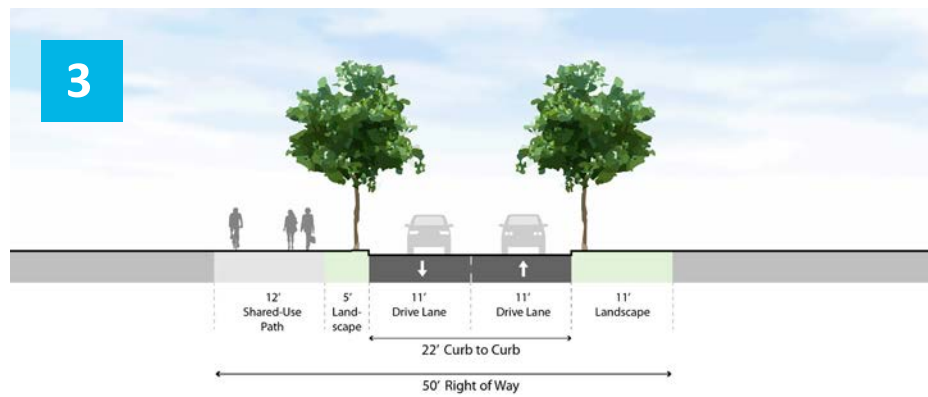

Mt. View Road

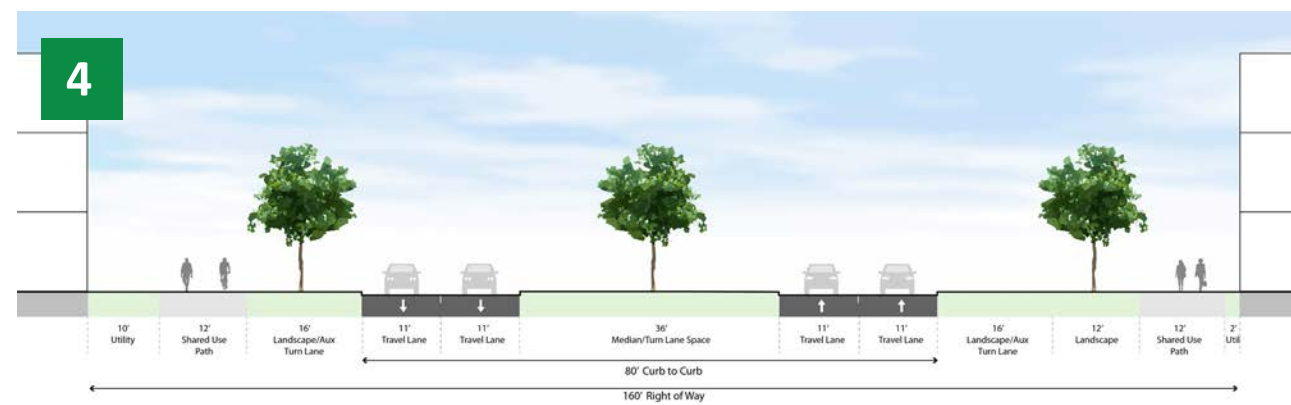

Bell Road

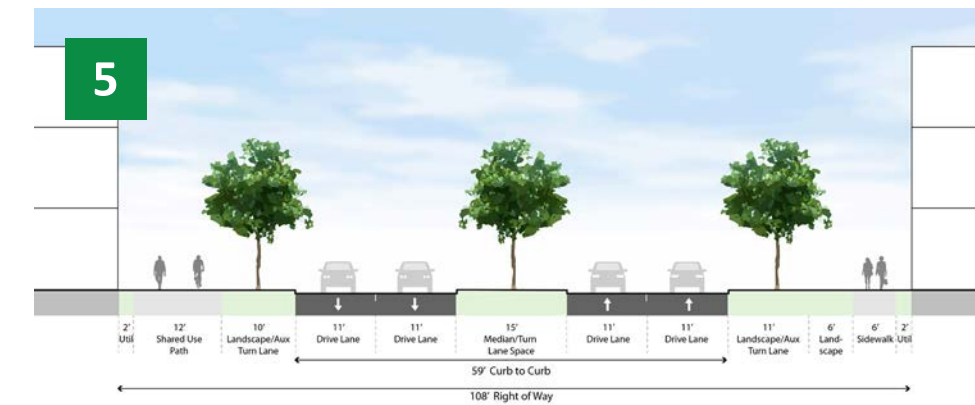

Hickory Hollow Parkway (Multilane)

SOUTHEAST TRANSIT CENTER

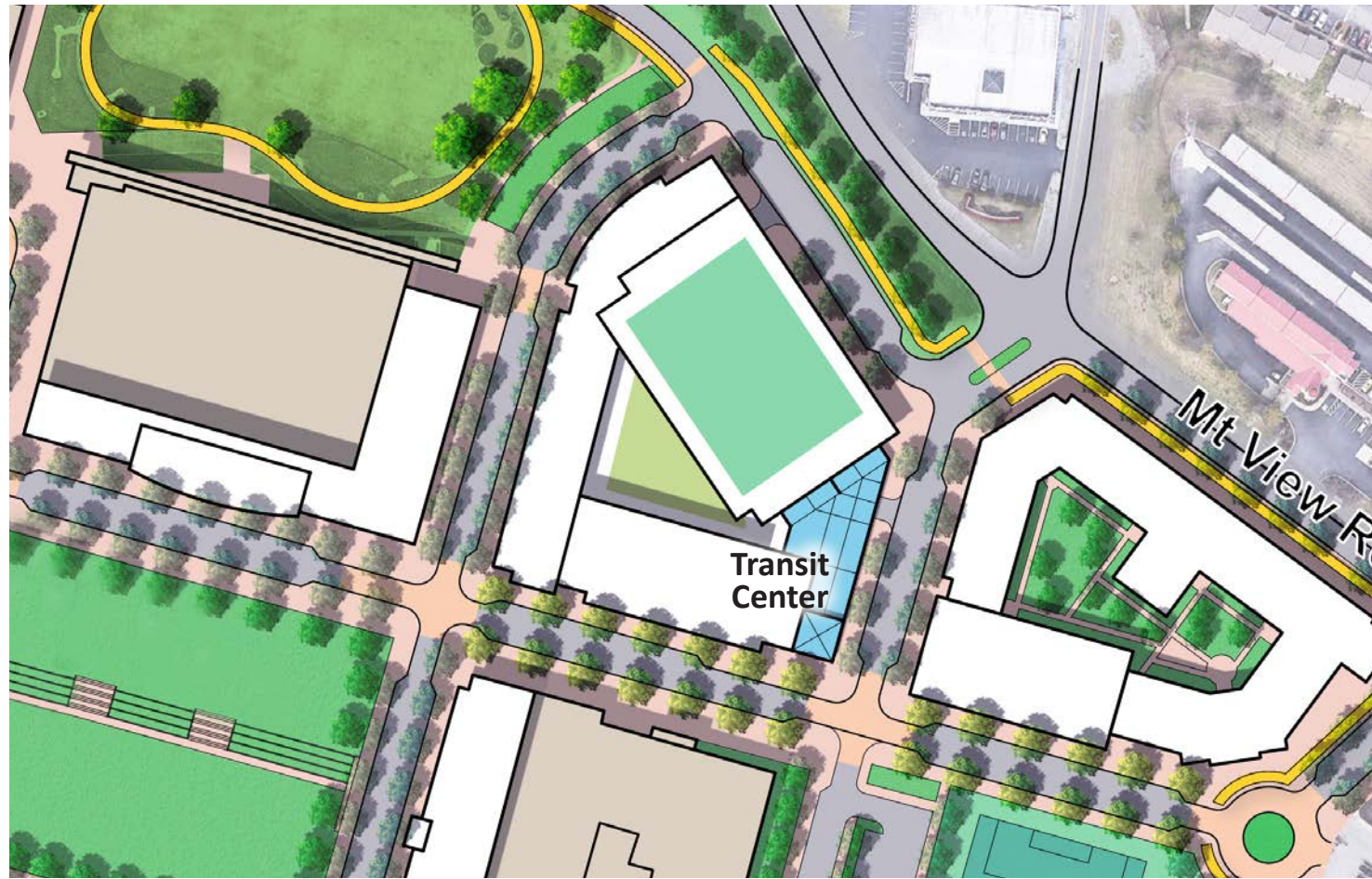

The Southeast Transit Center (STC) will serve as the southern terminus for WeGo's highest ridership bus route on the Murfreesboro Pike corridor, a corridor identified for future high-capacity transit service. It will be a safe, friendly location for community residents and transit passengers to access transit and comfortably and conveniently transfer between routes and modes.

The Southeast Transit Center (STC) will include:

- 4-6 bus bays with covered seating;
- Climate controlled waiting area with seating;
- Amenities including real-time bus arrival information, ticket vending machines, and Wi-Fi;
- Convenient 200-250 car park-and-ride facility with electric charging stations;
- Area for kiss-and-ride, taxi, and Transportation Network Company (TNC) pick-ups and drop-offs; and
- Safe pedestrian connections to adjacent land uses.



The core transit routes serving the Southeast Transit Center:

- Route 55 – Murfreesboro Pike (frequent service), every 15 minutes or less
- WeGo Link – Mobility on Demand service providing first/last mile connections to frequent service;
- New Connector Service – Connecting STC to other corridors and destinations like The Crossings and Century Farms; and
- New Express Routes – Express service operating between Downtown Nashville, STC, and Murfreesboro.

WeGo Public Transit is advancing “Neighborhood Transit Centers” to enhance our transit network and support travel outside of downtown. They provide for more direct travel, reduce travel time, and offer safe and comfortable facilities for making connections.

DRAFT PARKS & TRAILS CONCEPT - REGION



Greenways and Sidepaths

- Existing
- Proposed
- Parks Loop
- Local School

DRAFT PARKS & TRAILS CONCEPT - STUDY AREA

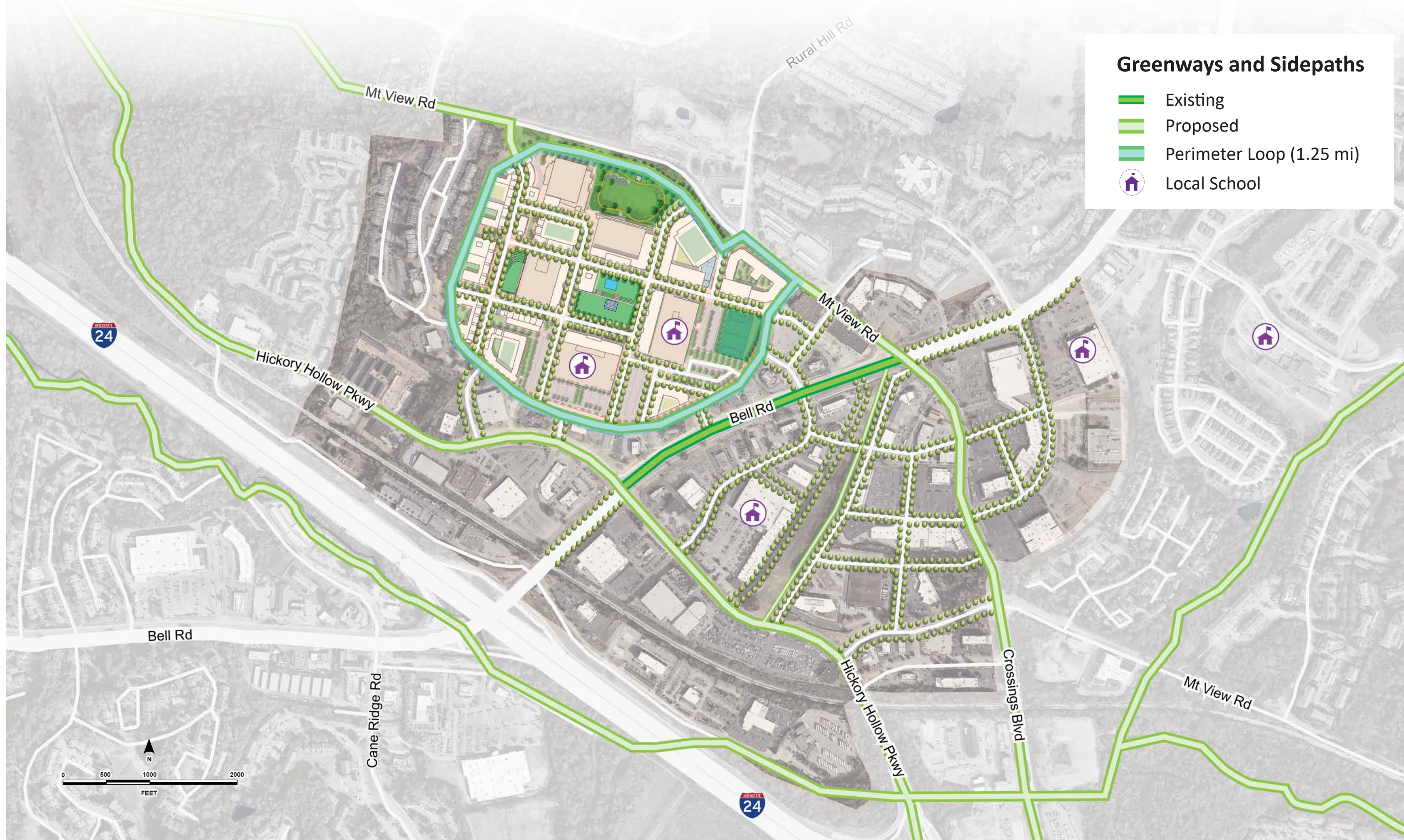

DRAFT STUDY AREA CONCEPT

Global Mall
Character
Area

Bell Road
Character
Area

Antioch Flex
Character
Area

Antioch
Mixed-Use
Character Area

- Existing Greenway/Sidepath
- Proposed Greenway/Sidepath
- Proposed Streets

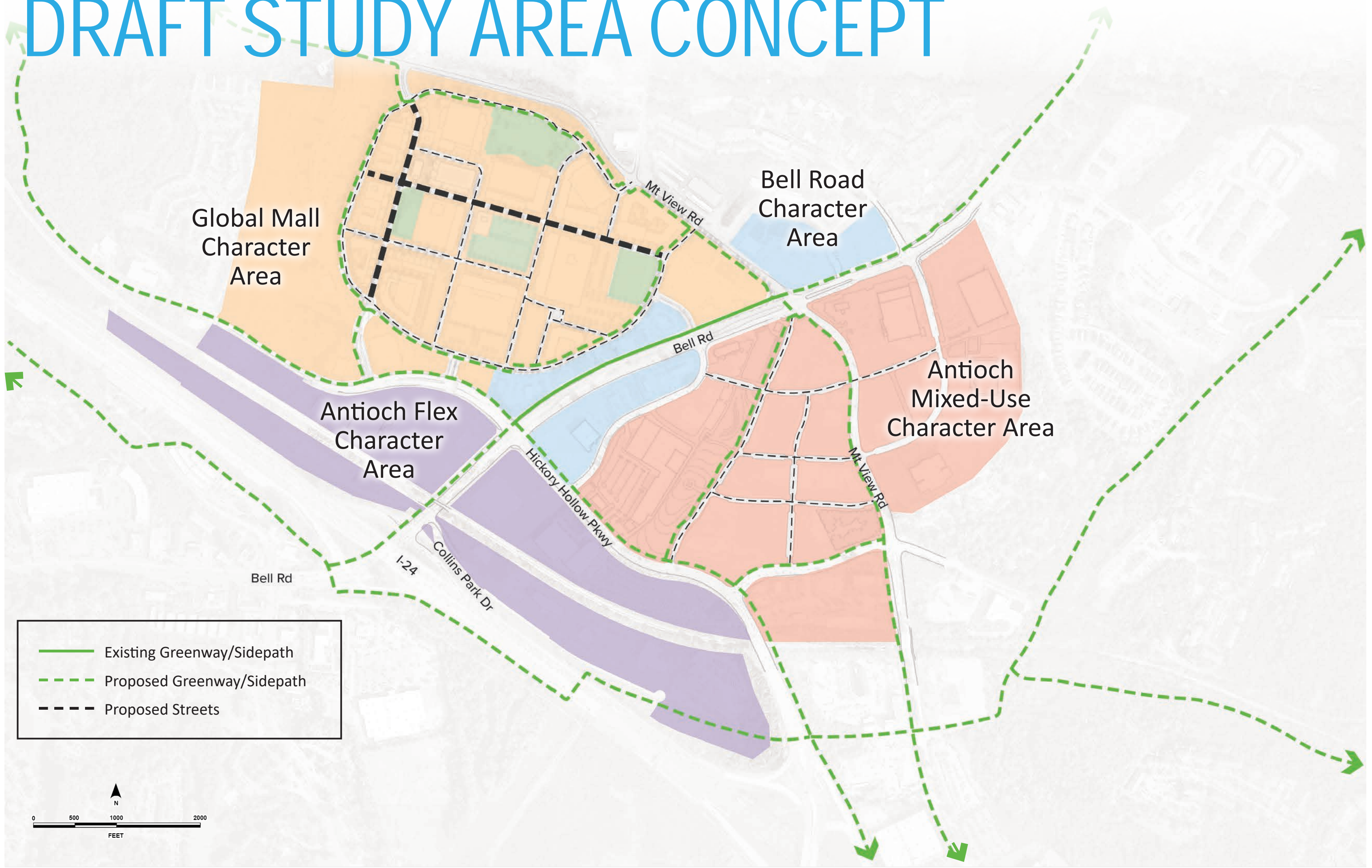
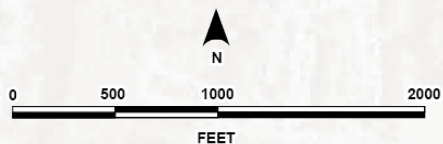

DRAFT DESIGN GUIDELINES

POTENTIAL FUTURE OPPORTUNITIES

Character Area #1 - Global Mall

Character Area #2 - Bell Road

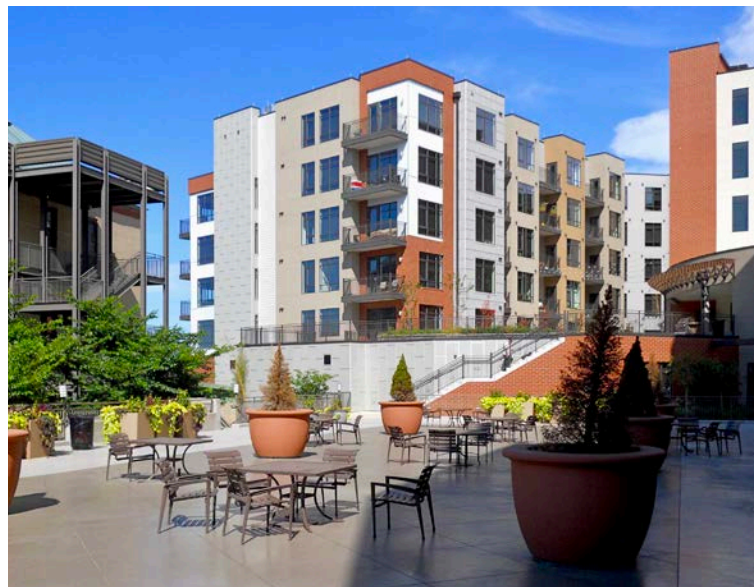

Building Heights (3-7 stories)



Large Public Square



Building Heights (4-12 stories)

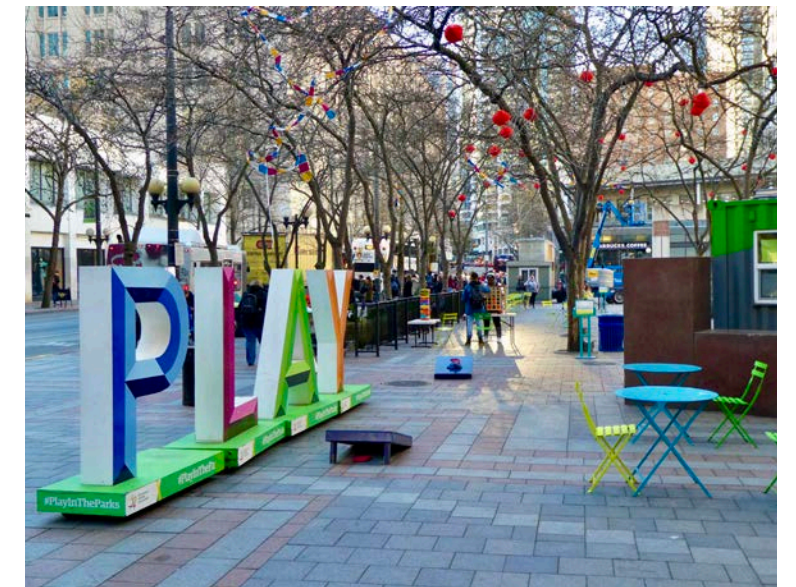

Small Public Plazas



Sidewalks & Outdoor Dining

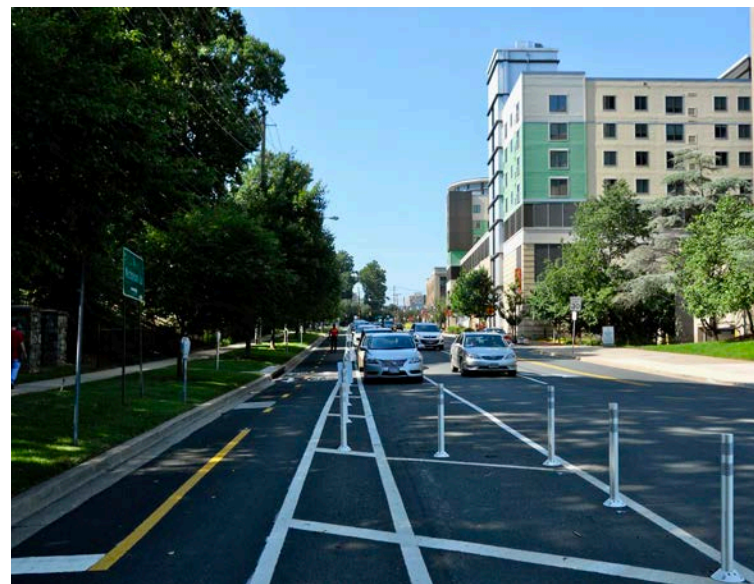

Protected Bike Lanes



Midblock Pedestrian Connections



Sidepaths

DRAFT DESIGN GUIDELINES

POTENTIAL FUTURE OPPORTUNITIES

Character Area #3 - Antioch Mixed Use

Character Area #4 - Antioch Flex



Building Heights (3-7 stories)



Pedestrian Promenades



Building Heights (1-7 stories)

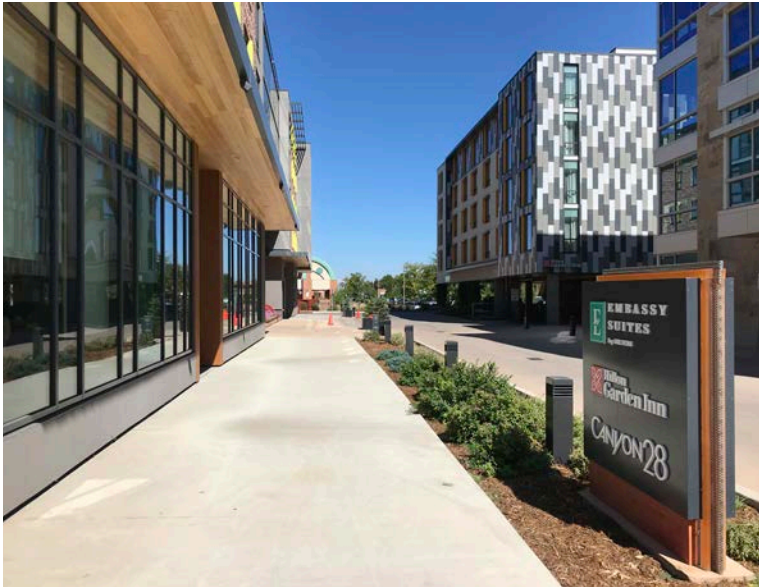

Midblock Pedestrian Connections



Sidewalks & Outdoor Dining



Protected Bike Lanes



Sidewalks & Landscape Buffer



Sidepaths

DRAFT PHASING DIAGRAM

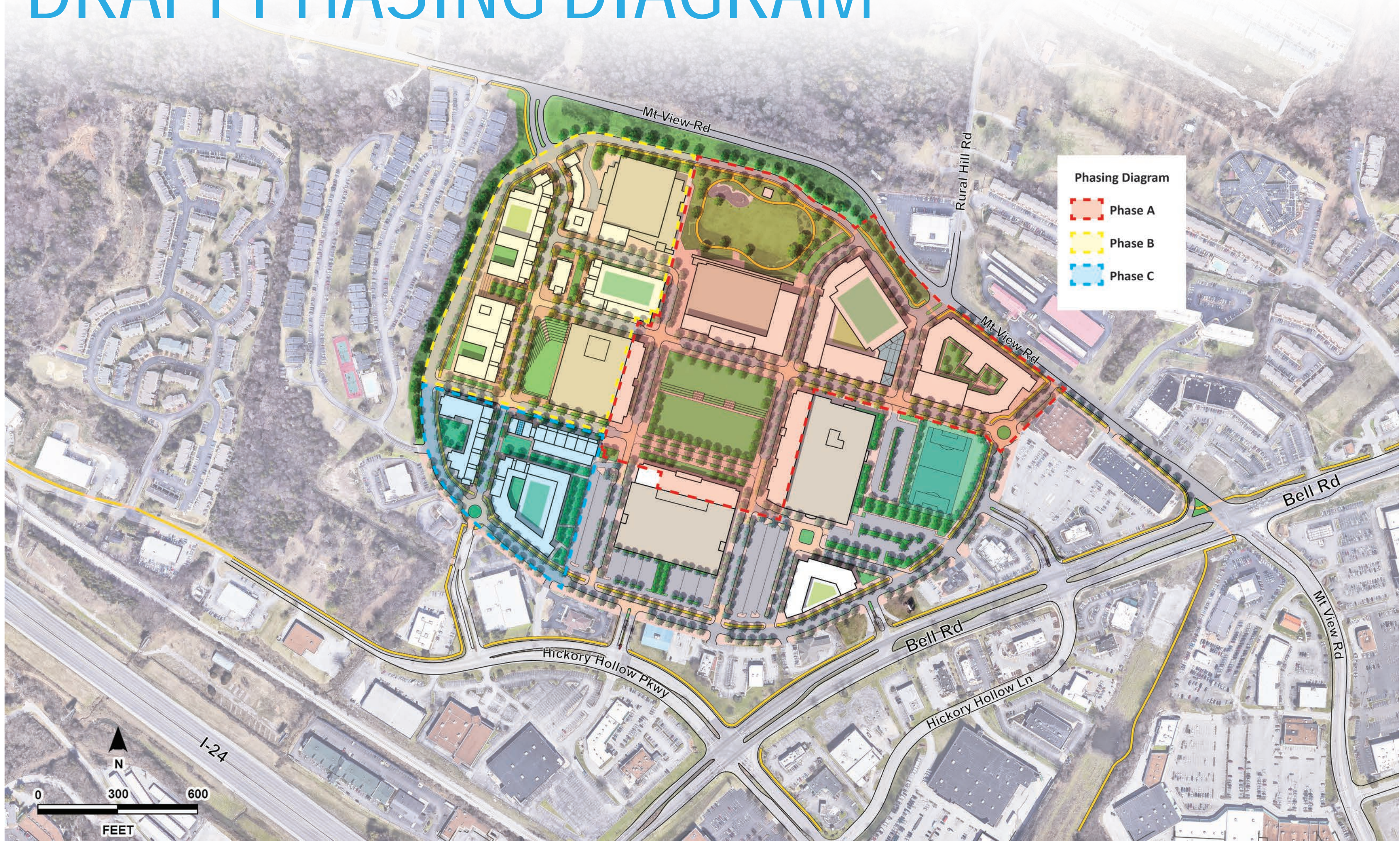

Phasing Diagram

- Phase A
- Phase B
- Phase C