

MULTIMODAL ACCESS CLOSURE EXCEPTION APPLICATION FORM AND CHECKLIST

Submittal Date: 9/3/2025 ☒ New Submittal ☐ Re-Submittal No: _____

Related Building Permit No: _____

Project Name: West Hillwood Drive - Stormwater System Improvements

Street Name Location: West Hillwood Drive

Between: 820 West Hillwood Drive And: 821 West Hillwood Drive

Applicant Name: Walker Building Group

Address: 2617 Locust Street

Phone: 615-829-1276 Fax: _____ Contact: Eric Ricker

Email: Ericker@walkerbuildinggroup.com

Project Description: Removal of 57LF double barrel 52"x30" CMP and Replacing it with a
43LF Slab Bridge with exposed deck

Start Date: 9/22/2025 End Date: 10/31/2025 Project Length: 39 Days

Describe Type of Closure: 24 Hour Full Road Closure during Removal of double barrel CMP
and replacing it with a new slab bridge spanning across West Hillwood Drive.

Provide Reasons why Project cannot be completed without closures and what other
options were considered (attach documents as needed): Excavation to demo the double
barrel CMP and install the new slab bridge will be 14ft wide. We would not be able to span that width
with steel street plates.

PROJECT INFORMATION CHECKLIST:

Included Not Applicable

- | | | |
|-------------------------------------|-------------------------------------|--|
| <input checked="" type="checkbox"/> | <input type="checkbox"/> | Project Vicinity Map with Project Area shown, street names, property information, existing pavement and striping, gutter and building locations, north arrow, and scale. |
| <input checked="" type="checkbox"/> | <input type="checkbox"/> | Planned work hours included. |
| <input checked="" type="checkbox"/> | <input type="checkbox"/> | Exact location and dimensions of the construction work zone shown. |
| <input checked="" type="checkbox"/> | <input type="checkbox"/> | If multiple phases are necessary, include perimeter impact of each phase, phase number, anticipated work hours and phase duration. |
| <input checked="" type="checkbox"/> | <input type="checkbox"/> | Details on construction activity and equipment being used as part of construction included for each phase. |
| <input checked="" type="checkbox"/> | <input type="checkbox"/> | Specify if any on-street parking, and/or metered parking, is to be restricted and if bus zone will need to be relocated. |
| <input checked="" type="checkbox"/> | <input type="checkbox"/> | Specify if trash pickup will be impacted. |
| <input checked="" type="checkbox"/> | <input type="checkbox"/> | Provide information on all utility work and utility connections. |
| <input checked="" type="checkbox"/> | <input type="checkbox"/> | List all affected residents, businesses, agencies, and schools and any conversations/agreements taken place. |
| <input type="checkbox"/> | <input checked="" type="checkbox"/> | Show ongoing construction projects within vicinity of proposed project impact. |
| <input type="checkbox"/> | <input checked="" type="checkbox"/> | Provide plan to address conflicts with other nearby projects. |
| <input checked="" type="checkbox"/> | <input type="checkbox"/> | Provide traffic control plan for each phase of construction (see traffic control checklist for more information). |
| <input checked="" type="checkbox"/> | <input type="checkbox"/> | Provide information on work vehicle parking locations. |
| <input checked="" type="checkbox"/> | <input type="checkbox"/> | Show construction trucks ingress/egress to project location. |
| <input checked="" type="checkbox"/> | <input type="checkbox"/> | Provide information on any traffic signals, traffic signal loops, and traffic signal cabinets in close proximity to project. |

TRAFFIC CONTROL PLAN CHECKLIST:

Included Not Applicable

- | | | |
|-------------------------------------|--------------------------|---|
| <input checked="" type="checkbox"/> | <input type="checkbox"/> | All temporary traffic control plans shall be designed in accordance with the most recent ADA regulations and requirements of the Manual of Uniform Traffic Control Devices. |
| <input checked="" type="checkbox"/> | <input type="checkbox"/> | Clearly show the locations of all existing signs (including speed limit) as well as the proposed signs for each construction phase. |
| <input checked="" type="checkbox"/> | <input type="checkbox"/> | Show the location of all existing pedestrian paths and pedestrian detour route of each stage of construction. |
| <input checked="" type="checkbox"/> | <input type="checkbox"/> | Show dimensions of travel lane width, shoulder width, sidewalk of each phase, and overall roadway width along the length of affected area. |
| <input checked="" type="checkbox"/> | <input type="checkbox"/> | Show all existing striping and markings to remain, to be removed, and all proposed striping and markings for each construction stage. |
| <input checked="" type="checkbox"/> | <input type="checkbox"/> | Provide detour plan clearly showing detour route for any roadway or pedestrian/bike path closures. |
| <input checked="" type="checkbox"/> | <input type="checkbox"/> | Specify placement of all temporary traffic control devices. |
| <input checked="" type="checkbox"/> | <input type="checkbox"/> | Specify spacing of all temporary traffic control devices. |
| <input checked="" type="checkbox"/> | <input type="checkbox"/> | Show all existing traffic signals and streetlights in the work zone location. |
| <input checked="" type="checkbox"/> | <input type="checkbox"/> | Lighting provided for all pedestrian detour routes. |
| <input checked="" type="checkbox"/> | <input type="checkbox"/> | Provide minimum eleven (11) foot travel lanes at all times. |
| <input checked="" type="checkbox"/> | <input type="checkbox"/> | Show size, height, and location of all channelizing devices, warning lights, flag trees, barriers, etc. |
| <input checked="" type="checkbox"/> | <input type="checkbox"/> | Label all taper lengths and widths. |
| <input checked="" type="checkbox"/> | <input type="checkbox"/> | Provide locations of police officers for each phase as needed. |
| <input checked="" type="checkbox"/> | <input type="checkbox"/> | Temporary Traffic Control Plan has been stamped and signed by a TN licensed Civil Engineer. |

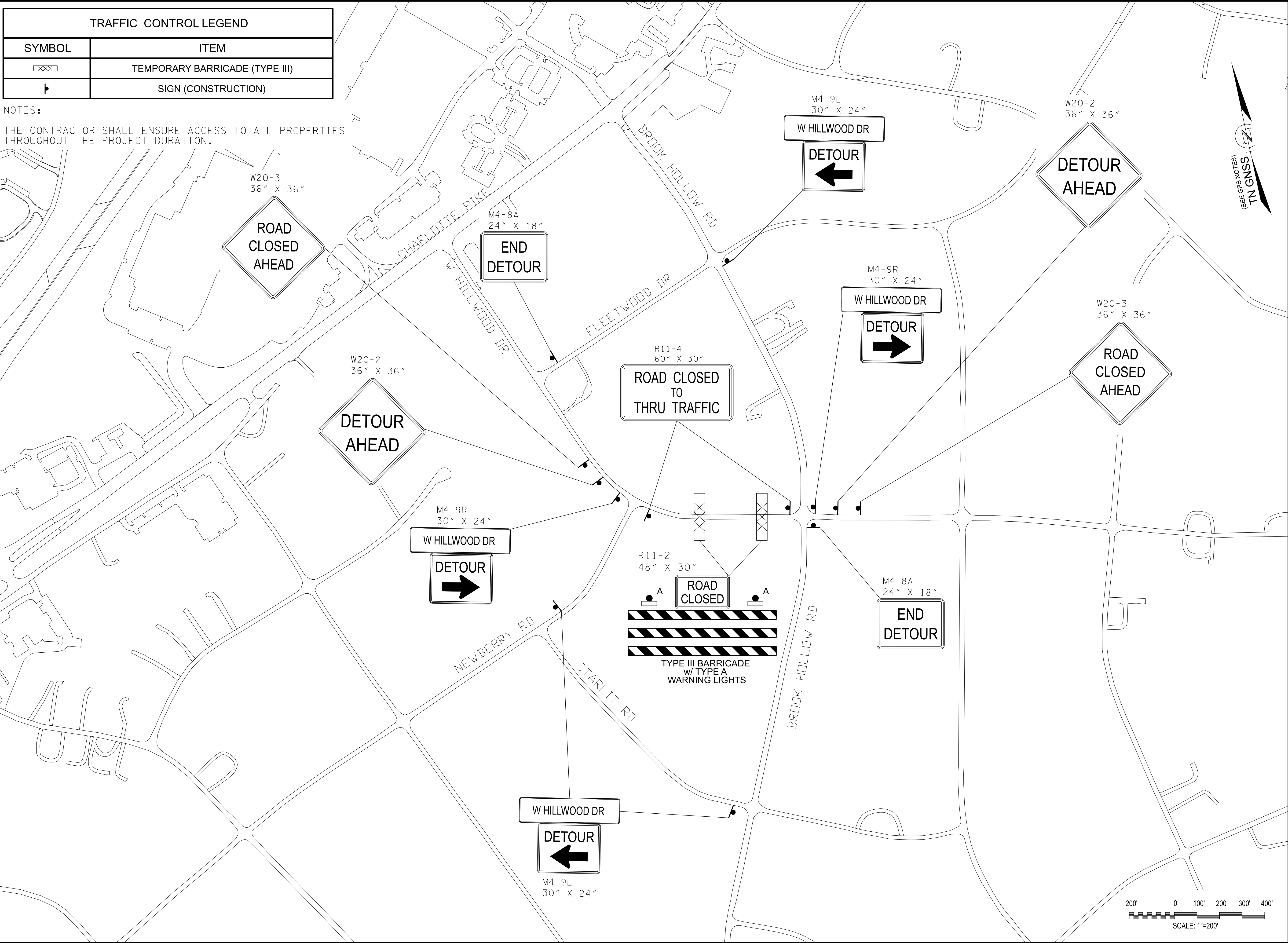

FILE NO.	WEST HILLWOOD DRIVE
DATE:	05-22-2024
DESIGNED BY:	SNA
DRAWN BY:	SNA
CHECKED BY:	DWG
REVISION BLOCK	
DATE:	
DATE:	
DATE:	

CONSOR ENGINEERS, LLC

101 WESTPARK DRIVE, SUITE 300

BRENTWOOD, TN 37027

(615)-425-2000

SEALED BY

DOUGLAS W. GUTHRIE

REGISTERED ENGINEER

AGRICULTURE

COMMERCIAL

STATE OF TENNESSEE

05/25/2024

METROPOLITAN GOVERNMENT

OF NASHVILLE & DAVIDSON COUNTY, TENNESSEE

METRO WATER SERVICES

STORMWATER DIVISION

WEST HILLWOOD DRIVE

STORMWATER IMPROVEMENTS

TRAFFIC CONTROL PLAN

SCALE: 1" = 200'

SHEET 07 OF 10