

MULTIMODAL ACCESS CLOSURE EXCEPTION APPLICATION FORM AND CHECKLIST

Submittal Date: 10/3/25 ☒ New Submittal ☐ Re-Submittal No: _____

Related Building Permit No: CACN T2025059196

Project Name: Vanderbilt Hawkins Field Renovation - Phase 1

Street Name Location: 25th Ave S

Between: Garland Ave And: Highland Ave

Applicant Name: James Ring

Address: 401 Church St, Ste #2200 Nashville, TN 37219

Phone: 864.884.9078 Contact: _____

Email: james.ring@mortenson.com

Project Description: Vanderbilt University Hawkins baseball field renovation.
West side of 25th Ave will be shut down along the sidewalk.

Start Date: 10/13/25 End Date: 11/1/26 Project Length: 16 months

Describe Type of Closure: Sidewalk partial closure

Provide Reasons why Project cannot be completed without closures and what other options were considered (attach documents as needed): _____

Extent of new building runs along sidewalk edge, sidewalk
will be needed for public safety and constructibility.

PROJECT INFORMATION CHECKLIST:

Included

- ☒ Project Vicinity Map with Project Area shown, street names, property information, existing pavement and striping, gutter and building locations, north arrow, and scale.
- ☐ Planned work hours included.
- ☐ **NA** Exact location, dimensions and excavation depths of the construction work zone shown
- ☐ **NA** If multiple phases are necessary, include perimeter impact of each phase, phase number, anticipated work hours and phase duration.
- ☐ **NA** Details on construction activity and equipment being used as part of construction included for each phase.
- ☐ **NA** Specify if any on-street parking, and/or metered parking, is to be restricted and if bus zone will need to be relocated.
- ☐ **NA** Specify if trash pickup will be impacted.
- ☐ **NA** Provide information and plans for all utility work and utility connections.
- ☐ **NA** List all affected residents, businesses, agencies, and schools and any conversations/agreements taken place.
- ☐ **NA** Show ongoing construction projects within vicinity of proposed project impact and plan to address conflicts
- ☒ Provide traffic control plan for each phase of construction (see traffic control checklist for more information).
- ☐ **NA** Provide information on your and subcontractor's work vehicle parking locations.
- ☐ **NA** Show construction trucks ingress/egress to project location.
- ☐ **NA** Provide information on any traffic signals, traffic signal loops, and traffic signal cabinets in close proximity to project.

PROJECT INFORMATION CHECKLIST (Continued):

Included

- ☒ Display the locations of all poles, mailboxes, and signs impacted by the project.
- ☒ Document existing conditions around the job site, including pavement, curb, gutter, and crosswalks.
- ☐ **NA** Show fire department connection (FDC) locations for the building and outline clear emergency access routes.
- ☒ Identify provisions to maintain sightlines for traffic at intersections where impacted by construction fencing.
- ☐ **NA** Show proposed locations of any job trailers or dumpsters to be located in the ROW.
- ☐ **NA** Provide concrete pouring locations, timing, and staging plans for concrete trucks.

TRAFFIC CONTROL PLAN CHECKLIST:

Included

- ☒ All temporary traffic control plans shall be designed in accordance with the most recent ADA regulations and requirements of the Manual of Uniform Traffic Control Devices (MUTCD).
- ☒ Clearly show the locations of all existing signs (including speed limit) as well as the proposed signs for each construction phase.
- ☒ Show the location of all existing pedestrian paths and pedestrian detour route of each stage of construction.
- ☒ Show dimensions of travel lane width, shoulder width, sidewalk of each phase, and overall roadway width along the length of affected area.
- ☐ **NA** Show all existing striping and markings to remain, to be removed, and all proposed striping and markings for each construction stage.
- ☒ Provide detour plan clearly showing detour route for any roadway or pedestrian/bike path closures.
- ☒ Specify placement and spacing of all temporary traffic control devices.
- ☒ Show all existing traffic signals and streetlights in the work zone location.
- ☒ Lighting provided for all pedestrian detour routes.
- ☐ **NA** Provide minimum eleven (11) foot travel lanes at all times.
- ☒ Show size, height, and location of all channelizing devices, warning lights, flag trees, barriers, etc.
- ☒ Label all taper lengths and widths.
- ☒ Provide locations of police officers for each phase as needed.
- ☐ Temporary Traffic Control Plan has been stamped and signed by a TN licensed Civil Engineer.

**PENDING
(KCI)**

TRAFFIC CONTROL PLANS

VANDERBILT HAWKINS FIELD RENOVATION – PHASE 1

25TH AVENUE S – HIGHLAND AVENUE TO GARLAND AVENUE (SIDEWALK WIDTH REDUCTION)

INDEX OF SHEETS CONSTRUCTION

SHEET NO.	DESCRIPTION
1	TITLE SHEET
2	TRAFFIC CONTROL PLAN – PEDESTRIAN DETOUR
3	TRAFFIC CONTROL NOTES AND ESTIMATED QUANTITIES

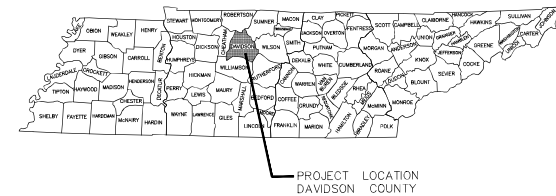

PROJECT
LOCATION

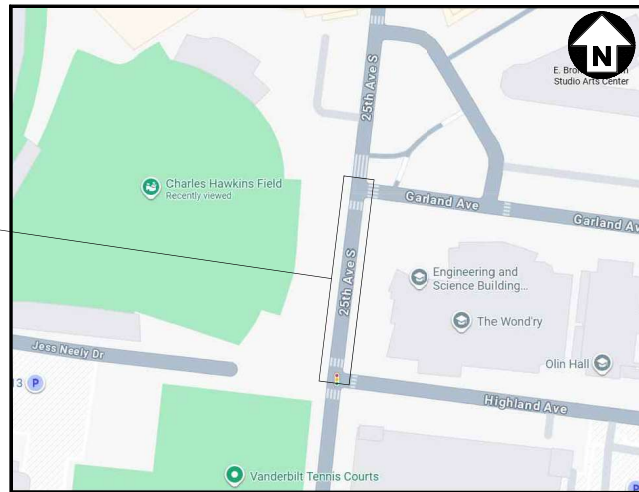

LOCATION MAP
NOT TO SCALE

25TH AVENUE S – 25 MPH POSTED SPEED LIMIT

SPECIAL NOTE

THIS PROJECT TO BE CONSTRUCTED UNDER THE STANDARD SPECIFICATIONS OF THE TENNESSEE DEPARTMENT OF TRANSPORTATION DATED: JANUARY 1, 2021 AND ADDITIONAL SPECIFICATIONS AND SPECIAL PROVISIONS CONTAINED IN THE PLANS AND THE PROPOSAL CONTRACT.

SPECIAL NOTE:
THE BASE SURVEY AND DESIGN INFORMATION FOR ROADWAY AND UTILITIES PRESENTED ON THIS PLAN WERE PROVIDED TO KCI TECHNOLOGIES, INC. BY MORTENSON. WHERE AVAILABLE, BASE INFORMATION HAS BEEN SUPPLEMENTED BY PLANS OBTAINED FROM MORTENSON, AND FIELD OBSERVATIONS BY THE ENGINEER. KCI TECHNOLOGIES, INC. MAKES NO CLAIMS AS TO THE COMPLETENESS OR ACCURACY OF THE PROVIDED BASE INFORMATION.

DESIGNED BY KCI TECHNOLOGIES, INC.

DESIGNER MATTHEW THERIOT, PE

P.E. NO. 124090

FILE NO.	52410_001
DATE:	10/06/25
DESIGNED BY:	MAT
DRAWN BY:	DW
CHECKED BY:	JMC

REVISION BLOCK

DATE:		



ALL CONSTRUCTION ACTIVITIES SHALL BE COMPLETED IN FULL COMPLIANCE WITH THE AMERICANS WITH DISABILITIES ACT (ADA) AND ARCHITECTURAL AND TRANSPORTATION BARRIERS COMPLIANCE BOARD, FEDERAL REGISTER, 50 CFR PARTS 1190 AND 1191, ACCESSIBILITY GUIDELINES FOR BUILDINGS AND FACILITIES, ARCHITECTURAL BARRIERS ACT (ABA) ACCESSIBILITY GUIDELINES, PROPOSED RULE, PUBLISHED IN THE FEDERAL REGISTER ON JULY 23, 2004, AS HAS BEEN ADOPTED BY METRO.

ACCEPTED BY : _____

DATE : _____

T.D.O.T. STANDARD DRAWINGS

RD11-SD-1	INTERSECTION SIGHT DISTANCE DESIGN AND GENERAL NOTES
RD-A-1	STANDARD ABBREVIATIONS
RD-L-1	STANDARD LEGEND
S-CZ-1	CLEAR ZONE CRITERIA
T-M-1	DETAILS OF PAVEMENT MARKINGS FOR CONVENTIONAL ROADS AND MARKING ABBREVIATIONS
T-S-9	STANDARD LAYOUT GROUND MOUNTED SIGNS
T-S-16	GROUND MOUNTED ROADSIDE SIGN PLACEMENT DETAILS
T-S-16A	GROUND MOUNTED ROADSIDE SIGN PLACEMENT DETAILS
T-S-17	STANDARD GROUND MOUNTED SIGN USING PERFORATED/KNOCKOUT SQUARE TUBE
T-S-18	END OF ROADWAY AND DEAD END SIGNS, METAL BARRICADES (TYPE 1)
T-S-20	SIGN DETAILS
T-WZ-55	SIDEWALK TRAFFIC CONTROL

N.D.O.T. TYPICALS FOR TRAFFIC CONTROL

*TA-28	SIDEWALK CLOSURE DIVERSION
*TA-47	BIKE LANE CLOSURE WITHOUT A DETOUR



TITLE
SHEET

VANDERBILT HAWKINS FIELD
RENOVATION - PHASE 1

N.T.S.

SHEET 1

TRAFFIC CONTROL PLAN - PEDESTRIAN DETOUR

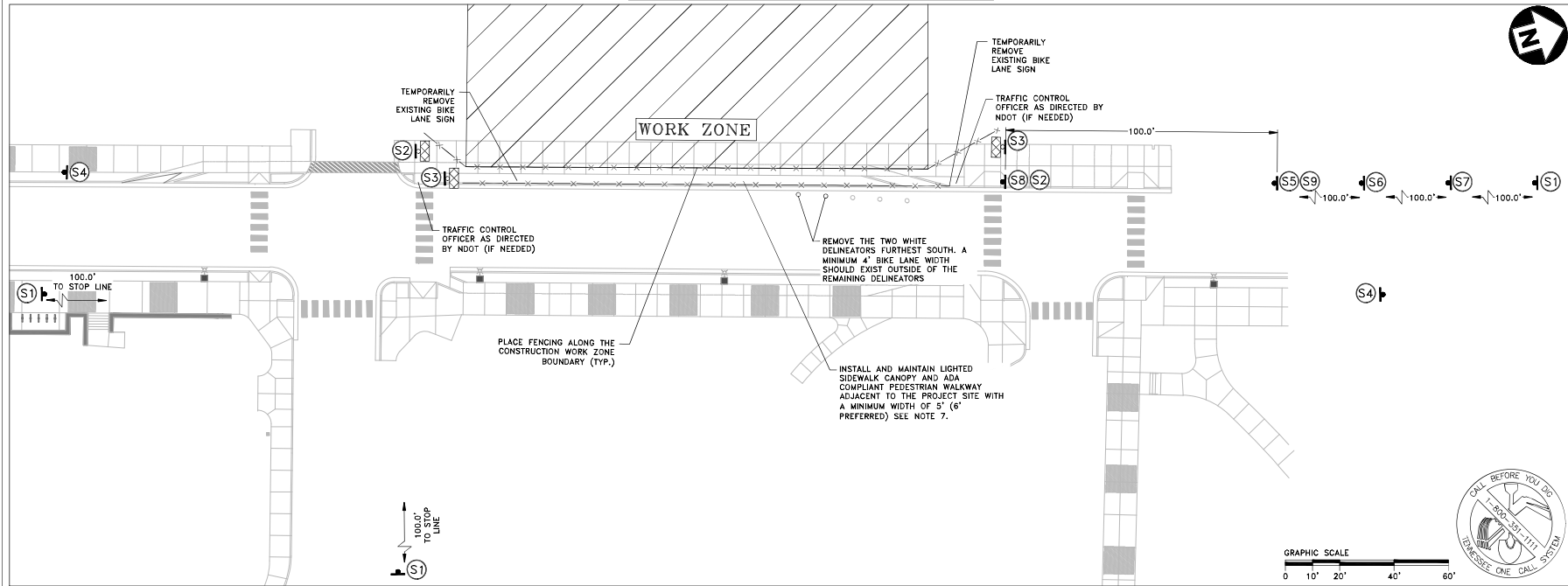

TRAFFIC CONTROL SIGNS (NEW)



NOTES:

1. CONTRACTOR SHALL REINSTALL ALL EXISTING TRAFFIC CONTROL (SIGNS AND PAVEMENT MARKINGS) TO IT'S ORIGINAL OR PROPOSED CONDITION ONCE THE TEMPORARY CLOSURE IS COMPLETED AND TEMPORARY TRAFFIC CONTROL IS REMOVED.
2. AS NEEDED, QUALIFIED FLAGGERS OR POLICE OFFICERS TRAINED IN PROCEDURES DETAILED IN THE MANUAL ON UNIFORM TRAFFIC CONTROL DEVICES (MUTCD) SHALL BE STATIONED AT EACH END OF TEMPORARY CLOSURES TO CONTROL ALL VEHICULAR, PEDESTRIAN, AND BICYCLE TRAFFIC. FLAGGERS SHALL PROVIDE PRIORITY ACCESS FOR EMERGENCY VEHICLES.
3. EMERGENCY VEHICLE ACCESS SHALL BE MAINTAINED AT ALL TIMES.
4. CONTRACTOR IS RESPONSIBLE FOR SECURING THE WORK ZONE AND EXCAVATIONS FROM VEHICLES, PEDESTRIANS, AND CYCLISTS AT ALL TIMES.
5. SIGNS S1, S2, S3, S4, S5, S7 & S9 SHALL HAVE BLACK LEGEND ON AN ORANGE BACKGROUND.
6. EXISTING INTERSECTION CURB RAMP AND LEVEL LANDINGS SHALL REMAIN OPEN DURING CONSTRUCTION.
7. SIDEWALK CANOPY SHALL BE CONSTRUCTED WITH SCAFFOLDING APPROVED BY NDOT AND BE STRUCTURALLY CAPABLE OF PROTECTING PEDESTRIANS FROM FALLING DEBRIS. INSTALLATION OF THE SIDEWALK CANOPY IS REQUIRED PRIOR TO ANY CONSTRUCTION ABOVE THE EXISTING SIDEWALK GRADE. UNTIL CONSTRUCTION ABOVE THE EXISTING SIDEWALK OCCURS, FENCING MAY BE USED WITHOUT SIDEWALK CANOPIES.
8. TEMPORARY ADVANCED WARNING SIGNS SHALL NOT OBSTRUCT EXISTING DRIVEWAYS.

SPECIAL NOTE:

THE BASE SURVEY AND DESIGN INFORMATION FOR ROADWAY AND UTILITIES PRESENTED ON THIS PLAN WERE PROVIDED TO KCI TECHNOLOGIES, INC. BY MORTENSON. WHERE AVAILABLE, BASE INFORMATION HAS BEEN SUPPLEMENTED BY PLANS OBTAINED FROM MORTENSON AND FIELD OBSERVATIONS BY THE ENGINEER. KCI TECHNOLOGIES, INC. MAKES NO CLAIMS AS TO THE COMPLETENESS OR ACCURACY OF THE PROVIDED BASE INFORMATION.

LEGEND

	CONSTRUCTION SIGN W/ NUMBER (NEW)
	TEMPORARY BARRICADE W/ SIGN (TYPE I) (NEW)
	CONSTRUCTION WORK ZONE (NEW)
	OVERHEAD CANOPY & FENCING STRUCTURE (NEW)
	DELINEATORS (WHITE, EXISTING)

TYPICAL SECTION A-A

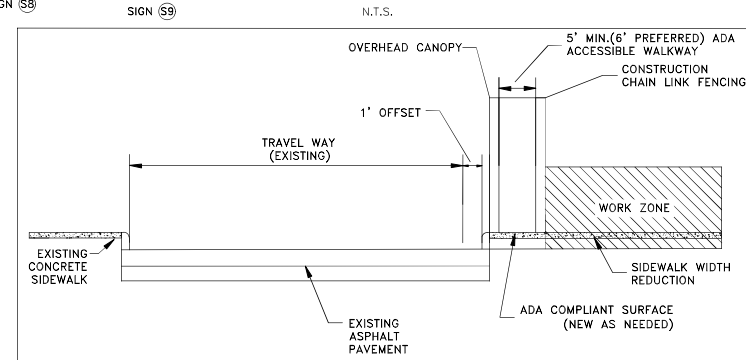

FILE NO.	S2410_001
DATE:	10/06/25
DESIGNED BY:	MAT
DRAWN BY:	DW
CHECKED BY:	JMC

REVISION BLOCK

DATE:		



ALL CONSTRUCTION ACTIVITIES SHALL BE COMPLETED IN FULL COMPLIANCE WITH THE AMERICANS WITH DISABILITIES ACT (ADA) AND ARCHITECTURAL AND TRANSPORTATION BARRIERS COMPLIANCE BOARD, FEDERAL REGISTER 56, 274 PARTS 1190 AND 1191, ACCESSIBILITY GUIDELINES FOR BUILDINGS AND FACILITIES, ARCHITECTURAL BARRIERS ACT (ABA) ACCESSIBILITY GUIDELINES, PROPOSED RULE. PUBLISHED IN THE FEDERAL REGISTER ON JULY 23, 2004, AS HAS BEEN ADOPTED BY METRO.



TRAFFIC CONTROL PLAN - PEDESTRIAN DETOUR

VANDERBILT HAWKINS FIELD RENOVATION - PHASE 1

SCALE: 1"=20'

SHEET 2

TRAFFIC CONTROL NOTES

GENERAL

1. NOTHING IN THE GENERAL NOTES OR SPECIAL PROVISIONS SHALL RELIEVE THE CONTRACTOR FROM HIS RESPONSIBILITIES TOWARD THE SAFETY AND CONVENIENCE OF THE GENERAL PUBLIC AND THE RESIDENTS ALONG THE PROPOSED CONSTRUCTION AREA.
2. ALL CONSTRUCTION, EQUIPMENT, AND INSTALLATION PROCEDURES SHALL COMPLY WITH THE TENNESSEE DEPARTMENT OF TRANSPORTATION (TDOT) STANDARD SPECIFICATIONS FOR ROAD AND BRIDGE CONSTRUCTION, (AS AMENDED) AND WITH THE CURRENT STANDARDS AND SPECIFICATIONS OF METRO PUBLIC WORKS. PAVEMENT MARKING REMOVAL AND TRAFFIC CONTROL SHALL COMPLY WITH SECTION 712-TEMPORARY TRAFFIC CONTROL.

TEMPORARY TRAFFIC CONTROL

3. ADVANCED WARNING SIGNS SHALL NOT BE DISPLAYED MORE THAN FORTY-EIGHT (48) HOURS BEFORE PHYSICAL CONSTRUCTION BEGINS. SIGNS MAY BE ERECTED UP TO ONE WEEK BEFORE NEEDED, IF THE SIGN FACE IS FULLY COVERED.
4. IF THE CONTRACTOR MOVES OFF THE PROJECT, HE SHALL COVER OR REMOVE ALL UNNEEDED SIGNS AS DIRECTED BY THE ENGINEER. COSTS OF REMOVAL, COVERING, AND REINSTALLING SIGNS SHALL NOT BE MEASURED AND PAID FOR SEPARATELY, BUT ALL COST SHALL BE INCLUDED IN THE ORIGINAL UNIT PRICE BID FOR ITEM NO 712-06, SIGNS (CONSTRUCTION) PER SQUARE FOOT.
5. A LONG TERM BUT SPORADIC USE WARNING SIGN, SUCH AS A FLAGGER SIGN, MAY REMAIN IN PLACE WHEN NOT REQUIRED PROVIDED THE SIGN FACE IS FULLY COVERED.
6. TRAFFIC CONTROL DEVICES SHALL NOT BE DISPLAYED OR ERECTED UNLESS RELATED CONDITIONS ARE PRESENT NECESSITATING WARNING.
7. USE OF BARRICADES, PORTABLE BARRIER RAILS, VERTICAL PANELS, AND DRUMS SHALL BE LIMITED TO THE IMMEDIATE AREAS OF CONSTRUCTION WHERE A HAZARD IS PRESENT. THESE DEVICES SHALL NOT BE STORED ALONG THE ROADWAY WITHIN THIRTY (30) FEET OF THE EDGE OF THE TRAVELED WAY BEFORE OR AFTER USE UNLESS PROTECTED BY GUARDRAIL, BRIDGE RAIL, AND/OR BARRIERS INSTALLED FOR OTHER PURPOSES FOR ROADWAYS WITH CURRENT ADTS LESS THAN 1500 AND DESIGN SPEED OF LESS THAN 60 MPH. THIS DISTANCE SHALL INCREASE TO FORTY-FIVE (45) FEET FOR ROADWAYS WITH CURRENT ADTS OF 1500 OR GREATER AND DESIGN SPEED OF 60 MPH OR GREATER OR ON THE OUTSIDE OF A HORIZONTAL CURVE. THESE DEVICES SHALL BE REMOVED FROM THE CONSTRUCTION WORK ZONE WHEN THE ENGINEER DETERMINES THEY ARE NO LONGER NEEDED. WHERE THERE IS INSUFFICIENT RIGHT-OF-WAY TO PROVIDE FOR THIS REQUIRED SETBACK, THE CONTRACTOR SHALL DETERMINE THE ALTERNATE LOCATIONS AND REQUEST THE ENGINEER'S APPROVAL TO USE THEM.
8. THE CONTRACTOR SHALL NOT BE PERMITTED TO PARK ANY VEHICLES OR CONSTRUCTION EQUIPMENT DURING PERIODS OF INACTIVITY, WITHIN THIRTY (30) FEET OF THE EDGE OF PAVEMENT WHEN THE LANE IS OPEN TO TRAFFIC, UNLESS PROTECTED BY GUARDRAIL, BRIDGE RAIL, AND/OR BARRIERS INSTALLED FOR OTHER PURPOSES FOR ROADWAYS WITH CURRENT ADTS LESS THAN 1500 AND DESIGN SPEED LESS THAN 60 MPH. THIS DISTANCE SHALL BE INCREASED TO FORTY-FIVE (45) FEET FOR ROADWAYS WITH CURRENT ADTS OF 1500 OR GREATER AND DESIGN SPEED OF 60 MPH OR GREATER OR ON THE OUTSIDE OF A HORIZONTAL CURVE. PRIVATELY OWNED VEHICLES SHALL NOT BE ALLOWED TO PARK WITHIN THIRTY (30) FEET OF AN OPEN TRAFFIC LANE AT ANY TIME UNLESS PROTECTED AS DESCRIBED ABOVE. WHERE THERE IS INSUFFICIENT RIGHT-OF-WAY TO PROVIDE FOR THIS 30 FOOT SETBACK, THE CONTRACTOR SHALL DETERMINE THE ALTERNATE LOCATIONS AND REQUEST THE ENGINEER'S APPROVAL TO USE THEM.
9. ALL DETOUR AND CONSTRUCTION SIGNING SHALL BE IN STRICT ACCORDANCE WITH THE MANUAL ON UNIFORM TRAFFIC CONTROL DEVICES.
10. ALL DETOURS SHALL BE PAVED, STRIPED, SIGNED AND THE VERTICAL PANELS ARE TO BE IN PLACE BEFORE IT IS OPEN TO TRAFFIC.

11. ALL CONSTRUCTION ACTIVITIES SHALL BE COMPLETED IN FULL COMPLIANCE WITH THE AMERICANS WITH DISABILITIES ACT (ADA) AND ARCHITECTURAL AND TRANSPORTATION BARRIERS COMPLIANCE BOARD, FEDERAL REGISTER 36 CFR PARTS 1190 AND 1191, ACCESSIBILITY GUIDELINES FOR BUILDINGS AND FACILITIES, ARCHITECTURAL BARRIERS ACT (ABA) ACCESSIBILITY GUIDELINES, PROPOSED RULE, PUBLISHED IN THE FEDERAL REGISTER ON JULY 23, 2004, AS HAS BEEN ADOPTED BY METRO.

ESTIMATED ROADWAY QUANTITIES

ITEM NO.	DESCRIPTION	UNIT	QUANTITY
712-01	TRAFFIC CONTROL	L.S.	1
(2) 712-08.01	UNIFORMED POLICE OFFICER	HOUR	TBD
(3) 707-08.01	FENCE	L.F.	250
(1) 712-06	SIGNS (CONSTRUCTION)	S.F.	71
712-07.01	TEMPORARY BARRICADES (TYPE I)	L.F.	18
717-01	MOBILIZATION	L.S.	1

FOOTNOTES:

- (1) SEE SUMMARY OF ITEM 712-06 FOR DETAILS OF CONSTRUCTION SIGNS (THIS SHEET).
- (2) TRAFFIC CONTROL OFFICER AS DIRECTED BY NDOT (IF NEEDED)
- (3) ITEM INCLUDES OVERHEAD PEDESTRIAN CANOPY, FENCING, & LIGHTING OF WALKWAY

SUMMARY OF QUANTITIES - ITEM NO. 712-06 *

SIGN NO.	DESCRIPTION	SIZE (IN)	NUMBER REQUIRED
W20-1	ROAD WORK AHEAD	30X30	3
G20-2	END ROAD WORK	36X18	2
M4-9bR	PED DETOUR (RIGHT)	30X24	2
M4-9bL	PED DETOUR (LEFT)	30X24	2
W20-5b	BIKE LANE CLOSED AHEAD	30X30	1
W9-5a	BIKES MERGING	30X30	1
R9-20	ALLOWED USE OF FULL LANE	30X30	1
R9-12	BIKE LANE CLOSED	24X12	1
M6-2PL	DIRECTIONAL ARROW AUXILIARY PLAQUES LEFT	21X15	1

FILE NO.	52410_001
DATE:	10/06/25
DESIGNED BY:	MAT
DRAWN BY:	DW
CHECKED BY:	JMC

REVISION BLOCK

DATE:		

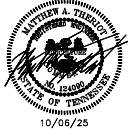

ALL CONSTRUCTION ACTIVITIES SHALL BE COMPLETED IN FULL COMPLIANCE WITH THE AMERICANS WITH DISABILITIES ACT (ADA) AND ARCHITECTURAL AND TRANSPORTATION BARRIERS COMPLIANCE BOARD, FEDERAL REGISTER 36 CFR PARTS 1190 AND 1191, ACCESSIBILITY GUIDELINES FOR BUILDINGS AND FACILITIES, ARCHITECTURAL BARRIERS ACT (ABA) ACCESSIBILITY GUIDELINES, PROPOSED RULE, PUBLISHED IN THE FEDERAL REGISTER ON JULY 23, 2004, AS HAS BEEN ADOPTED BY METRO.

NDOT

TRAFFIC CONTROL NOTES AND QUANTITIES

VANDERBILT HAWKINS FIELD RENOVATION - PHASE 1

N.T.S.

SHEET 3