

# MULTIMODAL ACCESS CLOSURE EXCEPTION APPLICATION FORM AND CHECKLIST

---

**Submittal Date:** 10/24/25      ☒ **New Submittal**   ☐ **Re-Submittal No:** \_\_\_\_\_

**Related Building Permit No:** N/A TDOT Road Project

**Project Name:** CNX267 - Davidson County

**Street Name Location:** Bradford Hills Drive

**Between:** Nolensville Rd      **And:** \_\_\_\_\_

---

**Applicant Name:** Civil Constructors, LLC

**Address:** 425 Downs Blvd Franklin, TN 37064

**Phone:** 615-642-3347      **Fax:** \_\_\_\_\_      **Contact:** Dalton Norvell

**Email:** d.norvell@civilconstructors.com

---

**Project Description:** Removal of existing asphalt and roadway to replace with upwards  
up 5' of fill in areas to correct grades to Nolensville Rd. ADA,

signal, and lighting improvements will be included in this closure.

**Start Date:** 11/22/25      **End Date:** 4/24/25      **Project Length:** 320 LF

**Describe Type of Closure:** This closure will consist of fully shutting down Bradford Hills Dr  
and detouring through a TDOT stamped detour plan. No traffic or  
pedestrians will be allowed in the zone while closure is on going

---

**Provide Reasons why Project cannot be completed without closures and what other options were considered (attach documents as needed):** \_\_\_\_\_

Full closure is needed due to the amount of grade changes occurring (See attached fill map).

This work will also include water main install, gas main install, and significant conduits for AT&T, street lighting, and signals. Partial detouring through site will not be achievable and unsafe.

---

## PROJECT INFORMATION CHECKLIST:

Included   Not Applicable

- |                                     |                                     |  |
|-------------------------------------|-------------------------------------|--|
| <input checked="" type="checkbox"/> | <input type="checkbox"/>            | Project Vicinity Map with Project Area shown, street names, property information, existing pavement and striping, gutter and building locations, north arrow, and scale. |
| <input checked="" type="checkbox"/> | <input type="checkbox"/>            | Planned work hours included.   |
| <input checked="" type="checkbox"/> | <input type="checkbox"/>            | Exact location and dimensions of the construction work zone shown.   |
| <input type="checkbox"/>            | <input checked="" type="checkbox"/> | If multiple phases are necessary, include perimeter impact of each phase, phase number, anticipated work hours and phase duration.                                       |
| <input checked="" type="checkbox"/> | <input type="checkbox"/>            | Details on construction activity and equipment being used as part of construction included for each phase.   |
| <input type="checkbox"/>            | <input checked="" type="checkbox"/> | Specify if any on-street parking, and/or metered parking, is to be restricted and if bus zone will need to be relocated.   |
| <input type="checkbox"/>            | <input type="checkbox"/>            | Specify if trash pickup will be impacted.  |
| <input type="checkbox"/>            | <input checked="" type="checkbox"/> | Provide information on all utility work and utility connections.   |
| <input checked="" type="checkbox"/> | <input type="checkbox"/>            | List all affected residents, businesses, agencies, and schools and any conversations/agreements taken place.   |
| <input checked="" type="checkbox"/> | <input type="checkbox"/>            | Show ongoing construction projects within vicinity of proposed project impact.   |
| <input type="checkbox"/>            | <input checked="" type="checkbox"/> | Provide plan to address conflicts with other nearby projects.  |
| <input type="checkbox"/>            | <input checked="" type="checkbox"/> | Provide traffic control plan for each phase of construction (see traffic control checklist for more information).  |
| <input type="checkbox"/>            | <input checked="" type="checkbox"/> | Provide information on work vehicle parking locations.   |
| <input checked="" type="checkbox"/> | <input type="checkbox"/>            | Show construction trucks ingress/egress to project location.   |
| <input type="checkbox"/>            | <input checked="" type="checkbox"/> | Provide information on any traffic signals, traffic signal loops, and traffic signal cabinets in close proximity to project.   |

## TRAFFIC CONTROL PLAN CHECKLIST:

Included   Not Applicable

- |                                     |                                     |   |
|-------------------------------------|-------------------------------------|---|
| <input checked="" type="checkbox"/> | <input type="checkbox"/>            | All temporary traffic control plans shall be designed in accordance with the most recent ADA regulations and requirements of the Manual of Uniform Traffic Control Devices. |
| <input checked="" type="checkbox"/> | <input type="checkbox"/>            | Clearly show the locations of all existing signs (including speed limit) as well as the proposed signs for each construction phase.   |
| <input checked="" type="checkbox"/> | <input type="checkbox"/>            | Show the location of all existing pedestrian paths and pedestrian detour route of each stage of construction.   |
| <input checked="" type="checkbox"/> | <input type="checkbox"/>            | Show dimensions of travel lane width, shoulder width, sidewalk of each phase, and overall roadway width along the length of affected area.                                  |
| <input checked="" type="checkbox"/> | <input type="checkbox"/>            | Show all existing striping and markings to remain, to be removed, and all proposed striping and markings for each construction stage.                                       |
| <input checked="" type="checkbox"/> | <input type="checkbox"/>            | Provide detour plan clearly showing detour route for any roadway or pedestrian/bike path closures.  |
| <input checked="" type="checkbox"/> | <input type="checkbox"/>            | Specify placement of all temporary traffic control devices.   |
| <input checked="" type="checkbox"/> | <input type="checkbox"/>            | Specify spacing of all temporary traffic control devices.   |
| <input checked="" type="checkbox"/> | <input type="checkbox"/>            | Show all existing traffic signals and streetlights in the work zone location.   |
| <input type="checkbox"/>            | <input checked="" type="checkbox"/> | Lighting provided for all pedestrian detour routes.   |
| <input type="checkbox"/>            | <input checked="" type="checkbox"/> | Provide minimum eleven (11) foot travel lanes at all times.   |
| <input checked="" type="checkbox"/> | <input type="checkbox"/>            | Show size, height, and location of all channelizing devices, warning lights, flag trees, barriers, etc.   |
| <input checked="" type="checkbox"/> | <input type="checkbox"/>            | Label all taper lengths and widths.   |
| <input type="checkbox"/>            | <input checked="" type="checkbox"/> | Provide locations of police officers for each phase as needed.  |
| <input checked="" type="checkbox"/> | <input type="checkbox"/>            | Temporary Traffic Control Plan has been stamped and signed by a TN licensed Civil Engineer.   |

11-APR-2023 15:12  
\\DOT03NAS002.tdot.state.tn.us\03Shared\SURVEY\DESIGN\PIN 105766.02 WilliamsonDavidsonSR-11NearBurkittRd\Construction\01-105766-02-Construction-T43.sht

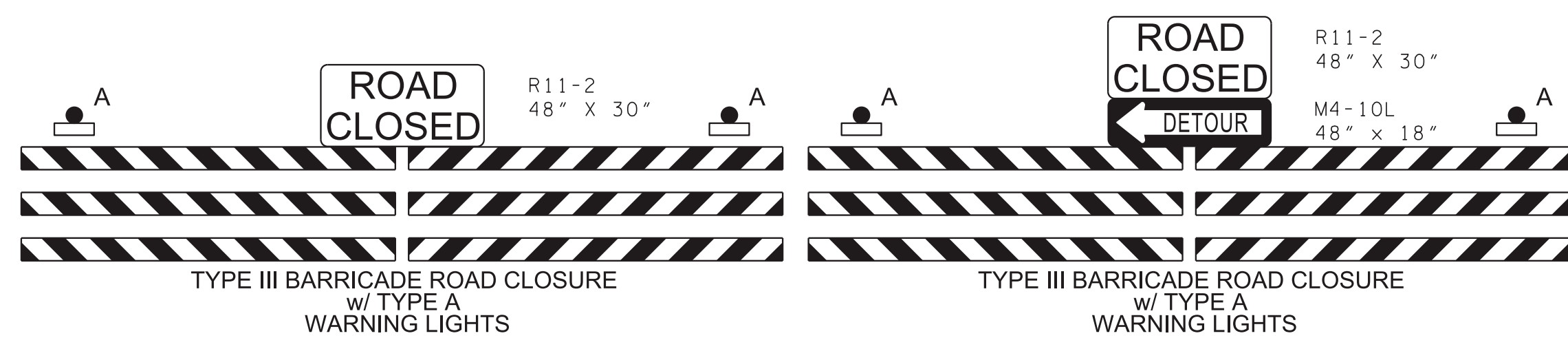

SUPPLEMENTAL SIGN  
60" X 36"

M4-9R (MOD.)  
48" X 60"

BRADFORD HILLS DR.  
DETOUR

BRADFORD HILLS DR.  
ROAD CLOSED  
500 FT

SUPPLEMENTAL SIGN  
60" X 36"

W20-3  
48" X 48"

SUPPLEMENTAL SIGN  
60" X 36"

M4-9L  
48" X 36"

BRADFORD HILLS DR.  
DETOUR

COBBLE ST

BRADFORD HILLS DR.

BRADFORD HILLS DR.  
DETOUR

SUPPLEMENTAL SIGN  
60" X 36"

M4-9R  
48" X 36"

11

NOLENVILLE ROAD

SUPPLEMENTAL SIGN  
60" X 36"

M4-9L  
48" X 36"

BRADFORD HILLS DR.  
DETOUR

HOLT HILLS RD.

BRADFORD HILLS DR.  
DETOUR

SUPPLEMENTAL SIGN  
60" X 36"

M4-9R  
48" X 36"

HOLT RD.

SUPPLEMENTAL SIGN  
60" X 36"

M4-9R  
48" X 36"

BRADFORD HILLS DR.  
DETOUR

SUPPLEMENTAL SIGN  
60" X 36"

M4-9R  
48" X 36"

BRADFORD HILLS DR.  
DETOUR

BRADFORD HILLS DR.  
DETOUR

SUPPLEMENTAL SIGN  
60" X 36"

M4-9L  
48" X 36"

BRADFORD HILLS DR.

SUPPLEMENTAL SIGN  
60" X 36"

ROAD CLOSED  
1 1/4 MILES

W20-3  
48" X 48"

M4-8A  
24" X 18"

END  
DETOUR

END  
DETOUR

M4-8A  
24" X 18"

NOTE: CONTRACTOR SHALL NOT HAVE HOLT ROAD, BROOKLAWN DRIVE, AND BRADFORD HILLS DRIVE CLOSED SIMULTANEOUSLY

TYPE	YEAR	PROJECT NO.	SHEET NO.
CONST.	2023	NH-11(81)	T43

SEALED BY

04/11/2023

STATE OF TENNESSEE  
DEPARTMENT OF TRANSPORTATION

BRADFORD HILLS DRIVE  
DETOUR MAP

SCALE: 1"=500'



TYPE	YEAR	PROJECT NO.	SHEET NO.
R.O.W.	2015	NH-11(81)	24E
CONST	2023	NH-11(81)	T13

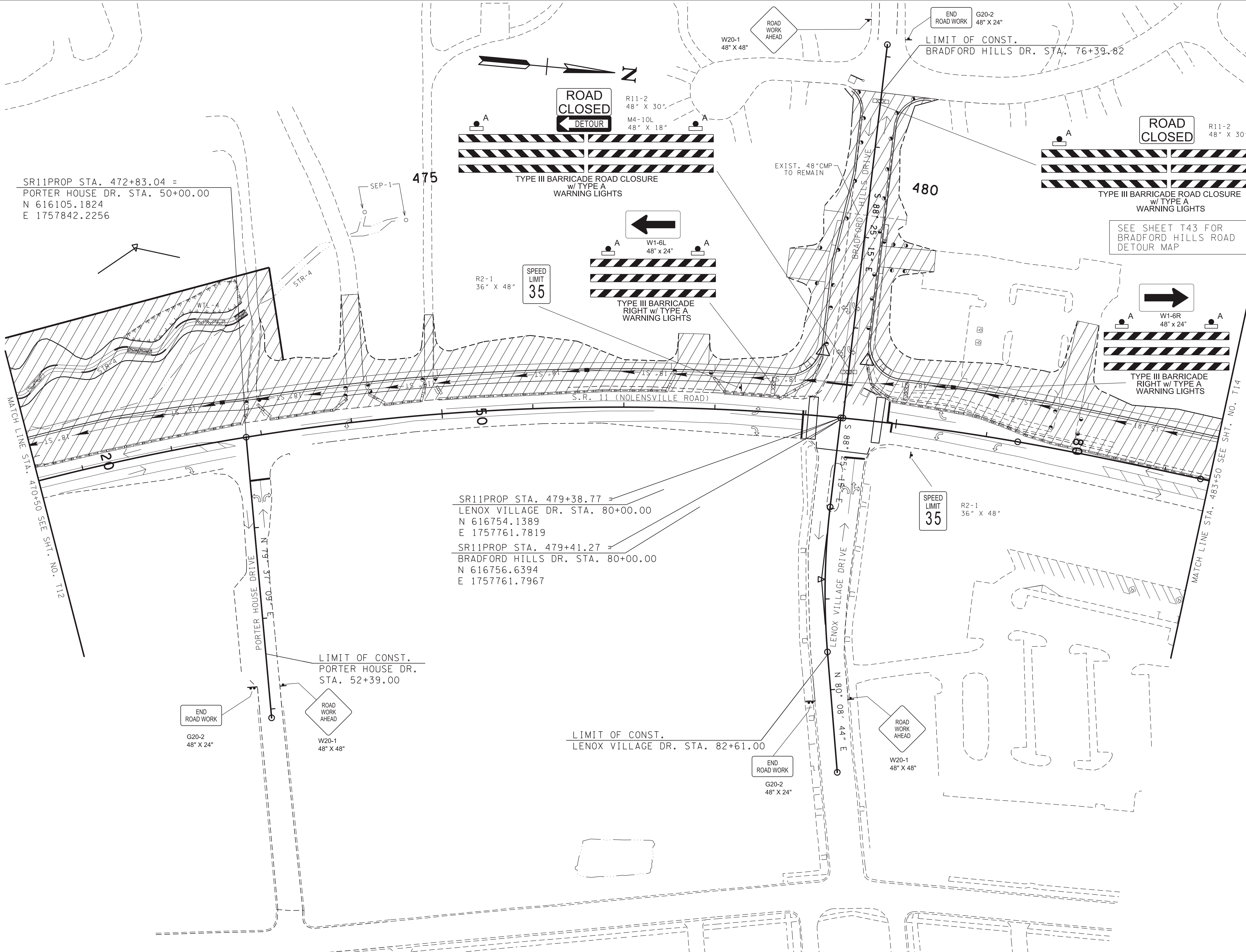

SEALED BY



04/11/2023

COORDINATES ARE NAD 83(1995), ARE DATUM ADJUSTED BY THE FACTOR OF 1.00006 AND TIED TO THE TGRN. ALL ELEVATIONS ARE REFERENCED TO THE NAVD 1988 WITH GEOID U07.

STATE OF TENNESSEE  
DEPARTMENT OF TRANSPORTATION

TRAFFIC CONTROL PLAN  
PHASE I  
STA. 470+50 TO STA. 483+50  
SCALE: 1"=50'

03-APR-2023 12:52  
\\TDOT03NAS002.tdot.state.tn.us\03Shared\SURVEY\DESIGN\PIN 105766.02 WilliamsonDavidsonSR-11NearBurkittRd\Construction\01-105766-02-Construction-T13.sht



